

Cleanroom Solutions

» Technics 11/25

Cleanrooms with a system.



➤ Contents

➤ Components	1000
➤ Electronics Wall Systems	10
➤ Electronics Ceiling Systems	34
➤ Electronics Door Systems	52
➤ Pharmacy Systems	74
➤ Extrusions in general	82
➤ Accessories + Tools	109

Cleanroom Components

Technics 11/25

Cleanrooms with a system.



➤ Contents

➤ Components

➤ Laminar Flow Units	5
➤ Pass through boxes	8
➤ technical information	

➤ Laminar Flow Units

Components

Laminar flow work bench

L 658 × W 698 × H 1764 mm



C 3020.90

aluminium

Anodized aluminium frame with clear acrylic glass, 4 mm, front hatch, tempered glass, 4 mm, with stop lock hinges. incl. desk top made from 12 mm board (stainless steel desk top at extra cost available) construction with adjustable feet Enviroco-Trion Fan-Filter-Unit (FFU), high efficiency particular Air (HEPA) filter: 99,99% efficient @ 0,3 micron; Air velocity: 0,45 m/s; air velocity can be controlled via 3-speed switch; 240 VDC / 115 VDC, 50 Hz, P = 255W

L 658 × W 698 × H 1764 mm |

Laminar flow work bench

L 958 × W 698 × H 1764 mm



C 3021.90

aluminium

Anodized aluminium frame with clear acrylic glass, 4 mm, front hatch, tempered glass, 4 mm, with stop lock hinges. incl. desk top made from 12 mm board (stainless steel desk top at extra cost available) construction with adjustable feet Enviroco-Trion Fan-Filter-Unit (FFU), high efficiency particular Air (HEPA) filter: 99,99% efficient @ 0,3 micron; Air velocity: 0,45 m/s; air velocity can be controlled via 3-speed switch; 240 VDC / 115 VDC, 50 Hz, P = 255W

L 958 × W 698 × H 1764 mm |

Laminar flow table top module

L 658 × W 698 × H 994 mm



C 3010.90

aluminium

Anodized aluminium frame with clear acrylic glass, 4 mm, front hatch, tempered glass, 4 mm, with stop lock hinges. Enviroco-Trion Fan-Filter-Unit (FFU), high efficiency particular Air (HEPA) filter: 99,99% efficient @ 0,3 micron; Air velocity: 0,45 m/s; air velocity can be controlled via 3-speed switch; 240 VDC / 115 VDC, 50 Hz, P = 255 W

L 658 × W 698 × H 994 mm |

➤ Laminar Flow Units

Components

Laminar flow table top module

L 958 × W 698 × H 994 mm



C 3011.90

aluminium

Anodized aluminium frame with clear acrylic glass, 4 mm, front hatch, tempered glass, 4 mm, with stop lock hinges. Envirco-Trion Fan-Filter-Unit (FFU), high efficiency particular Air (HEPA) filter: 99,99% efficient @ 0,3 micron; Air velocity: 0,45 m/s; air velocity can be controlled via 3-speed switch; 240 VDC / 115 VDC, 50 Hz, P = 255 W

L 958 × W 698 × H 994 mm |

Laminar flow table top module

L 1258 × W 698 × H 994 mm



C 3012.90

aluminium

Anodized aluminium frame with clear acrylic glass, 4 mm, front hatch, tempered glass, 4 mm, with stop lock hinges. Envirco-Trion Fan-Filter-Unit (FFU), high efficiency particular Air (HEPA) filter: 99,99% efficient @ 0,3 micron; Air velocity: 0,45 m/s; air velocity can be controlled via 3-speed switch; 240 VDC / 115 VDC, 50 Hz, P = 255 W

L 1258 × W 698 × H 994 mm |

Fan filter unit

L 1185 × W 585 mm

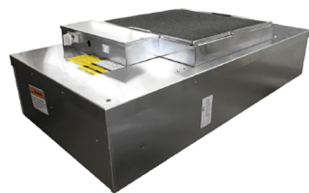

C 2217.90

steel

steel Envirco-Trion Fan-Filter-Unit (FFU), high efficiency particular Air (HEPA) filter: 99,99% efficient @ 0,3 micron; Air velocity: 0,45 m/s; air velocity can be controlled via 3-speed switch; 240 VDC / 115 VDC, 50 Hz, P = 255 W

L 1185 × W 585 mm | 30,25 kg

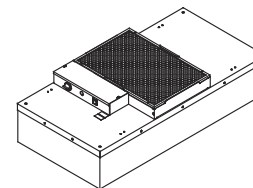

➤ Laminar Flow Units

Components

Cold appliance cable

10A / 250V
2000 mm long



C 2217/01.90

plastic

2 m, 10A/250V

L 2000 x B 0 x H 0 mm | 0,25 kg

Pass through boxes

Components

Pass trough box

L 560 × W 560 × H 560 mm



C 3200.80

aluminium, white

with two all-glass doors, 6 mm tempered glass, electrical interlock system, frame out of aluminium profiles, anodized E6EV1 and zinc diecast corner connection, Corpus and work surface out of shock-proof and abrasion-resistant moulded fiber board, color standard white

L 560 × W 560 × H 560 mm | 16.9 kg

Pass trough box

L 760 × W 760 × H 760 mm



C 3210.90

aluminium, white

with two all-glass doors, 6 mm tempered glass, electrical interlock system, frame out of aluminium profiles, anodized E6EV1 and zinc diecast corner connection, Corpus and work surface out of shock-proof and abrasion-resistant moulded fiber board, color standard white

L 760 × W 760 × H 760 mm |

! Scope of supply and services does not include the electronic connection and must be provided on site.

Pass trough box

Stainless steel

L 790 × W 790 × H 600 mm



C 3310.44

stainless steel

Pass through box for usage in cleanrooms with classification A-D by GMP, clear passage frame 660 x 660 x 500 mm, Corpus out of stainless steel sheet, 1.4301 brushed, interior planking out of stainless steel 1.4301, without further processing, 2 single doors with single glazing, 4 mm tempered glass, installed one side being flush

L 790 × W 790 × H 600 mm | 92.5 kg

Electronics Wall Systems

Technics 11/25

Cleanrooms with a system.



➤ Contents

➤ Electronics Wall Systems

➤ 40 x 40 mm	11
➤ 60 x 40 mm	16
➤ 70 x 40 mm	17
➤ 80 x 40 mm	18
➤ 100 x 40 mm	19
➤ U-Channel extrusion	21
➤ Spacing extrusions	22
➤ Retainer extrusions	24
➤ Grille	31
➤ technical information	

40 x 40 mm

Electronics Wall Systems

Square extrusion

4 system grooves
L 5000 x W 40 x H 40 mm

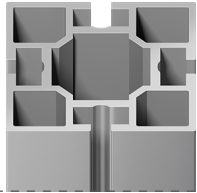

M 1000.01

aluminium

for connection on 4 sides, tension lock Z 961/8 can be mounted in 2 positions, with 4 system grooves, groove depth 7 mm

L 5000 x W 40 x H 40 mm | 5.782 kg

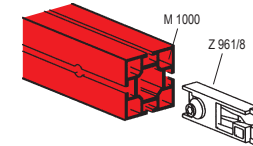
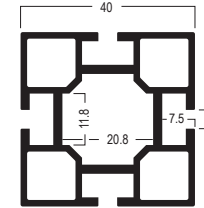

Square extrusion

4 system grooves
L 6000 x W 40 x H 40 mm

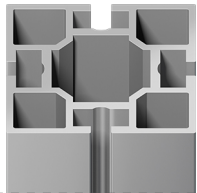

M 1001.01

aluminium

for connection on 4 sides, tension lock Z 961/8 can be mounted in 2 positions, with 4 system grooves, groove depth 7 mm

L 6000 x W 40 x H 40 mm | 6.97 kg

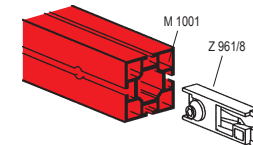
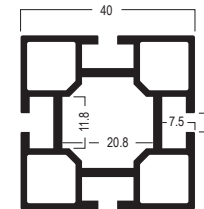

End cap

for extrusions 40 x 40 mm
L 40 x W 40 x H 12 mm

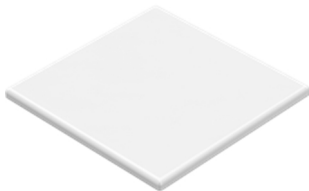

M 1014.35

plastic, light grey

for all square extrusions 40 mm

L 40 x W 40 x H 12 mm | 0.004 kg

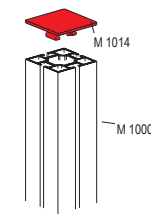
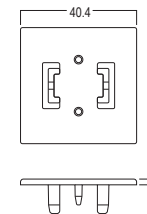

40 x 40 mm

Electronics Wall Systems

Square extrusion

2 system grooves
L 5000 x W 40 x H 40 mm

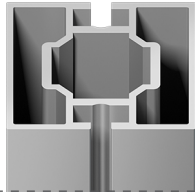

M 1002.01

aluminium

for connection on 2 sides, tension lock Z 961/8 can be mounted in 2 positions, with 2 system grooves, groove depth 7 mm

L 5000 x W 40 x H 40 mm | 5.554 kg

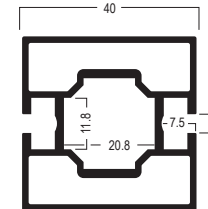

Square extrusion

2 system grooves
L 6000 x W 40 x H 40 mm

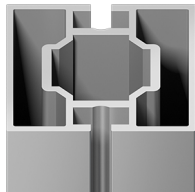

M 1003.01

aluminium

for connection on 2 sides, tension lock Z 961/8 can be mounted in 2 positions, with 2 system grooves, groove depth 7 mm

L 6000 x W 40 x H 40 mm | 6.922 kg

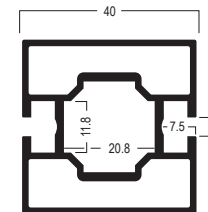

Square extrusion

3 system grooves
L 6000 x W 40 x H 40 mm

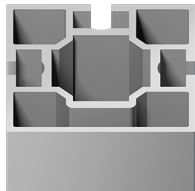

M 1005.01

aluminium

for connection on 3 sides, tension lock Z 961/8 can be mounted in 2 positions, with 3 system grooves, groove depth 7 mm

L 6000 x W 40 x H 40 mm | 6.664 kg

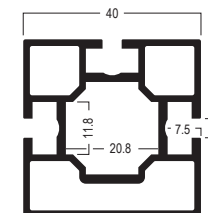

Square extrusion

2 system grooves
90° corner

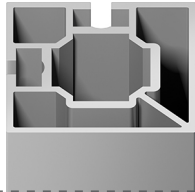

M 1007.01

aluminium

90° corner, for connection on 2 sides, tension lock Z 961/8 can be mounted in 2 positions, with 2 system grooves, groove depth 7 mm

L 6000 x W 40 x H 40 mm | 7.174 kg

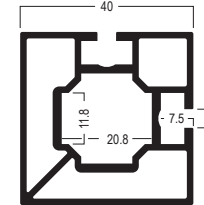

Angle extrusion

135° corner
L 6000 x W 40 x H 50 mm

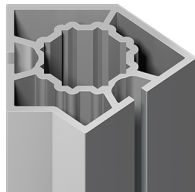

M 1009.01

aluminium

135°, for connection on 2 sides, tension lock Z 961/8 can be mounted in 2 positions

L 6000 x W 40 x H 50 mm | 7.818 kg

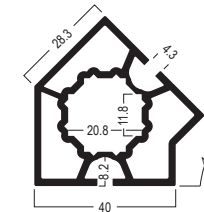

Adjustable foot

M10
for M 1001 / M 1005 / M 1007



C 430.00

zinc die cast/steel

for upright extrusions M 1001 / M 1005 / M 1007

L 47 x W 47 x H 80 mm | 0.131 kg

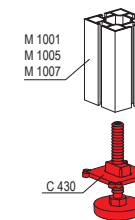
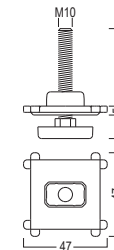

Adjustable foot

135° corner
for upright M 1009



C 441.37

steel, zinc plated

for exterior corner extrusion M 1009, 135°, incl. 2 x set screw
M 1075/20 (M4)

L 53 x W 39 x H 80 mm | 0.158 kg

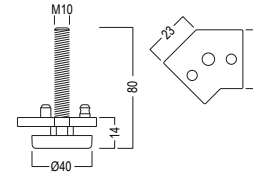

End cap

for drill hole 8 mm dia.
L 13 x W 13 x H 12 mm



M 1491.35

plastic, light grey

to cover drill holes with 8 mm dia., similar to RAL 7035

L 13 x W 13 x H 12 mm |

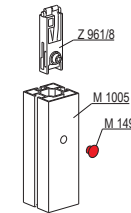

Beam extrusion

transition glass/glass
L 6000 x W 40 x H 40 mm



C 120.01 | .80

aluminium

transition glass/glass, 2 system grooves

L 6000 x W 40 x H 40 mm | 7.09 kg

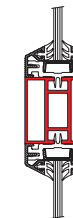
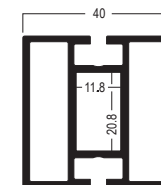

↗ 40 x 40 mm

Electronics Wall Systems

Upright extrusion

higher bending stiffness
L 4500 x W 40 x H 40 mm



C 124.01

aluminium

2 system grooves, with higher bending stiffness
L 4500 x W 40 x H 40 mm | 5.82 kg



Custom lengths are possible

Upright extrusion

higher bending stiffness
L 6000 x W 40 x H 40 mm



C 125.01

aluminium

2 system grooves, with higher bending, L 6000 x W 40 x H 40 mm
L 6000 x W 40 x H 40 mm | 7.572 kg



Adjustable foot

M10
for extrusion C 124 / C 125



C 431.00

steel/zinc die cast

for upright extrusions C 124 and C 125
L 47 x W 39 x H 80 mm | 0.128 kg

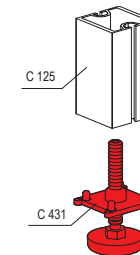
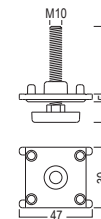

➤ 60 x 40 mm

Electronics Wall Systems

Beam extrusion

bottom
L 6000 x W 40 x H 60 mm



C 105.01 | .80

aluminium

for wall constructions between glass and panel or as lower wall ending, 1 system groove

L 6000 x W 40 x H 60 mm | 9.26 kg

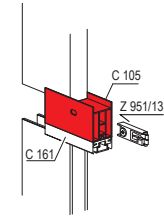
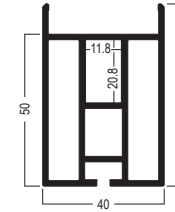

Beam extrusion

top / bottom
L 6000 x W 40 x H 60 mm



C 110.01 | .80

aluminium

for wall constructions between glass and panel or as upper and lower wall ending, 1 system groove

L 6000 x W 40 x H 60 mm | 7.568 kg

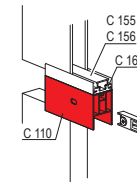
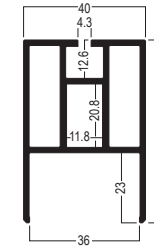

End cap

for punching hole

C 420.35

plastic

to cover the punching hole

L 17 x B 7 x H 7 mm |

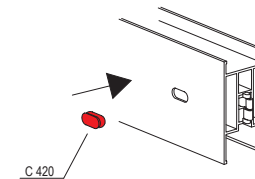
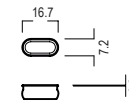

➤ 70 x 40 mm

Electronics Wall Systems

Beam extrusion

for door frame
L 6000 x W 40 x H 70 mm



C 115.01 | .80

aluminium

adjustment extrusion for door frame, 1 system groove

L 6000 x W 40 x H 70 mm | 9.029 kg

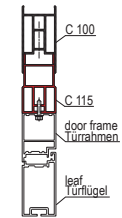
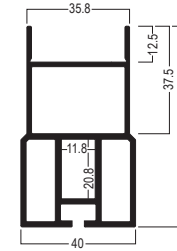

➤ 80 x 40 mm

Electronics Wall Systems

Beam extrusion

top
L 6000 x W 40 x H 80 mm



C 100.01 | .80

aluminium

for wall constructions between panel and panel or as upper wall ending, 1 system groove

L 6000 x W 40 x H 80 mm | 9.98 kg

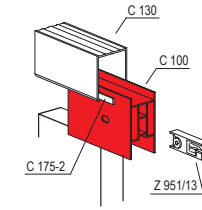
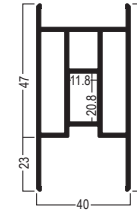

➤ 100 x 40 mm

Electronics Wall Systems

Rectangular extrusion

L 6000 x W 40 x H 100 mm
6000 mm long



M 1029.01

aluminium

L 6000 x W 40 x H 100 mm | 11.88 kg

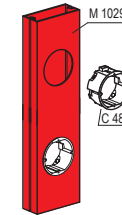
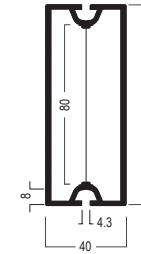

Adjustable foot

beam support both sides
for extrusion M 1029

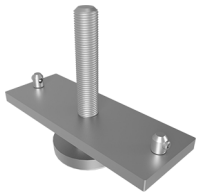

C 446.37

steel, zinc plated

for upright extrusion M 1029 with support for beams on both sides

L 106 x W 39 x H 80 mm | 0.27 kg

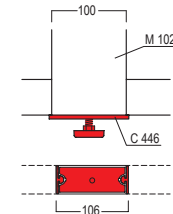
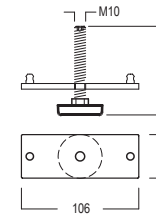

Adjustable foot

beam support one side
for extrusion M 1029

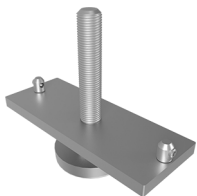

C 447.37

steel, zinc plated

for upright extrusion M 1029 with support for beams on one side

L 103 x W 39 x H 80 mm | 0.264 kg

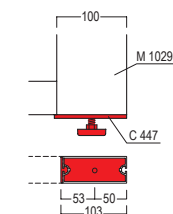
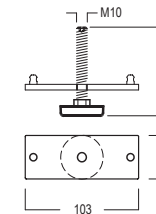

↗ 100 x 40 mm

Electronics Wall Systems

Adaptor

with 2 × Z 961/13
for M 1029



M 1128.01

aluminium, matt anodized, silver

for mounting in rectangular extrusion M 1029, incl. 2 × tension lock
Z 961/13 and fixing accessories M5

L 80 × W 16 × H 80 mm | 0.241 kg

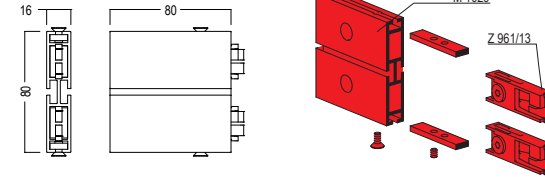

End plate

3 mm thick
for M 1029

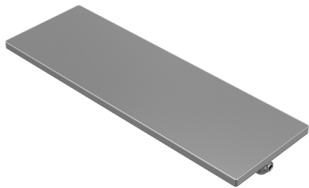

M 1083.21

steel

for rectangular extrusion M 1029, 3 mm thick

L 100 × W 40 × H 3 mm | 0.099 kg

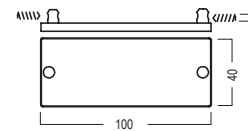

➤ U-Channel extrusion

Electronics Wall Systems

U-channel extrusion

for floor/ceiling
L 6000 × W 45 × H 60 mm

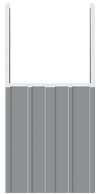

C 130.01

aluminium

for floor and ceiling

L 6000 × W 45 × H 60 mm | 5.33 kg

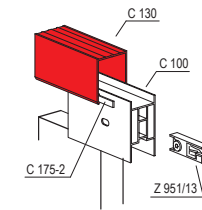
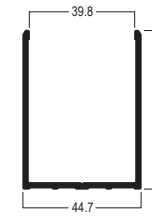

Spacing extrusions

Electronics Wall Systems

Spacing extrusion

for triple glazing
for panel / glass 3-6 mm



C 151.01

aluminium

for 60 mm systems, for triple glazing with 3 and 6 mm glass/panel thickness

L 6000 × W 24.2 × H 20 mm | 2.284 kg

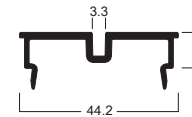

Spacing extrusion

for triple glazing
for panel / glass 3-6 mm



C 153.01

aluminium

for triple glazing with 3 and 6 mm glass/panel thickness

L 6000 × W 24.2 × H 20 mm | 1.69 kg

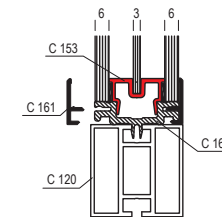
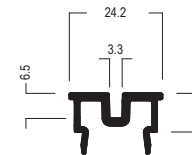

Spacing extrusion

system 60 mm
37.6 × 7 mm



C 157.01

aluminium

for 60 mm systems, 37.6 × 7 mm, 6000 mm long

37.6 × 7 mm | 1.333 kg

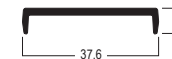

Spacing extrusions

Electronics Wall Systems

Spacing extrusion

L 6000 × W 17.5 × H 7 mm



C 158.01

aluminium

L 6000 × W 17.5 × H 7 mm | 0.79 kg

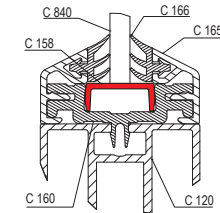
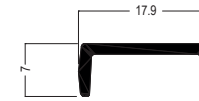

Adaptor extrusion

system 60 mm

L 6000 × W 55 × H 10 mm



C 159.35

plastic

for 60 mm systems

L 6000 × W 55 × H 10 mm | 2.035 kg



Adaptor extrusion

L 6000 × W 36.6 × H 10 mm



C 160.35

plastic

L 6000 × W 36.6 × H 10 mm | 1.61 kg

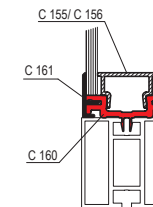

Retainer extrusions

Electronics Wall Systems

Suspension extrusion

for panel / glass 6 mm
L 6000 × W 1.9 × H 20 mm



C 161.01

aluminium

for glass or panels up to 6 mm thickness
L 6000 × W 1.9 × H 20 mm | 0.75 kg

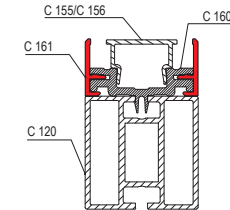
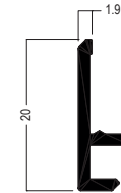

Suspension extrusion

for panel 36 mm
L 6000 × W 2.1 × H 20 mm



C 162.01

aluminium

for panels with 36 mm thickness
L 6000 × W 2.1 × H 20 mm | 0.75 kg

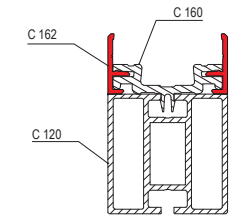
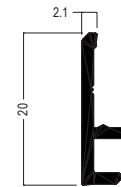

Glass panel retainer

insulating glass 35.6 mm
L 6000 × W 1.9 × H 22 mm



C 163.01

aluminium

for 35.6 mm thick insulating glass panels
L 6000 × W 1.9 × H 22 mm | 0.806 kg

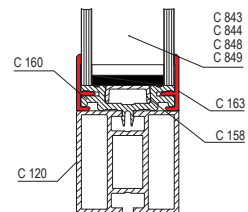
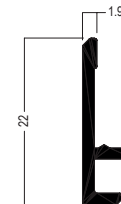

Retainer extrusions

Electronics Wall Systems

Glass panel retainer
middle
for panel / glass 5-8 mm



C 165.01
aluminium

for centered installation of panels/glass 5-8 mm thick
L 6000 × W 11.8 × H 19 mm | 1.08 kg

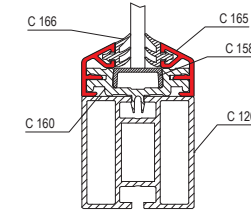
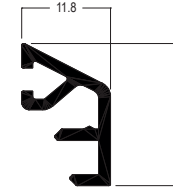

Gasket
50 m long
for glass 6 mm



C 166.35
PVC, soft

for glass 6 mm, for glass panel retainer C 165, W 5.5 × H 11.5 mm,
50 m long
W 5.5 × H 11.5 mm | 2.425 kg

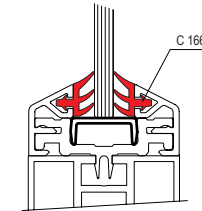

Gasket
25 m long
for panel 13 mm



C 167.33
rubber

for panels with 13 mm thickness, in combination with glass panel
retainer C 165, 25 m long
B 5.3 × H 5.6 mm | 0.37 kg

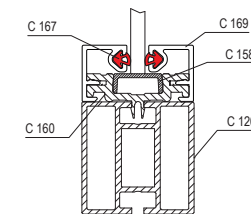

Retainer extrusions

Electronics Wall Systems

Suspension extrusion

middle
for panel 16 mm



C 169.01

aluminium

for panels with 16 mm thickness, centered installation

L 6000 × W 10.8 × H 20 mm | 1.236 kg

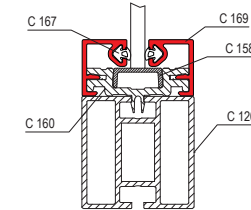
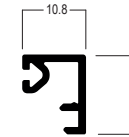

Suspension extrusion

vertical
for panel / glass 5-6 mm



C 170.01

aluminium

vertical installation, for one-sided flush installation of panels/glass 5 and 6 mm thick

L 6000 × W 32.5 × H 20 mm | 1.38 kg

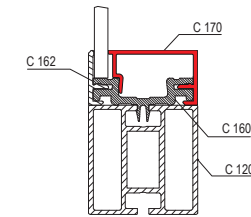
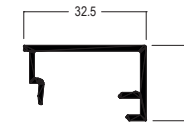

Suspension extrusion

horizontal
for panel / glass 5-6 mm



C 171.01

aluminium

horizontal installation, for one-sided flush installation of panels/glass 5 and 6 mm thick

L 6000 × W 32.5 × H 12 mm | 1.64 kg

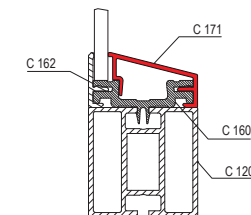
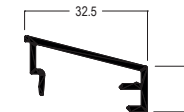

Retainer extrusions

Electronics Wall Systems

Gasket

self adhesive
10 m long

C 175-2.90

plastic

self adhesive 10 m long
L 20000 x B 8 x H 2 mm | 0.04 kg



Gasket

self adhesive
10 m long

C 175-3.90

plastic, black

self adhesive, 10 m long
L 10000 x B 8 x H 3 mm | 0.048 kg



Cover plate

for extrusion C 130
L 45 x W 2 x H 60 mm

C 408.01

aluminium

for floor u-channel extrusion C 130, L 45 x W 2 x H 60 mm
L 45 x W 2 x H 60 mm | 0.053 kg

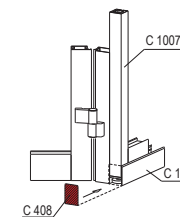
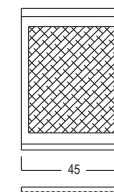

Retainer extrusions

Electronics Wall Systems

Extrusion

3 system grooves
support both sides

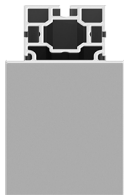

C 601.01

aluminium

usable as ceiling beam, upright extrusion and beam extrusion, 3 system grooves, support on both sides

L 6000 × W 58 × H 40 mm | 8.694 kg

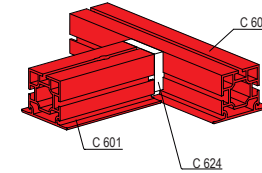
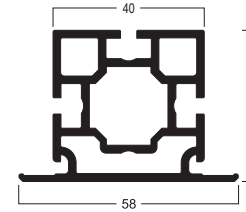

Extrusion

3 system grooves
support one side



C 701.01

aluminium

usable as ceiling beam, upright extrusion and beam extrusion, 3 system grooves, support on one side

L 6000 × W 49 × H 40 mm | 8.88 kg

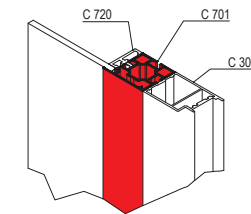
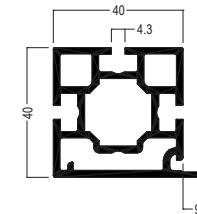

Extrusion

4 system grooves
support both sides

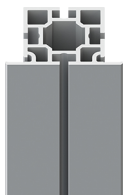

C 606.01

aluminium

usable as ceiling beam, upright extrusion, and beam extrusion, 4 system grooves, support on both sides

L 6000 × W 58 × H 40 mm | 9.489 kg

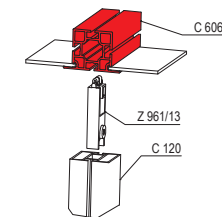
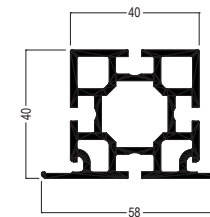

Retainer extrusions

Electronics Wall Systems

Ceiling extrusion

for mounting LED lights
support both sides

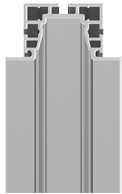

C 608.01

aluminium

to be used as ceiling light channel in combination with cover extrusion C 637/2000, with opening for mounting LED lights, support on both sides

L 6000 × W 58 × H 40 mm | 7.32 kg

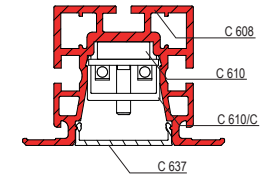
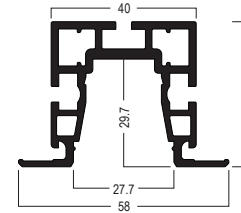

in combination with
cover extrusion C 636

Extrusion

4 sytem grooves
support one side

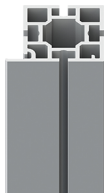

C 604.01

aluminium

usable as ceiling beam, upright extrusion and beam extrusion, 4 sytem grooves, support on one side

L 6000 × W 49 × H 40 mm | 9.15 kg

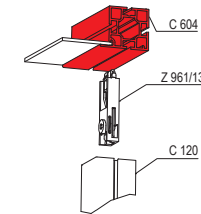
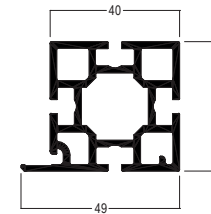

Suspension extrusion

for panel / glass 6 mm
L 6000 × W 9 × H 31 mm



C 722.01

aluminium

for one sided flush installation of panels/glass 6 mm thick

L 6000 × W 9 × H 31 mm | 1.83 kg

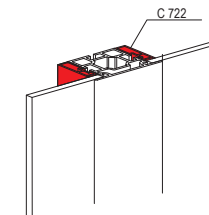

Retainer extrusions

Electronics Wall Systems

Clip

for E 470/N / E 471/N
L 10 x W 9 x H 7 mm



E 470/C.30

plastic

to put into extrusion E 470/N / E 471/N, recommendation: 4 pieces / running meter for extrusion C 722, 2 pieces / running meter for extrusion W 910

L 10 x W 9 x H 7 mm |

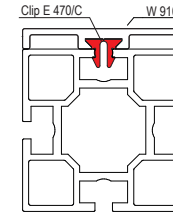
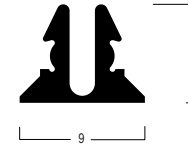

Extrusion connector

for extrusions
5950 mm long

C 725.35

plastic, semi-hard

for connection of 2 aluminium extrusions in parallel alignment
5950 mm long

L 5950 x B 14 x H 7 mm | 0.26 kg

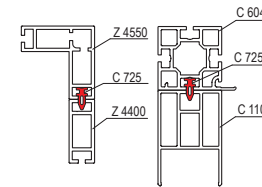
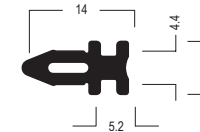

Expanded metal
for light wall

C 818.80
steel

for air grille in "light walls"
L 946 x B 630 x H 2 mm | 1.738 kg

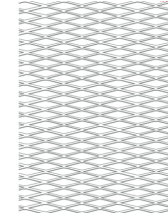

Expanded metal
with filtermat G4
W 928 x H 612 mm

C 819.80
steel, powder coated

mesh size, 20 x 15 mm, 1.7 mm thick incl. filtermat G4
W 928 x H 612 mm | 1.58 kg

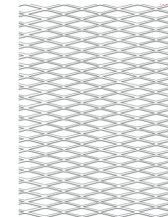

Air grille
basic, 19%
W 949 x H 631 mm

C 821.80
aluminium/steel

for mounting into wall panel and doors with cutout 918 x 600 mm
approx. 19% free surface area
W 949 x H 631 mm | 6.704 kg

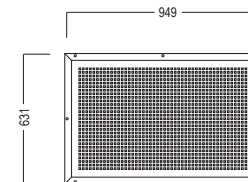

Air grille

basic, 44%
W 949 × H 631 mm

C 823.80

aluminium/steel

for mounting into wall panel and doors with cutout 918 x 600 mm
approx. 44% free surface area

W 949 × H 631 mm | 3.8 kg

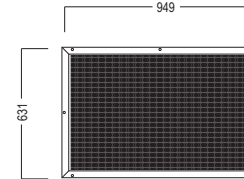

Air grille

adjustable, 0-19%
W 949 × H 631 mm

C 825.80

aluminium/steel

for mounting into wall panel and doors with cutout 0-19%, 918 x 600 mm penetrability adjustable

W 949 × H 631 mm | 8.51 kg

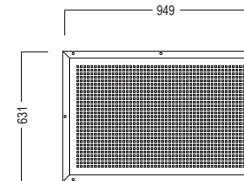

Frame extrusion

for return air grill
for glassing



C 875.01

aluminium

for return air grill and glassing

L 6000 × W 15.1 × H 32.7 mm | 2.218 kg



Electronics Ceiling Systems

» Technics 11/25

Cleanrooms with a system.



➤ Contents

➤ Electronics Ceiling Systems

➤ Extrusions	35
➤ Accessories	38
➤ technical information	

Extrusions

Electronics Ceiling Systems

Extrusion

3 system grooves
support both sides

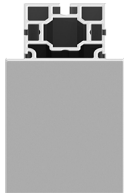

C 601.01

aluminium

usable as ceiling beam, upright extrusion and beam extrusion, 3 system grooves, support on both sides

L 6000 × W 58 × H 40 mm | 8.694 kg

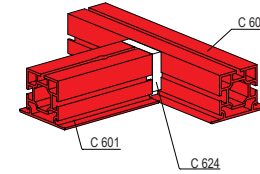
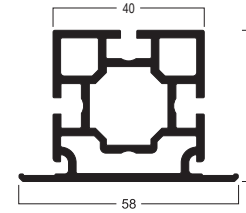

Extrusion

3 system grooves
support one side



C 701.01

aluminium

usable as ceiling beam, upright extrusion and beam extrusion, 3 system grooves, support on one side

L 6000 × W 49 × H 40 mm | 8.88 kg

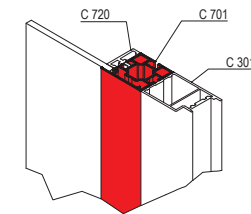
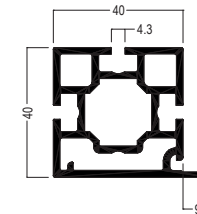

Extrusion

4 system grooves
support both sides

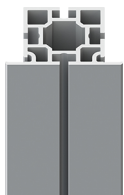

C 606.01

aluminium

usable as ceiling beam, upright extrusion, and beam extrusion, 4 system grooves, support on both sides

L 6000 × W 58 × H 40 mm | 9.489 kg

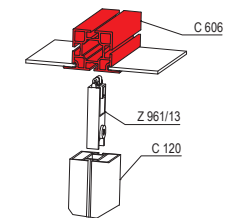
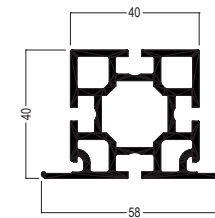

Extrusion

4 sytem grooves
support one side



C 604.01

aluminium

usable as ceiling beam, upright extrusion and beam extrusion, 4 sytem grooves, support on one side

L 6000 × W 49 × H 40 mm | 9.15 kg

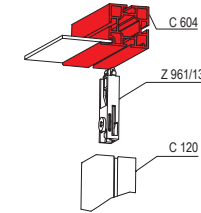
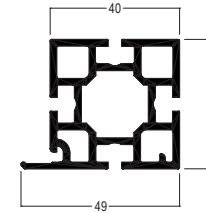

Supporting edge

small
for system groove 4.3 mm



C 612.01

aluminium

small, for system groove 4.3 mm

L 6000 × W 17 × H 24.5 mm | 1.11 kg

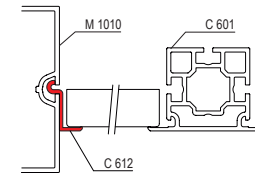
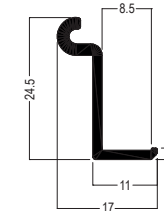

Supporting edge

wide
for system groove 4.3 mm



C 613.01

aluminium

wide, for system groove 4.3 mm, 36 × 24,5 mm

L 6000 × W 36 × H 24.5 mm | 1.818 kg

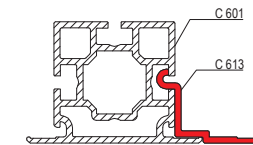
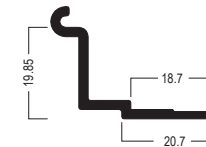

Ceiling extrusion

L 2400 × W 55 × H 43 mm

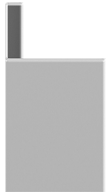

C 670.01

aluminium, anodized

55 × 43 mm, 2400 mm lang

L 2400 × W 55 × H 43 mm | 0.555 kg

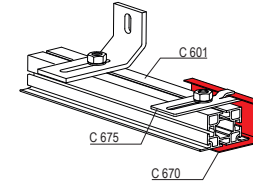
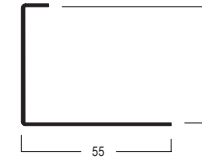

L-Extrusion

L 6000 × W 60 × H 40 mm



C 680.01

aluminium

L 6000 × W 60 × H 40 mm | 2.958 kg

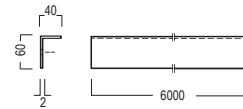

Cover extrusion

for extrusion C 608

L 2000 × W 28 × H 7 mm



C 637/2000.50

polycarbonat, satin finish

for internal LED-illumination of open ceiling extrusion C 608

L 2000 × W 28 × H 7 mm | 0.183 kg

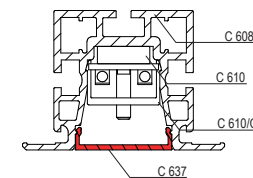
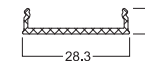

Accessories

Electronics Ceiling Systems

Clip

for wall / ceiling
for panels 6 mm

C 730.33

plastic

for fixing wall and ceiling 6 mm thick
L 55 x B 28 x H 12 mm | 0.003 kg

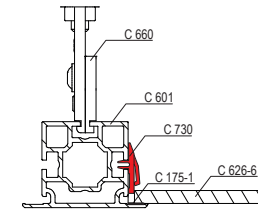
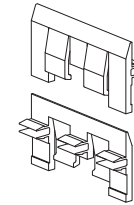

Gasket

self-adhesive
2 x 6 mm

C 174-2.90

plastic

self-adhesive 40 m long
2 x 6 mm | 0.037 kg



Gasket

self-adhesive
3 x 6 mm

C 174-3.90

plastic

self-adhesive 25 m long
3 x 6 mm | 0.025 kg

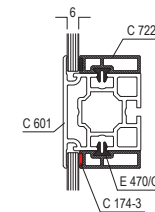

Gasket

self-adhesive
1 x 8 mm



C 175-1.30

plastic

1 mm PE-foam, 60 m x 8 mm, self-adhesive
1 x 8 mm | 0.05 kg

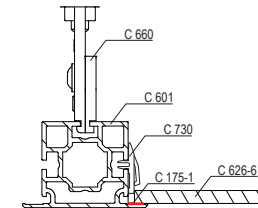

Spring

for C 880 / C 881

C 620.90

spring steel

stainless for fixing ceiling elements C 880 and C 881
L 0 x B 30 x H 0 mm | 0.012 kg

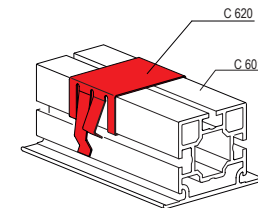
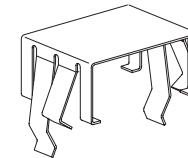

Tension lock

with adaptor C 625
for C 601 / C 604 / C 606 / C 701 / C 710

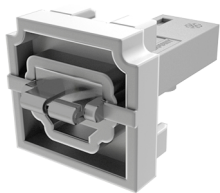

C 624.00

steel/plastic

for ceiling extrusion C 601, C 604, C 606, C 701, C 710, with
adaptor C 625
L 0 x B 0 x H 0 mm | 0.062 kg

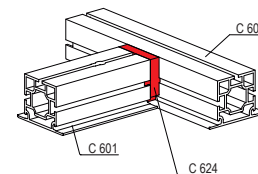
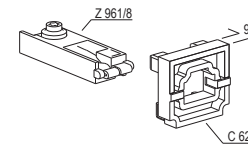

Mounting rail

28 x 30 mm
2000 mm long



C 640-2.37

steel, zinc plated

2000 mm long
28 x 30 mm | 2.168 kg

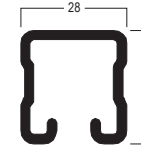

Mounting rail

28 x 30 mm
3000 mm long



C 640-3.37

steel, zinc plated

3000 mm long
28 x 30 mm | 3.72 kg

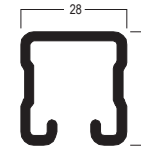

Mounting rail

38 x 40 mm
3000 mm long



C 641-3.37

steel, zinc plated

3000 mm long
38 x 40 mm | 5.94 kg

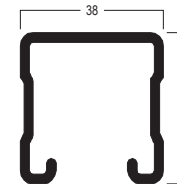

Accessories

Electronics Ceiling Systems

Mounting rail

38 × 40 mm
6000 mm long



C 641-6.37

steel, zinc plated

6000 mm long
38 × 40 mm | 11.8 kg

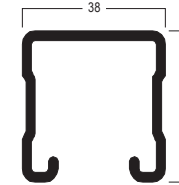

Mounting rail

40 × 60 mm
4000 mm long



C 642-4.37

steel, zinc plated

4000 mm long
40 × 60 mm | 15.4 kg

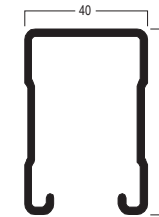

Location clamp

for C 640-2 / -3

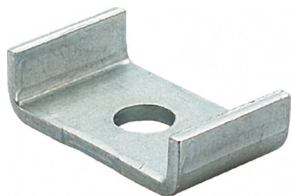

C 640-HK.37

steel, zinc plated

for mounting rail 27/18 and 28/30
L 29 x B 25 x H 0 mm | 0.03 kg

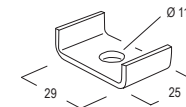

Location clamp

for C 642-4



C 642-HK.90

steel, zinc plated

for mounting rail 40/60

L 42 x B 50 x H 0 mm | 0.083 kg

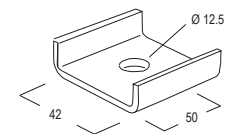

Anchor bolt

M8



C 645.37

steel, zinc plated

M8, max. usable length 10 mm

L 76 x B 24 x H 0 mm | 0.035 kg

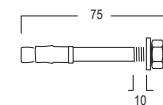

Hexagonal connector

VM M8



C 646.37

steel, zinc plated

VM M8 | 0.014 kg

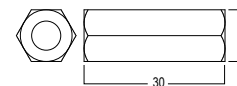

Sliding nut

M8
50 mm long



C 640-SM.37

steel, zinc plated

M8

L 50 x B 20 x H 0 mm | 0.026 kg

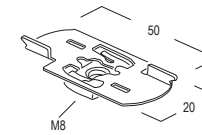

Sliding nut

M8
39 mm long



C 641-SM.37

steel, zinc plated

M8

L 39 x B 16 x H 6 mm | 0.018 kg

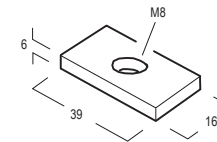

Anchor bolt

M8

C 640-AB.37

steel, zinc plated

M8, max. usable length 30 mm

L 97 x B 8 x H 0 mm | 0.05 kg

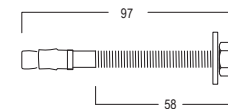

Anchor bolt

M8

C 641-AB.37

steel, zinc plated

M8, max. usable length 50 mm

L 115 x B 8 x H 13 mm | 0.044 kg

Clamp hanger

for thread rod M8



C 648-M8.37

steel

for thread rod M8

L 75 x B 50 x H 20 mm | 0.146 kg

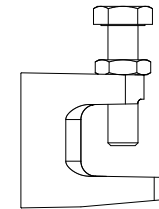

Fixing angle

L 94 x W 40 x H 60 mm



C 651.37

sheet metal

L 94 x W 40 x H 60 mm | 0.18 kg

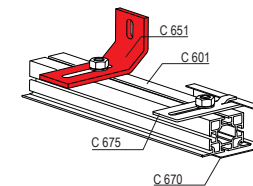
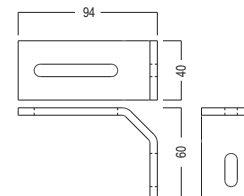

Fixing angle

L 60 × W 40 × H 60 mm

C 652.37

steel

L 60 × W 40 × H 60 mm | 0.152 kg

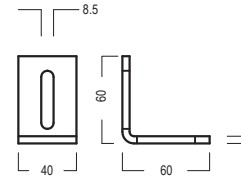

Hammerhead screw

M5

C 653.37

steel

M5

L 15 × B 5 × H 16 mm | 0.006 kg

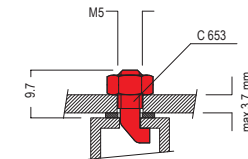

Thread rod

M8

1000 mm long

C 661.37

steel, zinc plated

1000 mm long

L 1000 × B 8 × H 8 mm | 0.279 kg

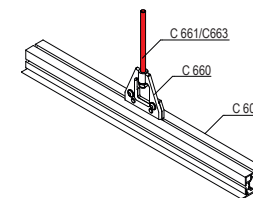
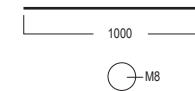

Thread rod

M8
2000 mm long



C 662.37

steel, zinc plated

2000 mm long
L 2000 x B 8 x H 8 mm | 0.619 kg

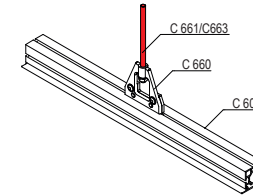
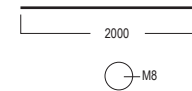

Thread rod

M8
3000 mm long



C 663.37

steel, zinc plated

3000 mm long
L 3000 x B 8 x H 8 mm | 0.921 kg

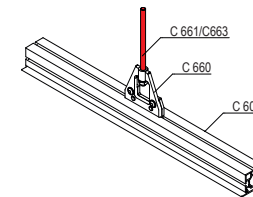
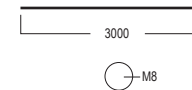

Fixing-set

for system groove 4.3 mm
for C 661 / C 662 / C 663



C 660.37

zinc die cast/steel

consisting of Part A und B, for mounting to system groove 4.3 mm incl. 2 screws M 1557/20 and 2 set screws M 1435/70, for suspension of cleanroom ceiling weith thread rod M8 for loads up to 300 Kg

L 80 x B 10 x H 81 mm | 0.232 kg

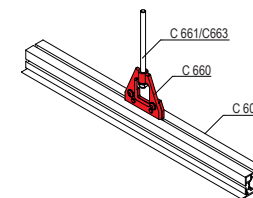
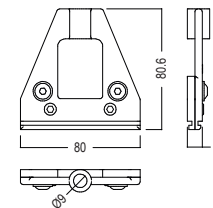

I for loads up to 300 Kg

Screw

C 666.37

steel

Steel

L 45 x B 5 x H 0 mm | 0.005 kg



Screw

C 693-4825.37

steel, zinc plated

drilling screw with truss head ZEBRA Pias

L 25 x B 5 x H 0 mm | 0.002 kg



Peg

C 668.35

plastic

L 35 x B 6 x H 0 mm |



Ceiling clamp

for C 670
83 x 35 mm

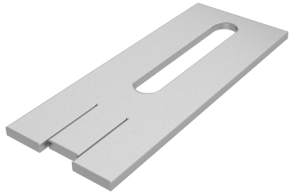

C 675.37

steel, zinc plated

together with M 1472 Hammerhead screw

83 x 35 mm | 0.066 kg

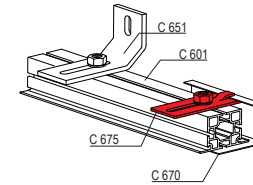
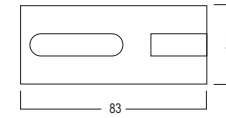

Washer

M8

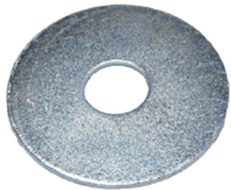

C 677.37

steel, zinc plated

M8

L 2 x B 20 x H 20 mm | 0.003 kg

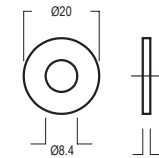

Washer

M4



C 679.37

steel, zinc plated

M4

L 1 x B 10 x H 10 mm |

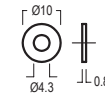

Button head socket screw with flange

M5



C 827.37

steel, zinc plated

M5 x 10 mm

L 13 x B 11 x H 0 mm |



Fixing set

for LED elements
for extrusion C 608

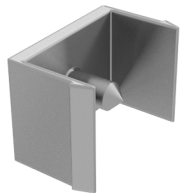

C 610/C.90

aluminium

with clamping screw M4 for fixing LED elements, clipping into ceiling extrusion C 608

L 15 x B 21 x H 13 mm | 0.004 kg

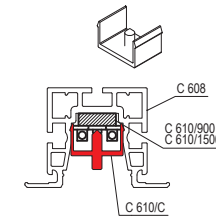
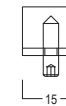
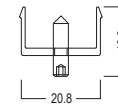

Sprinklersleeve

for ceiling extrusions



C 635.01

plastic

Sprinkler duct for installation on ceiling extrusions, for sprinkler pipes up to 1" or 25.4 mm, outside diameter 33.5 mm, Aluminum - pass-through sleeve with flange for flush mounting on ceiling extrusion

L 40 x B 40 x H 52 mm | 0.064 kg

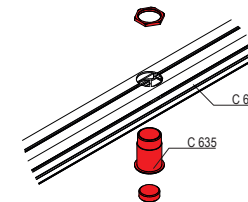

Accessories

Electronics Ceiling Systems

Fixing set

for thread rod M10

C 650.37

zinc die cast/steel

consisting of Part A und B, for mounting to system groove 4,3 mm
incl. 2 screws M 1557/20 and 2 set screws M 1435/70, for
suspension of cleanroom ceiling weith thread rod M10 for loads up
to 300 Kg

L 80 x B 5 x H 81 mm | 0.23 kg

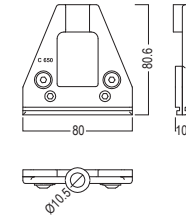

1 for loads up to 300 Kg

Electronics Door Systems

Technics 11/25

Cleanrooms with a system.



➤ Contents

➤ Electronics Door Systems

➤ Door and Window extrusions	53
➤ Doors and frames	58
➤ Doors and frames, special size	
➤ Door accessories	61
➤ Glass doors accessories	71
➤ technical information	

Door frame extrusion

door system 40 mm
L 6000 x W 40 x H 58 mm



C 301.01

aluminium

for 40 mm door systems
L 6000 x W 40 x H 58 mm | 7.54 kg

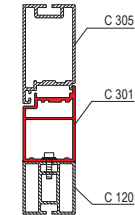
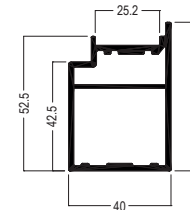

Window panel extrusion

door system 40 mm
L 6000 x B 40 x H 75.5 mm



C 305.01

aluminium

for 40 mm door systems
L 6000 x B 40 x H 75.5 mm | 8.62 kg

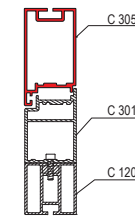
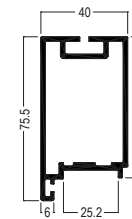

Corner connector

90°
for extrusion C 305

C 401.37

steel, zinc plated

incl. 4 countersunk head screws M6 for door frame extrusion
C 305
L 145 x B 145 x H 35 mm | 0.626 kg

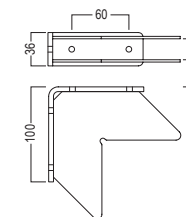

Door panel extrusion

door system 40 mm
L 5400 x B 40 x H 75.5 mm



C 308.01

aluminium

for 40 mm door systems
L 5400 x B 40 x H 75.5 mm | 11.45 kg

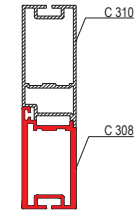
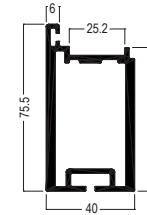

Corner connector

90°
for extrusion C 308

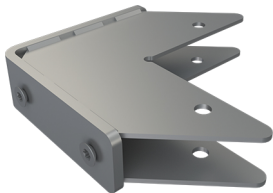

C 402.37

steel, zinc plated

incl. 4 countersunk screws M6 for door panel extrusion C 308
L 145 x B 145 x H 32 mm | 0.591 kg

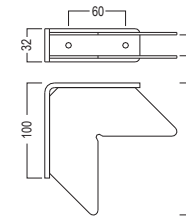

Corner connector

90°
for sliding door

C 407.37

steel

L 190 x B 190 x H 35 mm | 1.006 kg

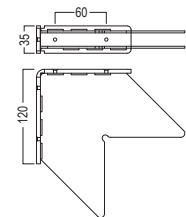

Double door extrusion

door system 40 mm
L 6000 × W 40 × H 91 mm



C 310.01

aluminium

for 40 mm door systems
L 6000 × W 40 × H 91 mm | 10.8 kg

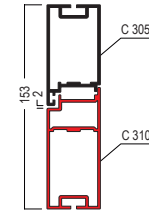
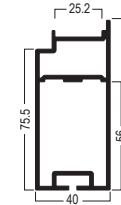

Door beam extrusion

door system 40 mm
L 6000 × W 40 × H 160 mm



C 315.01

aluminium

for 40 mm door systems, L 6000 × W 40 × H 160 mm
L 6000 × W 40 × H 160 mm | 16.362 kg

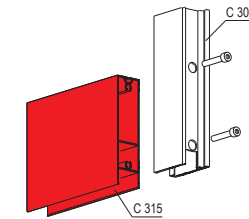
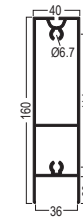

Door frame extrusion

door system 60 mm
L 6000 × W 60 × H 64 mm



C 302.00 | .01

aluminium

for 60 mm door systems
L 6000 × W 60 × H 64 mm | 9.514 kg

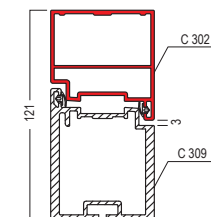
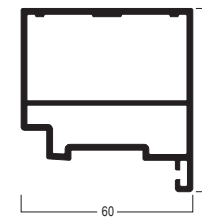

Door panel extrusion

door system 60 mm
L 5500 × B 60 × H 75.5 mm



C 309.01

aluminium

for 60 mm door systems
L 5500 × B 60 × H 75.5 mm | 14.456 kg

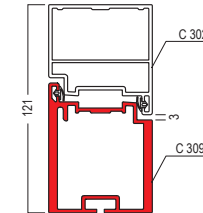
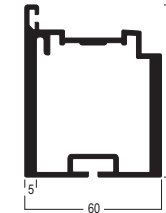

Door beam extrusion

door system 60 mm
L 6000 × W 60 × H 160 mm



C 316.01

aluminium

for 60 mm door systems
L 6000 × W 60 × H 160 mm | 18.119 kg



Corner connector

90°
for extrusion C 309

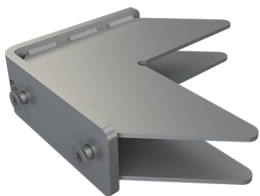

C 400.37

for door panel extrusion C 309
L 140 × B 140 × H 38 mm | 0.62 kg

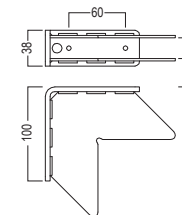

Corner connector

90°
for short door

C 403.37

steel, zinc plated

for short door

L 90 x B 90 x H 36 mm | 0.516 kg

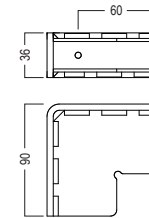

Frame extrusion

door system 60 mm
for door glazing

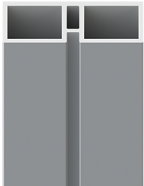

C 1210.01

aluminium

for 60 mm door systems door glazing

L 6000 x W 19,5 x H 47,4 mm | 4.333 kg

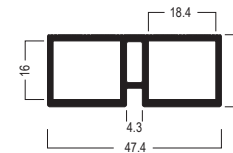

Door frame

right
for axis measurement 900 mm

C 350/R.01

aluminium

right, in combination with C 354-1NR or C 354-2NR for axis measurement 900 mm

L 860 × H 2170 × D 58 mm | 6.528 kg

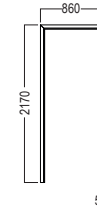

Door frame

left
for axis measurement 900 mm

C 350/L.01

aluminium

left, in combination with C 354-1NL or C 354-2NL for axis measurement 900 mm

L 860 × H 2170 × D 58 mm | 6.528 kg

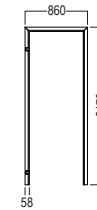

Door frame

right
for axis measurement 1200 mm

C 351/R.01

aluminium

in combination with C 355-1NR or C 355-2NR for axis measurement 1200 mm

L 1160 × H 2170 × D 58 mm | 7.192 kg

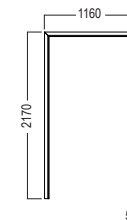

Door frame

left
for axis measurement 1200 mm

C 351/L.01

aluminium

in combination with C 355-1NL or C 355-2NL for axis measurement 1200 mm

L 1160 × H 2170 × D 58 mm | 7.192 kg

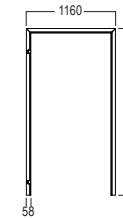

double door frame

right
for axis measurement 1800 mm

C 352/R.01

aluminium

right, in combination with C 355-1NR and C 356-1NR or C 355-2NR and C 356-2NR for axis measurement 1800 mm

L 1760 × H 2170 × D 58 mm | 8.7 kg

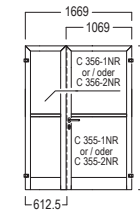
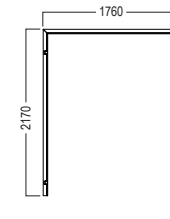

double door frame

left
for axis measurement 1800 mm

C 352/L.01

aluminium

left, in combination with C 355-1NL and C 356-1NL or C 355-2NL and C 356-2NL for axis measurement 1800 mm

L 1760 × H 2170 × D 58 mm | 8.7 kg

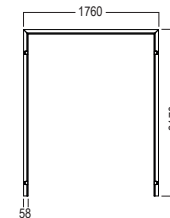

Door frame

right
for axis measurement 2400 mm

C 353/R.01

aluminium

right, in combination with C 355-1NR and C 357-1NR or C 355-2NR
und C 357-2NR for axis measurement 2400 mm

L 2360 × H 2170 × D 58 mm | 9.556 kg

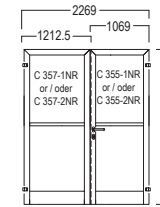
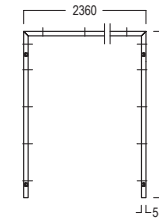

Door frame

left
for axis measurement 2400 mm

C 353/L.01

aluminium

left, in combination with C 355-1NL and C 357-1NL or C 355-2NL
and C 357-2NL for axis measurement 2400 mm

L 2360 × H 2170 × D 58 mm | 9.556 kg

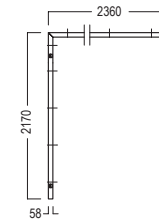

➤ Door accessories

Electronics Door Systems

Controller

4 x light red/green
for 2 doors

C 572.90

plastic

consisting of 1 x controller for 2 doors 4 x lights red/green with emergency power-off switch 2 x wire for door opener

L 0 x B 0 x H 0 mm | 2.613 kg

Controller

8 x light red/gren
for 3-4 doors

C 574.90

plastic

consisting of 1 x controller for 3-4 doors 8 x lights red/green with emergency power-off switch 4 x wire for door opener

L 0 x B 0 x H 0 mm | 4.281 kg

End cap

for door frame
for drill hole 15 mm dia.

C 421.31

plastic

for door frame, for drill hole 15 mm dia.

L 19 x B 19 x H 12 mm |

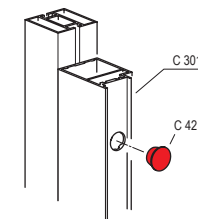

End cap

for door leaf
for drill hole 14 mm dia.

C 422.30

plastic

for door leaf, for drill hole 14 mm dia.

L 18 x B 18 x H 12 mm |

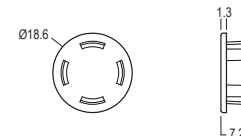

Mortise lock

for profile cylinder lock

C 501.90

steel

for profile cylinder lock

L 270 x B 50 x H 24 mm | 0.655 kg

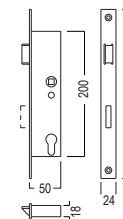

Mortise lock

for KABA cylinder lock

C 501 CH.90

steel

for KABA cylinder lock

L 270 x B 50 x H 24 mm | 0.655 kg

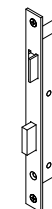
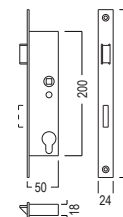

Mortise lock

with panic function
for profile cylinder lock

C 502.90

steel

available in the following finishes: C 502 B-L C 502 C-L C 502 D-L
C 502 B-R C 502 C-R C 502 D-R C 502 E

L 270 x B 50 x H 24 mm | 0.651 kg

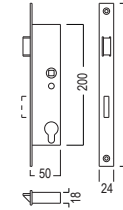

Lock cylinder

for C 501



C 503.38

steel

for C 501

L 100 x B 40 x H 30 mm | 0.222 kg

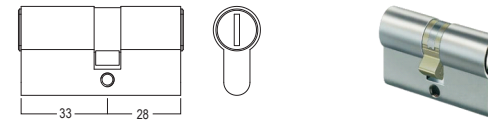

Lock face plate

1 pair
für C 501



C 505.90

aluminium

für C 501, 1 pair

L 70 x B 32 x H 7 mm | 0.031 kg



Lock face plate

1 pair
for C 501 CH

C 505 CH.90

aluminium

for C 501 CH, 1 pair

L 70 x B 33 x H 20 mm | 0.031 kg



Lock face plate

1 pair

C 506.90

aluminium

1 pair

L 70 x B 32 x H 7 mm | 0.032 kg

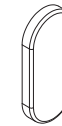

Door handle set

set

C 510.90

aluminium

consisting of: 2 x handle 1 x bar steel 2 x blind face plate C 506

L 160 x B 100 x H 70 mm | 0.754 kg

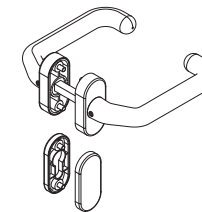

Door handle



C 536.90

aluminium

For 8 mm square bar steel door knob

L 175 x B 30 x H 70 mm | 0.241 kg

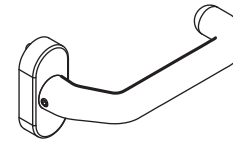

Door knob



C 537.90

aluminium

L 98 x B 81 x H 70 mm | 0.311 kg

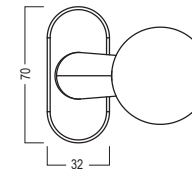

Square bar steel

for door handle / door knob

C 538.90

steel

9 mm on one side reduced to 8 mm for combination with door handle and door knob

L 60 x B 9 x H 9 mm | 0.032 kg

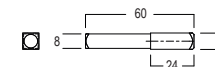

Square bar steel

9 x 95 mm

C 510/1.90

steel

9 x 95 mm | 0.059 kg

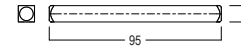

Door hinge



C 515.90

aluminium

incl. mounting accessory

L 134 x B 107 x H 42 mm | 0.392 kg

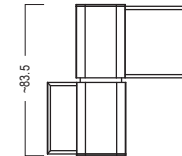

Striker plate

270 x 24 mm



C 520.90

steel

basic

270 x 24 mm | 0.116 kg

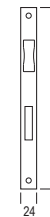

Electric door opener

for all-glass door



C 539.90

mounting horizontal and vertical possible can be mounted door left and right by rotating 180°
adjustable door thickness from 9-12 and 13-15 mm
L 0 x B 0 x H 0 mm | 0,345 kg

Cabinet lock

for door / drawer



C 585.90

plastic, black

optional fitting sideways or from above to lock doors or drawer
locking by key switch or code or cardreader system
L 150 x B 40 x H 50 mm | 0.131 kg

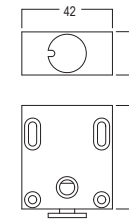

Transformer

24 V DC / 25 W max.
for pass through box



C 587.90

plastic

24 V DC 25 W max., for pass through box
L 125 x B 30 x H 40 mm | 0.102 kg

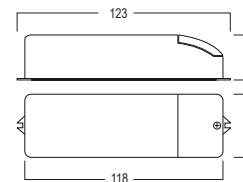

Door accessories

Electronics Door Systems

Reed switch

for window / door



C 591.90

plastic

for monitoring of windows and doors if they are open

L 0 x B 0 x H 0 mm | 0.06 kg

Door bumper



C 533.01

aluminium

L 80 x B 45 x H 0 mm | 0.08 kg

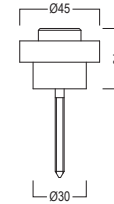

Gasket

for C 354
741 mm long

C 540.90

rubber/aluminium

for single sided door, axis measurement 900 mm, 741 mm long

L 741 x B 0 x H 0 mm | 0.46 kg

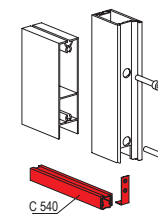
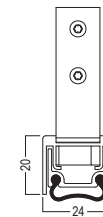

Gasket

for C 355
1041 mm long

C 541.90

rubber/aluminium

for single sided door (axis measurement 1200 mm), for double sided door (axis measurement 1800/2400 mm), 1041 mm long

L 1041 x B 0 x H 0 mm | 0.644 kg

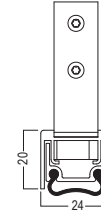

Gasket

for C 356
590 mm long

C 542.90

rubber/aluminium

for stationary leaf C 356 or double sided door (axis measurement 1800 mm), 590 mm long

L 590 x B 0 x H 0 mm | 0.39 kg

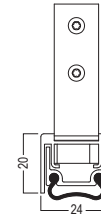

Gasket

for C 357
1190 mm long

C 543.90

rubber/aluminium

for stationary leaf C 537 or 2 sided door (axis measurement 2400 mm), 1190 mm long

L 1190 x B 0 x H 0 mm | 0.744 kg

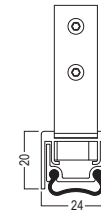

↗ Door accessories

Electronics Door Systems

Door closer
automatic

C 545.90
steel

L 450 x B 70 x H 100 mm | 3.205 kg

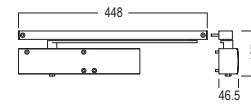

Door cylinder

for W 425 / W 575 / W 805
L 61 x W 42 x H 28 mm



W 514.38

steel

1 x dead lock cylinder, for mounting into door W 425 / W 575 / W 805, incl. 3 x key W 514/S

L 61 x W 42 x H 28 mm | 0.222 kg

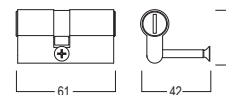

Gasket

10 mm long



C 321.33

rubber

10 mm long

L 5000 x B 0 x H 0 mm | 0.26 kg



Self tapping screw

for door frame

C 390.37

steel, zinc plated

for door frame connection

L 25 x B 5 x H 0 mm | 0.003 kg



Self tapping screw

C 693-4819.37

steel, zinc plated

self drilling screw with truss head ZEBRA Plus

L 19 x B 5 x H 0 mm | 0.002 kg



Pharmacy Systems

» Technics 11/25

Cleanrooms with a system.



➤ Contents

➤ Pharmacy Systems

➤ Pharmacy Wall Systems	75
➤ Pharmacy Ceiling Systems	76
➤ Pharmacy Door Systems	77
➤ technical information	

Channeling extrusion

L 6000 × W 36 × H 36 mm



C 1301.01

aluminium

L 6000 × W 36 × H 36 mm | 2.624 kg

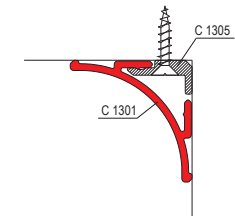
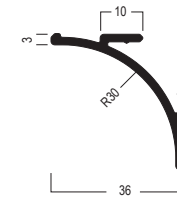

Thread rod

M8
1000 mm long



C 661.37

steel, zinc plated

1000 mm long

L 1000 x B 8 x H 8 mm | 0.279 kg

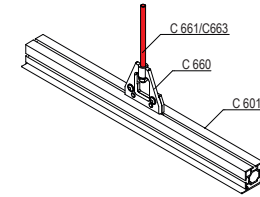
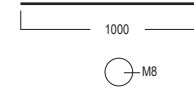

Frame extrusion

door system pharma 40 mm
for door glass elements



C 1220.00 | .01

aluminium

for 40 mm door systems door glass elements

L 6000 × W 19.5 × H 31.4 mm | 3.424 kg

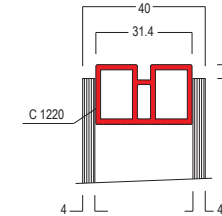
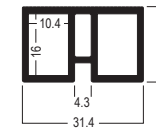

Lock plate

for floor beam
for pharma door 40 mm

C 1240.37

steel, zinc plated

for floor beam for Pharma door 40 mm, incl. 2 fixing screws M8 for doors C 1201.....C 1215

L 140 x B 32 x H 4 mm | 0.04 kg

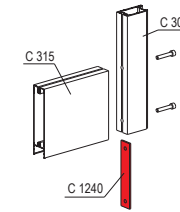
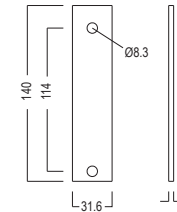

Door glazing

for pharma door 40 mm
for door C 1234 / C 1238

C 1222.90

glass/aluminium

tempered glass 2 x 4 mm, installation depth 40 mm edges closed all round for mounting to doors C 1234, C 1238

1013 × 445 mm | 10.681 kg

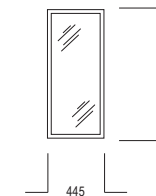

Door glazing

for pharma door 40 mm
for door C 1214 / C 1218

C 1224.90

glass/aluminium

tempered glass 2 x 4 mm, installation depth 40 mm edges closed
all round for mounting to doors C 1214, C 1218, C 1234, C 1238,
C 1244, C 1248

1013 x 813 mm | 18.6 kg

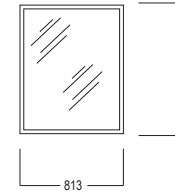

Door glazing

for pharma door 40 mm
custom size

C 1229.90

glass/aluminium

tempered glass 2 x 4 mm, installation depth 40 mm edges closed
all round for mounting to special size doors

custom size |

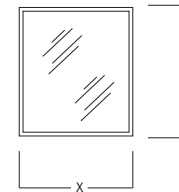

Door glazing

for pharma door 40 mm
for C 1244 / C 1248

C 1230.90

glass/aluminium

tempered glass 2 x 4 mm, installation depth 40 mm edges closed
all round for mounting to doors C 1244, C 1248

1013 x 1045 mm | 23.8 kg

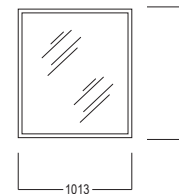

Door panel

for pharma door 40 mm
for C 1234 / C 1238

C 1282.80

sheet metal, powdercoated

installation depth 40 mm, edges closed all round, for mounting to
doors C 1234 and C 1238

819 × 436 mm |

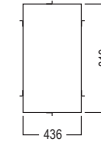

Door panel

for pharma door 40 mm
819 × 804 mm

C 1284.80 | .85

sheet metal, powdercoated

installation depth 40 mm, edges closed all round, for mounting to
doors C 1214, C 1218, C 1234, C 1238, C 1244, C 1248

819 × 804 mm |

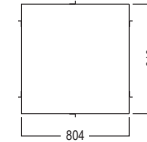

Door panel

for pharma door 40 mm
custom size

C 1289.80

sheet metal, powdercoated

installation depth 40 mm, edges closed all round, for mounting to
special size doors

custom size |

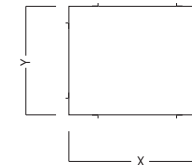

Door panel

for pharma door 40 mm
for C 1244 / C 1248

C 1290.80

sheet metal, powdercoated

installation depth 40 mm, edges closed all round, for mounting to
doors C 1244 and C 1248

1036 × 819 mm |

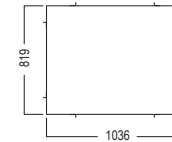

Cleanroom Extrusions in General

» Technics 11/25

Cleanrooms with a system.

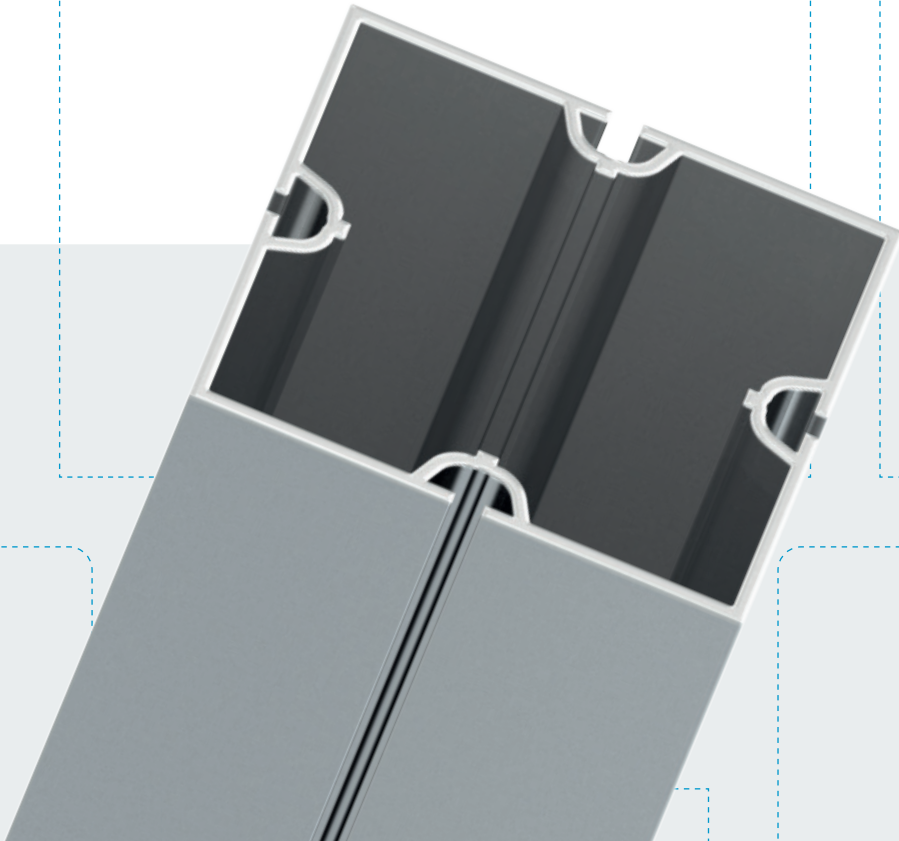

➤ Contents

➤ Extrusions in general

➤ 60 x 60 mm	83
➤ 80 x 80 mm	84
➤ 160 x 80 mm	87
➤ 80 mm	88
➤ 120 x 120 mm	89
➤ 40 x 28 mm	
➤ 60 x 40 mm	92
➤ 80 x 40 mm	93
➤ 120 x 80 mm	95
➤ 200 x 40 mm	96
➤ 80 mm	97
➤ 100 x 32 mm	
➤ 32 x 32 mm	98
➤ 32 x 16 mm	102
➤ 37 x 16 mm	103
➤ 40 x 16 mm	104
➤ 40 x 32 mm	105
➤ 50 x 16 mm	106
➤ 70 x 16 mm	107
➤ technical information	

↗ 60 x 60 mm

Extrusions in general

Adjustable foot

M 10
for extrusions 60 x 60 mm



M 1067.37

steel

for extrusions 60 x 60 mm, thread M10, incl. 2 x set screw
M 1075/20 (M4)

L 62 x W 62 x H 74 mm | 0.236 kg

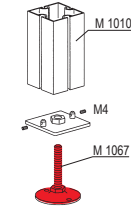
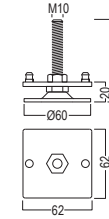

80 x 80 mm

Extrusions in general

Square extrusion

4 system grooves
L 5000 x W 80 x H 80 mm



M 1020.01

aluminium

adaptors with tension lock M 1101 / M 1103, adaptors with safety tension lock M 1114 / M 1116 and adaptor for hinged end plates M 1281 can be mounted, with 4 system grooves

L 5000 x W 80 x H 80 mm | 11.514 kg

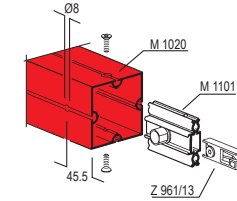
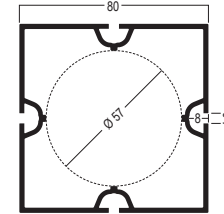

Square extrusion

L 6000 x W 80 x H 80 mm
6000 mm long



M 1021.01

aluminium

adaptors with tension lock M 1101 / M 1103, adaptors with safety tension lock M 1114 / M 1116 and adaptor for hinged end plates M 1281 can be mounted

L 6000 x W 80 x H 80 mm | 12.886 kg

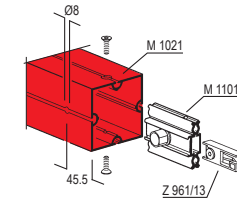
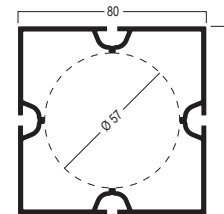

Adaptor

with Z 961/13
for extrusions 80 mm

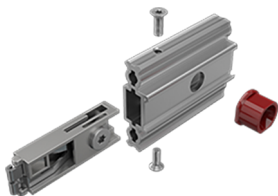

M 1101.00

aluminium

for all square and round extrusions 80 mm, incl. 1 x tension lock Z 961/13, 1 x collar guide M 1102/2 and 2 x countersunk screw M 1100/20 (M5)

L 80 x W 19 x H 57 mm | 0.144 kg

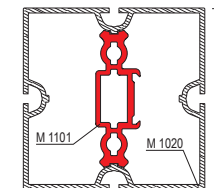
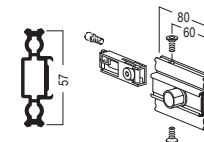

80 x 80 mm

Extrusions in general

Base plate

for extrusions 80 mm
L 300 x W 300 x H 108 mm

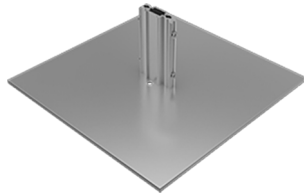

M 1406.21

steel

for all square and round extrusions 80 mm, incl. adaptor M 1406/2, 2 x countersunk screw M 1406/20 (M8) and 4 x countersunk screw M 1611/20 (M5)

L 300 x W 300 x H 108 mm | 4.602 kg

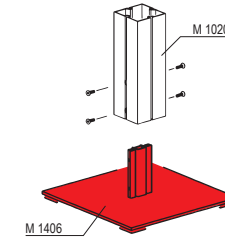
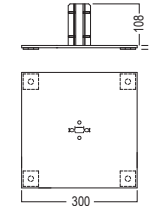

Square extrusion

L 6000 x W 80 x H 80 mm
6000 mm long

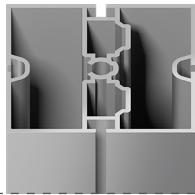

M 1019.01

aluminium

tension lock Z 961/8 can be mounted

L 6000 x W 80 x H 80 mm | 17.8 kg

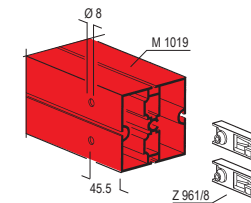
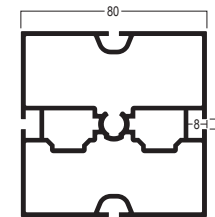

End cap

for extrusions 80 x 80 mm
L 80 x W 80 x H 3 mm

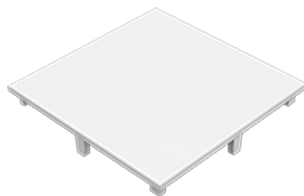

M 1034.35

plastic, light grey

for extrusions 80 x 80 mm, for square extrusions M 1018 /M 1020 and lighttrack mounting extrusion M 1059

L 80 x W 80 x H 3 mm | 0.021 kg

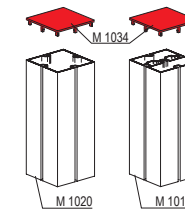
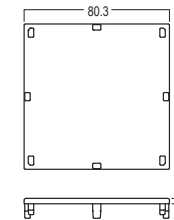

80 x 80 mm

Extrusions in general

End plate

for extrusions 80 x 80 mm
L 80 x W 80 x H 3 mm

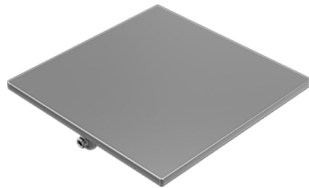

M 1035.21

steel

for square extrusions M 1018 / M 1020 and lighttrack mounting extrusion M 1059, incl. 2 x set screw M 1075/20 (M4)

L 80 x W 80 x H 3 mm | 0.159 kg

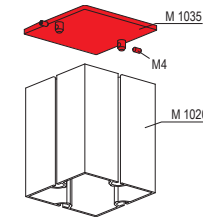
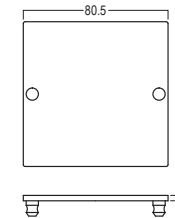

Cover extrusion

for extrusions 80 mm
L 5000 x W 81 x H 2 mm



M 1367.01

aluminium

can be powder-coated or film laminated, with slide-on technique for all extrusions 80 mm

L 5000 x W 81 x H 2 mm | 2.12 kg

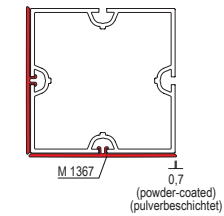
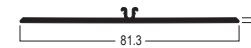

Spigot tube

square
L 80 x W 80 x H 404 mm



M 1424.00

aluminium

for extension of upright extrusions, for extrusions M 1020 / M1021 / M 1017

L 80 x W 80 x H 404 mm | 0.891 kg

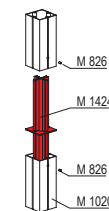
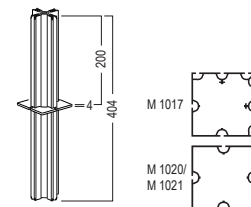

↗ 160 x 80 mm

Extrusions in general

Rectangular extrusion

L 6930 x W 80 x H 160 mm
6930 mm long



M 1052.01

aluminium

adaptor with tension lock M 1103 can be mounted
L 6930 x W 80 x H 160 mm | 28.346 kg

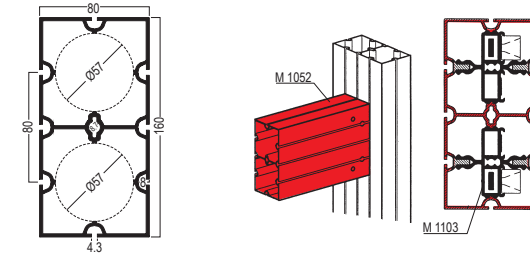

End plate

for M 1052
L 160.5 x W 80.5 x H 3 mm



M 1097.21

steel

for rectangular extrusion M 1052, incl. 2 x set screw M 1075/20 (M4)
L 160.5 x W 80.5 x H 3 mm | 0.313 kg

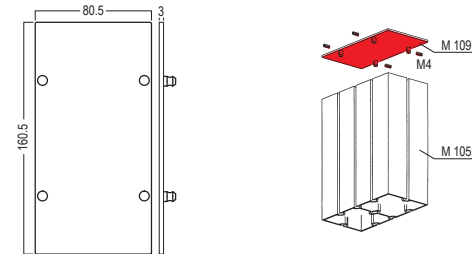

Adjustable foot

M10
for M 1052



M 1098.37

steel

for rectangular extrusion M 1052, thread M10, incl. 2 x set screw M 1075/20 (M4)
L 162 x W 82 x H 74 mm | 0.532 kg

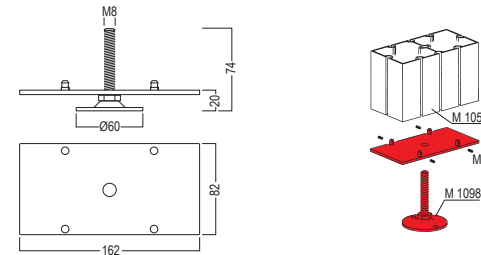

↗ 80 mm

Extrusions in general

Angle extrusion

135°
L 5000 × W 77 × H 80 mm

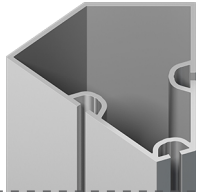

M 1070.01

aluminium

135°, 3 system grooves
L 5000 × W 77 × H 80 mm | 8.375 kg

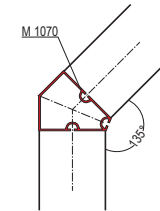
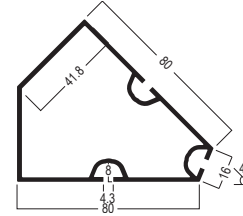

End plate

135°
for corner extrusion M 1070

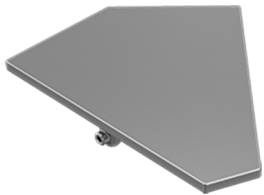

M 1095.21

steel

135°, for exterior corner extrusion M 1070, incl. 2 × set screw
M 1075/20 (M4)
L 90 × W 78 × H 3 mm | 0.101 kg

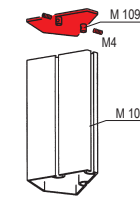
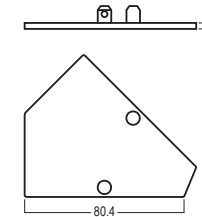

Adjustable foot

135°
for angle extrusion M 1070



M 1096.37

steel

135°, for exterior corner extrusion M 1070, thread M10, incl. 1 × set
screw M 1075/20 (M4)
L 92 × W 78.6 × H 74 mm | 0.263 kg

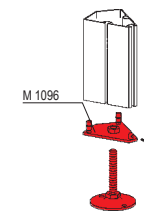
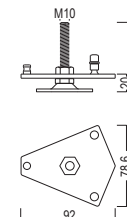

120 x 120 mm

Extrusions in general

Square extrusion

4 system grooves
L 5000 x W 120 x H 120 mm



M 225.01

aluminium

adaptors with tension lock M 1102 / M 1122, adaptors with safety tension lock M 1124 / M 1126, with 4 system grooves

L 5000 x W 120 x H 120 mm | 19.806 kg

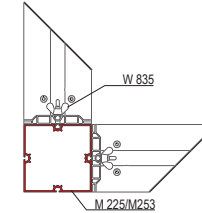
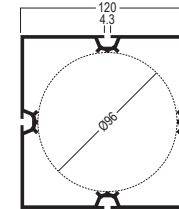

Square extrusion

L 6000 x W 120 x H 120 mm
6000 mm long



M 226.01

aluminium

adaptors with tension lock M 1102 / M 1122, adaptors with safety tension lock M 1124 / M 1126

L 6000 x W 120 x H 120 mm | 22.708 kg

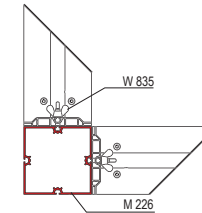
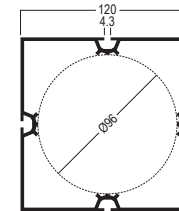

Adaptor

with 2 x Z 961/13
for extrusions 120 mm

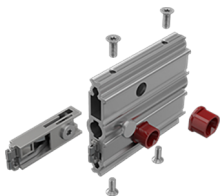

M 1102.00

aluminium

for all closed square extrusions 120 mm, incl. 2 x tension lock Z 961/13, 1 x knurled-head screw M 1102/21 (M4) for beam retainer M 1106, 2 x collar guide M 1102/2 and 4 x countersunk screws M 1102/20 (M6)

L 108 x W 22.5 x H 95 mm | 0.339 kg

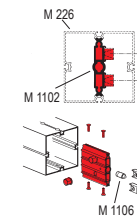
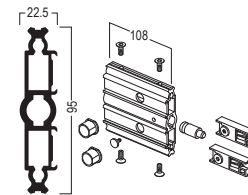

↗ 120 x 120 mm

Extrusions in general

Base plate

for extrusions 120 mm
L 450 × W 450 × H 250 mm

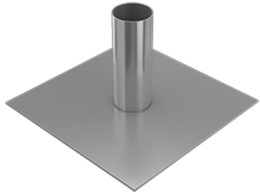

M 1426.21

steel

for all square extrusions 120 mm, incl. adaptor M 825/A and 4 × countersunk screw eZ5030/20 (M10)

L 450 × W 450 × H 250 mm | 11.44 kg

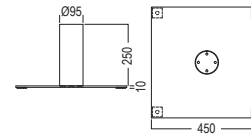

Reinforcing plate

with set screw M 826/S
small



M 826.00

aluminium

small, incl. 1 × set screw M 826/S (M6)

L 16 × W 10 × H 6 mm | 0.005 kg

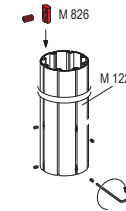

End plate

for extrusions 120 × 120 mm
L 121 × W 121 × H 3 mm

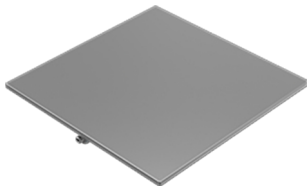

M 274.21

steel

for all square extrusions 120 mm, incl. 2 × set screw M 1075/20 (M4)

L 121 × W 121 × H 3 mm | 0.36 kg

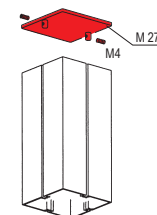
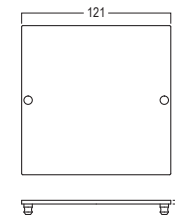

↗ 120 x 120 mm

Extrusions in general

Adjustable foot

for extrusions 120 x 120 mm
L 123 x W 123 x H 74 mm



M 285.37

steel

for all square extrusions 120 mm, thread M16, incl. 2 x set screw
M 1075/20 (M4)

L 123 x W 123 x H 74 mm | 0.79 kg

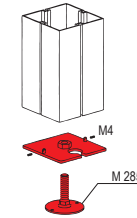
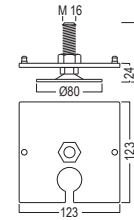

Spigot tube

square
for extrusions 120 x 120 mm



M 1419.00

aluminium

for extension of upright extrusions, for all square extrusions 120 mm

L 120 x W 120 x H 604 mm | 1.842 kg

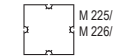
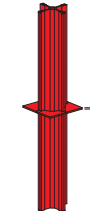
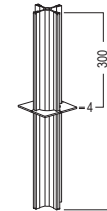

➤ 60 x 40 mm

Extrusions in general

Rectangular extrusion

L 6000 x W 60 x H 40 mm
6000 mm long

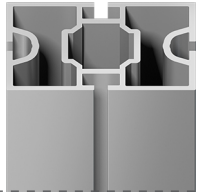

M 1082.01

aluminium

tension lock Z 961/8 can be mounted in 2 positions, 6000 mm long

L 6000 x W 60 x H 40 mm | 10.732 kg

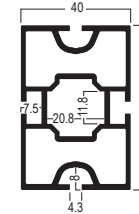

➤ 80 x 40 mm

Extrusions in general

Rectangular extrusion

L 5000 x W 40 x H 80 mm
5000 mm long



M 1025.01

aluminium

tension lock Z 961/8 can be mounted in 2 positions

L 5000 x W 40 x H 80 mm | 10.218 kg

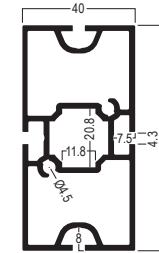

Rectangular extrusion

L 6000 x W 40 x H 80 mm
6000 mm long



M 1026.01

aluminium

tension lock Z 961/8 can be mounted in 2 positions

L 6000 x W 40 x H 80 mm | 12.7 kg

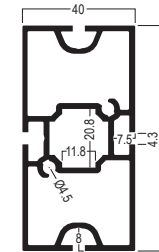

End plate

for M 1025
L 40.3 x W 80.3 x H 3 mm

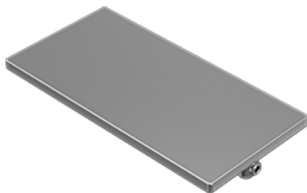

M 1085.21

steel

for rectangular extrusions M 1025 (40 x 80 mm), incl. 2 x set screw
M 1075/20 (M4)

L 40.3 x W 80.3 x H 3 mm | 0.08 kg

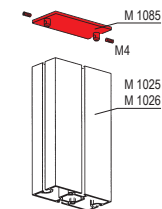
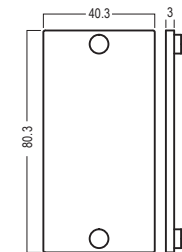

➤ 80 x 40 mm

Extrusions in general

Adjustable foot

M8
for M 1025/M 1026



M 1086.37

steel

for rectangular extrusion M 1025/M 1026 (40 x 80 mm), thread M8
incl. 2 x set screw M 1075/20 (M4)

L 80 x W 40 x H 94 mm | 0.181 kg

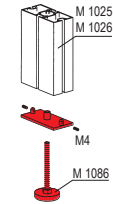
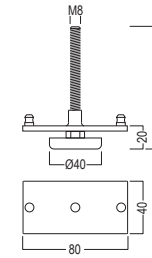

↗ 120 x 80 mm

Extrusions in general

End plate

for M 1031
L 40 × W 120 × H 3 mm



M 1087.21

steel

for rectangular extrusion M 1031, incl. 2 × set screw M 1075/20 (M4)
L 40 × W 120 × H 3 mm | 0.12 kg

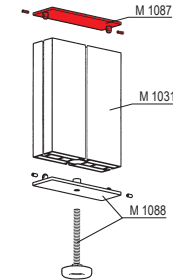
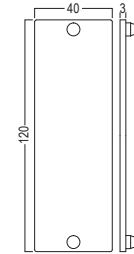

Adjustable foot

M8
for M 1030



M 1088.37

steel

for rectangular extrusion M 1030, thread M8, incl. 2 × set screw
M 1075/20 (M4)
L 120 × W 42 × H 94 mm | 0.237 kg

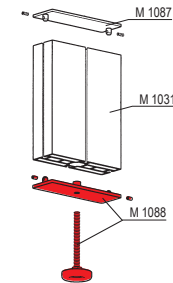
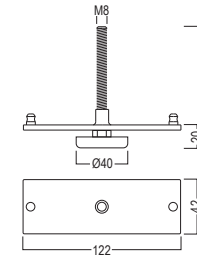

↗ 200 x 40 mm

Extrusions in general

Supporting beam

6 system grooves
L 7000 x W 200 x H 40 mm



M 770.01 aluminium

2 x tension lock Z 961/8 can be mounted in 2 positions or 3 x tension lock Z 961/13 with adaptor Z 161/A, with 6 system grooves
L 7000 x W 200 x H 40 mm | 35.533 kg

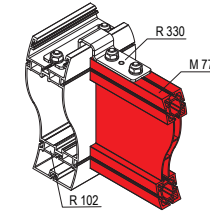
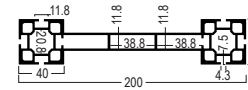

! Attention: Pay attention to lock direction.

Reinforcement

with 3 x M 1435/70
L 102.6 x W 8 x H 102.6 mm



M 1129.37 steel

for system groove 4.3 mm, incl. 3 x set screw M 1435/70 (M8) and 2 x round head screw with flange M 1557/20 (M6)
L 102.6 x W 8 x H 102.6 mm | 0.376 kg

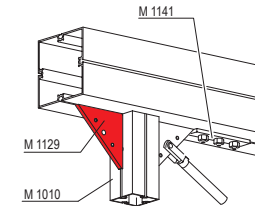
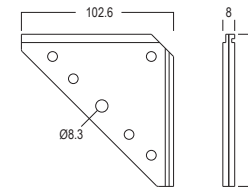

Reinforcing plate

with 6 x M 1473
L 240 x W 240 x H 6 mm

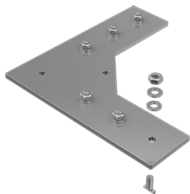

M 1164.21 steel

for extrusions 80 x 80 mm, incl. 6 x hammerhead screw M 1473 (M8)
L 240 x W 240 x H 6 mm | 1.535 kg

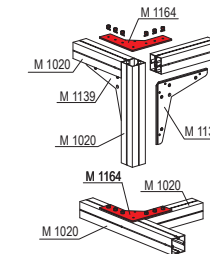
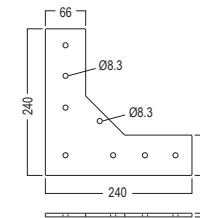

! Attention: item has to be used for safety reasons as "beam retainer"

↗ 80 mm

Extrusions in general

End plate

round, 80 mm dia.
L 82 × W 82 × H 3 mm



M 1235.21

steel

for all round extrusions 80 mm dia, incl. 2 × set screw M 1075/20 (M4)

L 82 × W 82 × H 3 mm | 0.129 kg

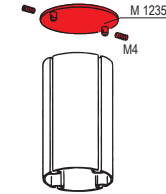
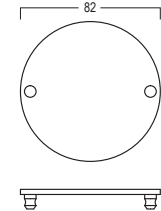

Adjustable foot

round
for extrusions 80 mm dia.



M 1234.37

steel

for all round extrusions 80 mm dia., thread M10, incl. 2 × set screw M 1075/20 (M4)

L 82 × W 82 × H 74 mm | 0.269 kg

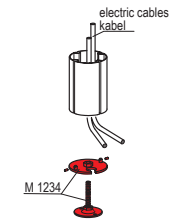
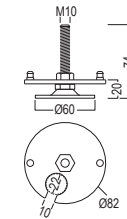

↗ 32 x 32 mm

Extrusions in general

Double triangular

3 system grooves
L 5000 x W 32 x H 32 mm

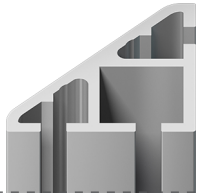

S 1303.01

aluminium

3 system grooves
L 5000 x W 32 x H 32 mm | 3.196 kg

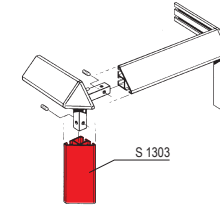
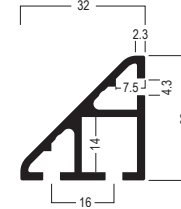

Quarter-round extrusion

3 system grooves
L 5000 x W 32 x H 32 mm

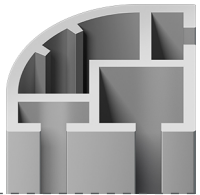

S 1105.01

aluminium

3 system grooves
L 5000 x W 32 x H 32 mm | 4.02 kg

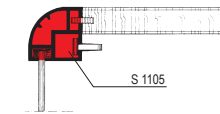
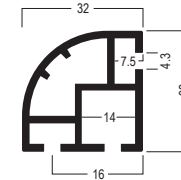

End cap

for S 1100/S 1105
L 32 x W 32 x H 14 mm



S 1130.35

plastic

for quarter-round extrusions S1100 / S 1105
L 32 x W 32 x H 14 mm | 0.004 kg

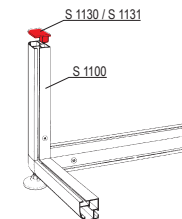
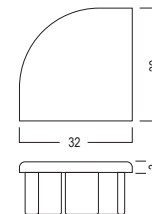

↗ 32 x 32 mm

Extrusions in general

End plate

for S 1100/S 1105
L 32 × W 32 × H 23 mm

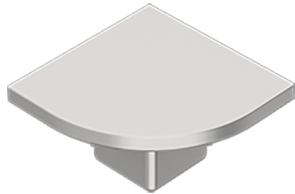

S 1131.39

zinc die cast

for quarter-round extrusions S1100 / S 1105
L 32 × W 32 × H 23 mm | 0.036 kg

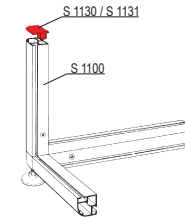
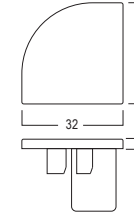

Threaded plug

M10
for S 1100/S 1105



S 1132.00

zinc die cast

thread M10, for quarter-round extrusions S 1100 / S 1105
L 14 × W 14 × H 36 mm | 0.035 kg

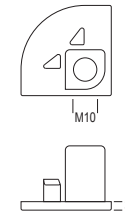

End plate

for S 1303
L 33 × W 33 × H 23 mm



S 1334.39 | .41

zinc die cast

for triangular extrusion S 1303
L 33 × W 33 × H 23 mm | 0.03 kg

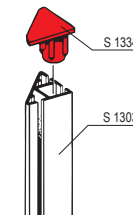
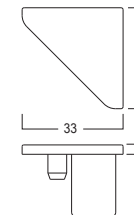

↗ 32 x 32 mm

Extrusions in general

Threaded plug

M10
for S 1303



S 1336.00

zinc die cast

for triangular extrusion S 1303, with female thread M10

L 33 × W 33 × H 23 mm | 0.03 kg

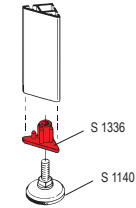
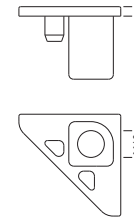

Square extrusion

3 system grooves
L 5000 × W 32 × H 32 mm

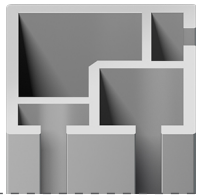

S 1125.01

aluminium

3 system grooves

L 5000 × W 32 × H 32 mm | 4.032 kg

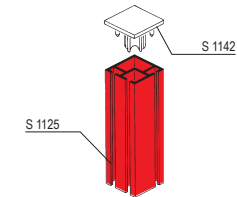
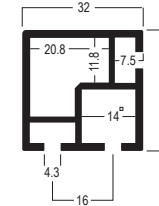

End plate

for S 1125
L 32 × W 32 × H 23 mm

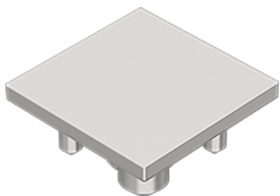

S 1142.39

zinc die cast

for square extrusion S 1125

L 32 × W 32 × H 23 mm | 0.032 kg

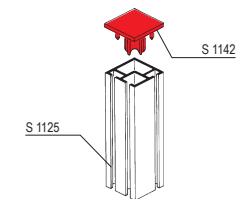
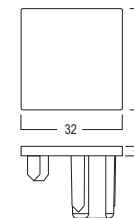

↗ **32 x 32 mm**

Extrusions in general

Knuckle

**90°
for 3 × S 1125**

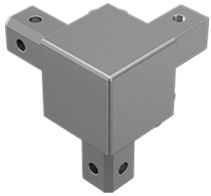

S 1190.39

zinc die cast

90°, for mounting 3 × square extrusion S 1125, incl. 3 × countersunk screw E 111/m (M6) and 3 × set screw E 111/g (M6)

L 72 × W 72 × H 72 mm | 0.266 kg

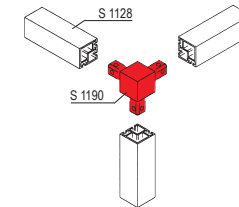
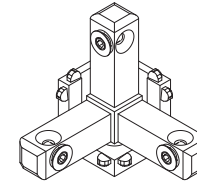

↗ 32 x 16 mm

Extrusions in general

Beam extrusion

for bracing
groove depth 7 mm



Z 308.01 | .11

aluminium

for bracing, tension lock Z 961/13 can be mounted, groove depth 7 mm

L 5000 x W 32 x H 16 mm | 2.68 kg

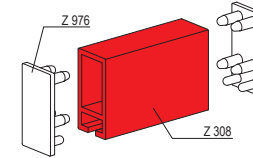
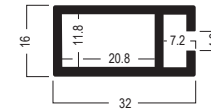

End cap

for beam extrusion Z 308
L 32 x W 16 x H 12 mm



Z 976.35

plastic, light grey

for beam extrusion Z 308, 2 mm thick

L 32 x W 16 x H 12 mm | 0.002 kg

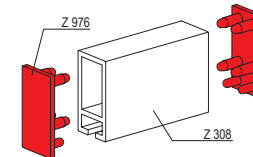
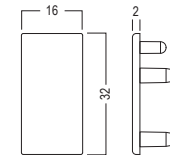

↗ 37 x 16 mm

Extrusions in general

Beam extrusion

groove depth 10 mm
L 5000 x W 37 x H 16 mm



Z 310.01 | .11

aluminium

tension lock Z 961/13 can be mounted, groove depth 10 mm
L 5000 x W 37 x H 16 mm | 2.962 kg

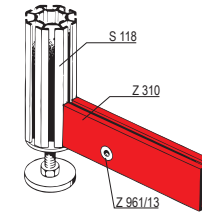
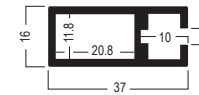

End cap

for beam extrusion Z 310
L 37 x W 16 x H 12 mm



Z 974.30 | .35

plastic

for beam extrusion Z 310
L 37 x W 16 x H 12 mm | 0.002 kg

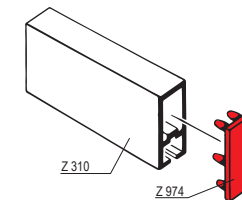
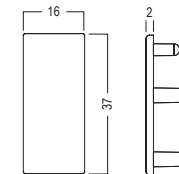

40 x 16 mm

Extrusions in general

Beam extrusion

2 system grooves
L 5000 x W 40 x H 16 mm

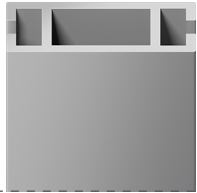

Z 4400.01

aluminium

2 system grooves, tension lock Z 961/13 can be mounted, groove depth 7 mm

L 5000 x W 40 x H 16 mm | 3.2 kg

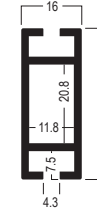

Beam extrusion

1 system groove
L 5000 x W 40 x H 16 mm



Z 4401.01

aluminium

1 system groove, tension lock Z 961/13 can be mounted

L 5000 x W 40 x H 16 mm | 3.38 kg

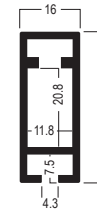

End cap

L 41 x W 16 x H 12 mm



Z 4430.35

plastic

for beam extrusions Z 4100 / Z 4300 / Z 4400 / Z 4401

L 41 x W 16 x H 12 mm | 0.002 kg

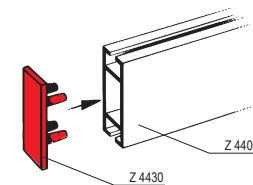
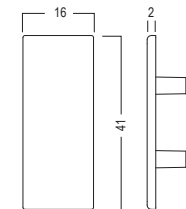

40 x 32 mm

Extrusions in general

Beam extrusion

4 system grooves
L 5000 x W 40 x H 32 mm

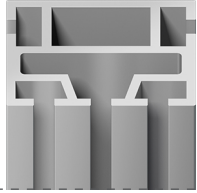

Z 2100.01

aluminium

4 system grooves, tension lock Z 961/13 can be mounted
L 5000 x W 40 x H 32 mm | 5.99 kg

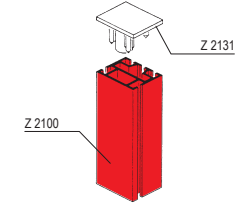
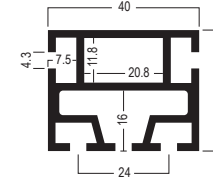

Beam extrusion

3 system grooves
L 5000 x W 40 x H 32 mm

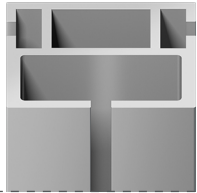

Z 2105.01

aluminium

3 system grooves, tension lock Z 961/13 can be mounted
L 5000 x W 40 x H 32 mm | 5.56 kg

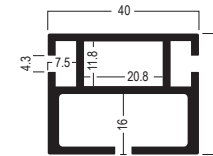

End plate

for Z 2100/Z 2105
L 40 x W 32 x H 23 mm

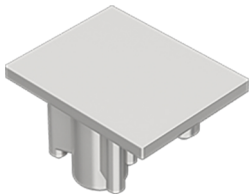

Z 2131.39

zinc die cast

for beam extrusions Z 2100 / Z 2105
L 40 x W 32 x H 23 mm | 0.038 kg

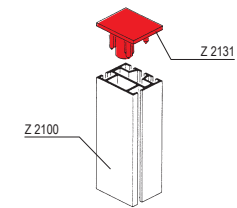
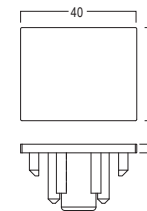

↗ 50 x 16 mm

Extrusions in general

Beam extrusion

for 2 × Z 961/13
L 5000 × W 50 × H 16 mm



Z 402.01

aluminium

2 × tension lock Z 961/13 can be mounted one on top of the other
L 5000 × W 50 × H 16 mm | 3.76 kg

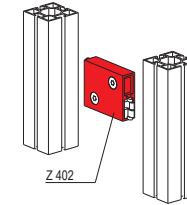
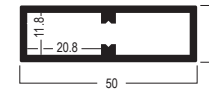

Beam extrusion

groove depth 10 mm
L 5000 × W 50 × H 16 mm

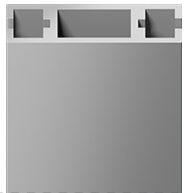

Z 400.01 | .11

aluminium

tension lock Z 961/13 can be mounted, groove depth 10 mm
L 5000 × W 50 × H 16 mm | 4.39 kg

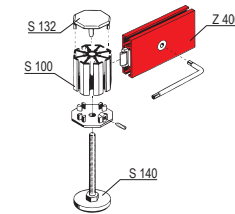
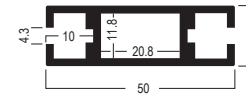

End cap

for Z 400 / Z 402 / Z 460
L 51 × W 16 × H 12 mm



Z 975.35

plastic, light grey

for beam extrusion Z 400 / Z 402 and Z 460, 2 mm thick
L 51 × W 16 × H 12 mm | 0.003 kg

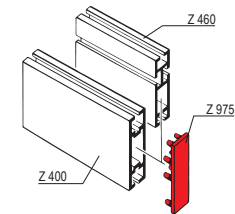
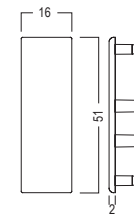

70 x 16 mm

Extrusions in general

Beam extrusion

groove depth 10 mm
L 5000 x W 70 x H 16 mm



Z 110.01 | .11

aluminium

groove depth 10 mm
L 5000 x W 70 x H 16 mm | 5.42 kg

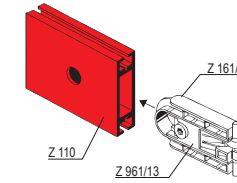

Attention: for mounting tension lock Z 961/13 the adaptor Z 161/A is needed

End cap

for extrusion Z 110 / Z 160
L 70 x W 16 x H 12 mm



Z 175.35

plastic, light grey

for beam extrusion Z 110 / Z 160, 2 mm thick
L 70 x W 16 x H 12 mm | 0.003 kg

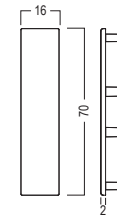

Cleanroom Accessories/Tools

Technics 11/25

Cleanrooms with a system.



➤ Contents

➤ Accessories + Tools

➤ Hammer head screw	110
➤ Connectors	113
➤ Tension locks	115
➤ Clamping elements	117
➤ Tools	118
➤ Glass/Panel retainer extrusions	122
➤ Other Accessories	126
➤ technical information	

➤ Hammer head screw

Accessories + Tools

Hammerhead screw

M8×19 mm
L 19 × W 20 × H 8 mm



M 1472.37

steel

for system groove 4.3 mm
L 19 × W 20 × H 8 mm | 0.024 kg

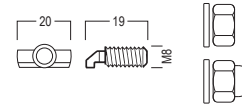

Hammerhead screw

M8×24 mm
L 24 × W 20 × H 8 mm



M 1473.37

steel

for system groove 4.3 mm
L 24 × W 20 × H 8 mm | 0.025 kg

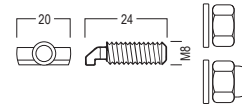

Hammerhead screw

M10×23 mm
L 23 × W 20 × H 10 mm



M 812.37

steel

for system groove 4.3 mm, M10×23 mm
L 23 × W 20 × H 10 mm | 0.041 kg

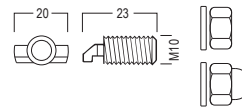

➤ Hammer head screw

Accessories + Tools

Hammerhead screw

combination cross-slot
max. 35 kg



E 203.38

steel

for system groove 4.3 mm, sleeve E 209/Hü, with combination cross recess

L 30 × W 8 × H 8 mm | 0.011 kg

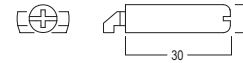

1 maximum load
capacity 35 kg

Hammerhead screw

elongated slot / allen screw
max. 35 kg



E 205.38

steel

for system groove 4.3 mm, sleeve E 204, 10 mm dia., elongated slot and allen screw 4 mm, incl. plastic ring E 201

L 19 × W 15 × H 10 mm | 0.012 kg

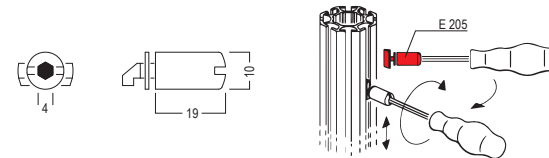

1 maximum load
capacity 35 kg

Hammerhead screw

combination cross-slot
max. 35 kg



E 210.38

steel

for system groove 4.3 mm, sleeve E 210/Hü with combination cross-slot

L 19 × W 15 × H 8 mm | 0.007 kg

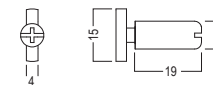

1 maximum load
capacity 35 kg

➤ Hammer head screw

Accessories + Tools

Hammerhead screw

hexagon socket 4 mm
for glass shelf



E 210/M8.30 | .35

steel/plastic

for glass shelf, for system groove 4.3 mm, with threaded sleeve
M8, hexagon socket 4 mm and plastic sleeve

L 16 × W 15 × H 9 mm | 0.006 kg

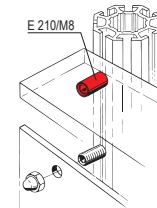
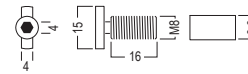

! maximum load
capacity 35 kg

Internal corner connector

22.5° - 337.5°
lock chamber 21 × 12 mm

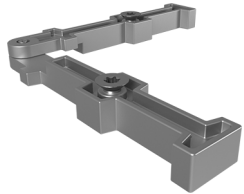

Z 966B/V.00

zinc die cast

for extrusions with lock chamber 21 × 12 mm, adjustable from 22.5° to 337.5°, incl. 2 × countersunk screw E 111 and E 111/20

L 118 × W 85 × H 12 mm | 0.13 kg

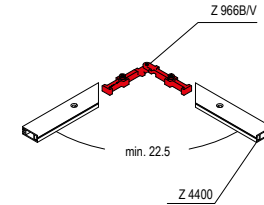
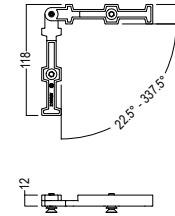

Corner connector

90°
lock chamber 21 × 12 mm

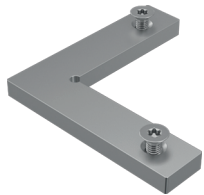

Z 966.00

aluminium

90°, for lock chamber 21 × 12 mm, with 2 × E 111 and E 111/20 countersunk screw

L 90 × W 90 × H 8 mm | 0.082 kg

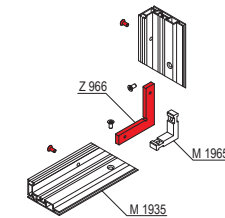
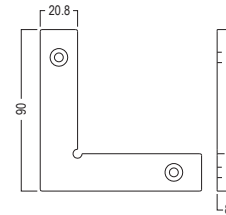

Internal connector

straight
lock chamber 21 × 12 mm

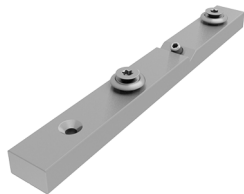

Z 967.00

aluminium

straight, for extrusions with lock chamber 21 × 12 mm and hole 13 mm dia., incl. 1 × set screw Z 967/20 (M6), 2 × hex-star screw E 111/m (M6), 2 × countersunk screw M 1102/20 (M6) and 2 × washer Z 185

L 181 × W 12 × H 21 mm | 0.128 kg

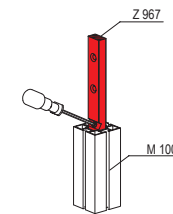
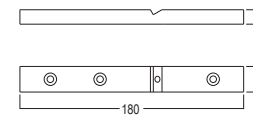

Internal connector

straight
for extrusions 32 mm



S 1155.00

aluminium

straight, for quarter-round, square and triangular extrusions 32 mm, incl. 2 × countersunk screw E111/m (M6)

L 90 × W 14 × H 14 mm | 0.049 kg

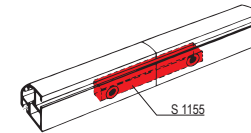
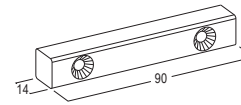

Clip

for extrusions
L 15 × W 14 × H 6 mm



S 1154.44

stainless steel

for connection of 2 aluminium extrusions placed side by side

L 15 × W 14 × H 6 mm | 0.002 kg

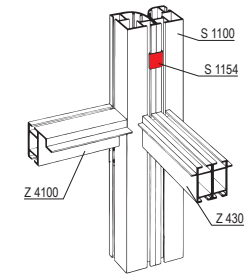
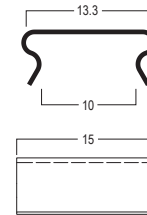

Extrusion connector

for system groove 4.3 mm
L 5000 × W 10 × H 10 mm



E 438.30

plastic, semi-hard

for connection of 2 aluminium extrusions in parallel alignment, suitable for extrusions with a narrow mounting chamber (8.7 mm min.), for system groove 4.3 mm

L 5000 × W 10 × H 10 mm | 0.277 kg

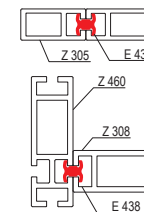
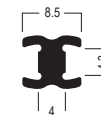

➤ Tension locks

Accessories + Tools

Tension lock

key hole aperture
lock chamber 21 × 12 mm

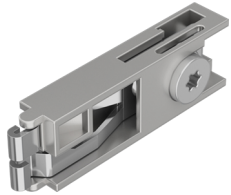

Z 951/13.00

zinc die cast/steel

13 mm, for all beam extrusions with lock chamber 21 × 12 mm and key hole aperture, L 70 × W 21 × H 12 mm

L 70 × W 21 × H 12 mm | 0.052 kg

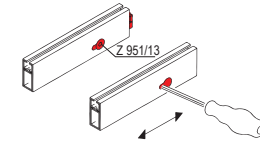
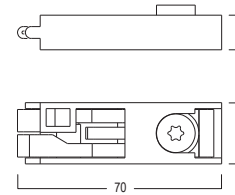

Tension lock

key hole aperture
lock chamber 21 × 12 mm



Z 951/8.00

zinc die cast/steel

8 mm, for all upright-, round- and square extrusions with lock chamber 21 × 12 mm and key hole aperture

L 70 × W 21 × H 12 mm | 0.054 kg

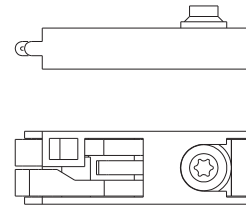

Tension lock

13 mm
L 70 × W 21 × H 13 mm



Z 961/13.00

zinc die cast/steel

13 mm, for all beam extrusions with lock chamber 21 × 12 mm as well as in conjunction with adaptor Z 161/A, for beam extrusions with lock chamber 39 × 12 mm

L 70 × W 21 × H 13 mm | 0.052 kg

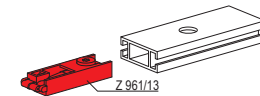
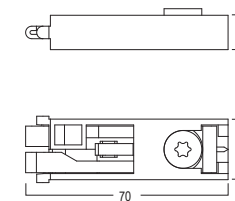

➤ Tension locks

Accessories + Tools

Adaptor

for tension lock Z 961/13
lock chamber 39 × 12 mm

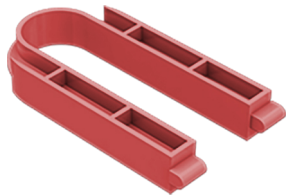

Z 161/A.90

plastic

for mounting tension lock Z 961/13 in beam extrusions with lock chamber 39 × 12 mm

L 76 × W 44 × H 11 mm | 0.009 kg

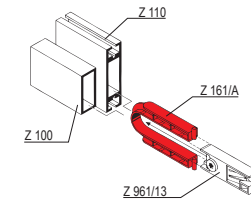
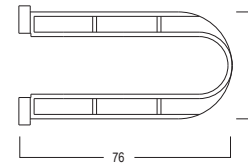

Tension lock

8 mm
L 70 × W 20 × H 12 mm

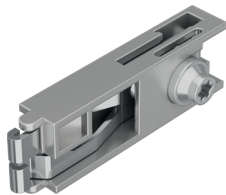

Z 961/8.00

zinc die cast/steel

8 mm, for all beam extrusions with cross- or T-lock chamber 21 × 12 mm

L 70 × W 20 × H 12 mm | 0.054 kg

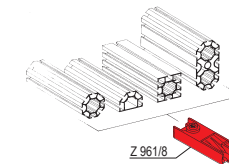
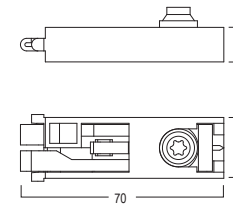

➤ Clamping elements

Accessories + Tools

Clamping element

variable in angle max. 15°
for lock chamber 21 × 12 mm

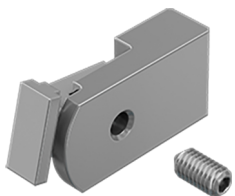

Z 942.37

steel

for all beam extrusions with lock chamber 21 × 12 mm, variable in angle, max. 15°

L 40 × W 11 × H 20 mm | 0.066 kg

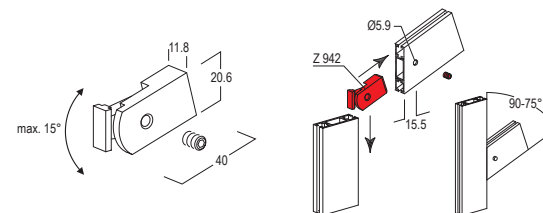

Clamping element

lock chamber 21 × 12 mm
L 50 × W 10 × H 20 mm

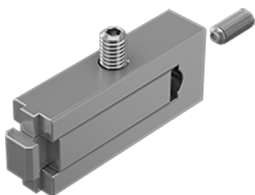

Z 940.37

steel

for all beam extrusions with lock chambers 21 × 12 mm, operating through system groove

L 50 × W 10 × H 20 mm | 0.089 kg

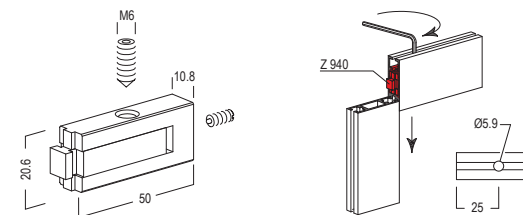

Clamping element

variable in angle max. 15°
for lock chamber 21 × 12 mm

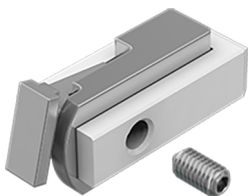

Z 943.37

steel/plastic

for all extrusions with lock chamber 21 × 12 mm, variable in angle, max. 15°

L 46 × W 11 × H 20 mm | 0.073 kg

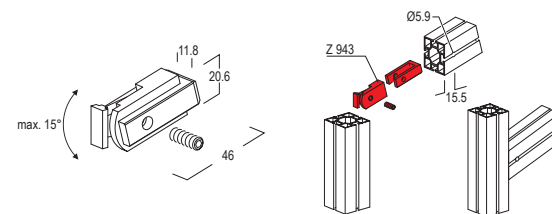

Screwdriver

hex-star T30
L 82 × W 98 × H 20 mm



E 13.90

steel/plastic

hex-star T30
L 82 × W 98 × H 20 mm | 0.059 kg



Screwdriver

hex-star T30
for E 111



E 113.90

steel/plastic

hex-star T30, for opening/closing hex-star screw E 111 e.g. internal corner connector Z 965B / Z 966 / M 1965B
L 232 × W 35 × H 35 mm | 0.122 kg

Hexagon wrench

hex-star T30
L 78 × W 29 × H 6 mm



E 114.90

steel

angle wrench, hex-star T30, for opening/closing hex-star screw E 111 e.g. internal corner connector Z 965B / Z 966 / M 1965
L 78 × W 29 × H 6 mm | 0.02 kg

Ratchet

1/4"



E 115.90

steel

1/4"

L 150 x B 22 x H 18 mm | 0.11 kg

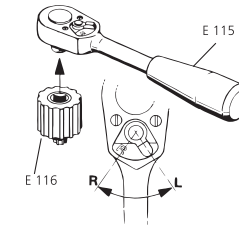

Ratchet accessory

hex-star T30
for E 115 / 1/4"



E 116.90

plastic/steel

for ratchet E 115, hex-star T30, 1/4"

L 24 x W 21 x H 21 mm | 0.019 kg

Ratchet accessory

hex-star T30
for Z 961/8 / 1/4"



E 116/42.90

steel

for tension lock Z 961/8, hex-star T30, 1/4"

L 40 x W 13 x H 13 mm | 0.021 kg

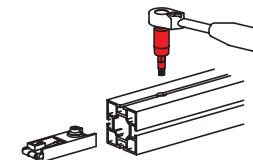

Ratchet accessory

hex-star T30
1/4"



M 945.90

steel

hex-star T30, 1/4", 90 mm long
L 90 mm | 0.024 kg

Screwdriver

hex-star T30
97 mm long



M 951.90

steel/plastic

hex-star T30
L 0 x B 97 x H 0 mm | 0.074 kg

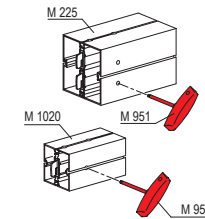
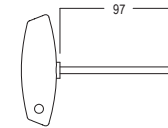

Tool set

set



C 901.90

steel

extension for ratchet, 50 mm long coupling adapter socket
wrench for ratchet bits, hex-star 30, 40 mm long bits, SW 5, 25 mm long hex-star head screwdriver, T30 allen screwdriver, SW 2 magnetic screw holder

L 230 x B 170 x H 45 mm | 0.584 kg

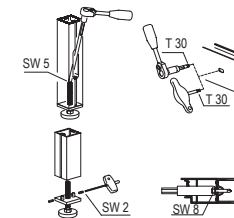

Drilling

8/12 mm drilling
L 135 x W 40 x H 84 mm

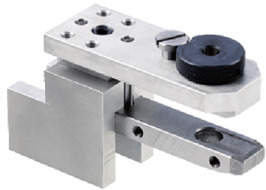

BS 4.90

steel/aluminium body

for 8 mm system hole, for installation of tension lock Z 961/8 in 40 mm and 80 mm square extrusions: WP 860 / M 1025 / M 1091 / M 1018 (see BS 4 ZS 1) included in delivery: drill bush ZBS 100, Ø 8 mm, distance block ZBS 140, for 12 mm countersink - only for internal straight connector Z 967

L 135 x W 40 x H 84 mm | 0.612 kg

1 for 8 mm system hole: twist drill ZBS 112 to be ordered separately
for 12 mm countersink: drill bush ZBS 104 and step drill ZBS 115 to be ordered separately

Drilling

10/13 mm drilling
L 110 x W 40 x H 40 mm



BS 6.90

steel/aluminium body

for 13 mm system hole: for installation of tension lock Z 961/13 in all 16 mm beams, included in delivery: drill bush ZBS 102, 13 mm dia. (large tension lock chamber), spacer pins ZBS 141 for extrusions Z 100 / Z 11, for 10 mm system hole: for installation of tension lock Z 960 in beams with 12 x 21 mm lock chamber

L 110 x W 40 x H 40 mm | 0.435 kg

1 for 13 mm system hole: twist drill ZBS 114 to be ordered separately
for 10 mm system hole: supplementary set ZBS 145 to be ordered separately

Glass panel retainer

for glass 4-8 mm
L 5000 × W 16 × H 16.5 mm

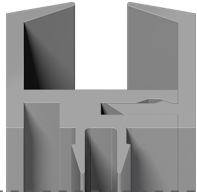

E 420.30 | .33 | .35

plastic

for 4 - 8 mm panels
L 5000 × W 16 × H 16.5 mm | 0.83 kg

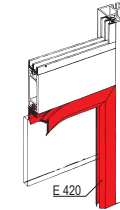
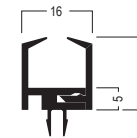

Door stopping extrusion

for hinged doors
for glass and wood

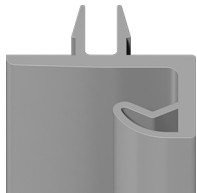

E 430.30 | .35

plastic, semi-hard

with soft rubber lip insert for hinged wooden or glass doors
L 5000 × W 16 × H 10 mm | 0.37 kg

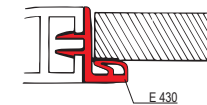
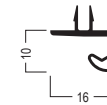

Glass panel retainer

for glass 4-6 mm
L 5000 × W 16 × H 10 mm

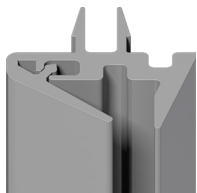

E 424.30 | .35

plastic

for 4 - 6 mm panels
L 5000 × W 16 × H 10 mm | 0.45 kg

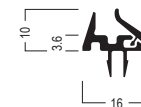

➤ Glass/Panel retainer extrusions

Accessories + Tools

Glass panel retainer

for E 441
L 5000 × W 16 × H 10 mm

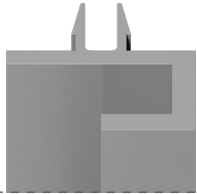

E 440.30 | .35

plastic, semi-hard

also useable as door stopper extrusion in combination with E 441
L 5000 × W 16 × H 10 mm | 0.47 kg

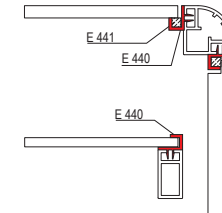
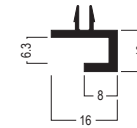

Rubber sponge

50 m long
for E 440



E 441.35

rubber

for use with E 440 only, for glass support and door stop, 50 m long
L 5000 × W 16 × H 10 mm | 1 kg

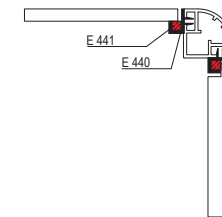

Supporting edge

L 5000 × W 16 × H 8 mm
5000 mm long

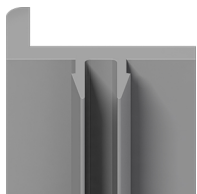

E 442.30 | .35

plastic, semi-hard

L 5000 × W 16 × H 8 mm | 0.4 kg

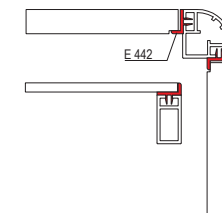
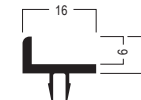

Anti rattle

50 m long
for glass 4 mm



E 445.33

rubber

for mounting glass in the system groove, glass thickness 4 mm,
insertable in extrusions S 1129 / S 1303 / S 1310, 50 m long

L 50000 × W 12 × H 6 mm | 3.5 kg



Anti rattle

25 mm long
for glass 4 mm

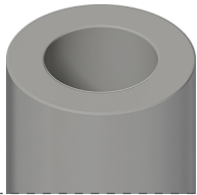

M 1643.51

silicone

round, for mounting glass in the system groove, glass thickness 4 mm,
insertable in extrusions M 1620 / M 1622 / M 1625 / M 1629, 25 m long

L 25000 × W 3 × H 3 mm | 0.4 kg

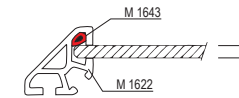

Anti rattle

50 m long
for glass 4 mm

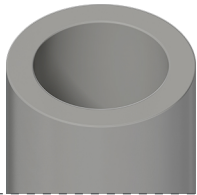

M 1644.51

silicone

round, for mounting glass in the system groove, glass thickness 4 mm,
insertable in extrusion M 1606, 50 m long

L 50000 × W 5 × H 5 mm | 1.177 kg

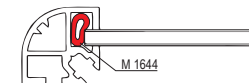

➤ Glass/Panel retainer extrusions

Accessories + Tools

Clip

for E 470/N / E 471/N
L 10 × W 9 × H 7 mm



E 470/C.30

plastic

to put into extrusion E 470/N / E 471/N, recommendation: 4 pieces / running meter for extrusion C 722, 2 pieces / running meter for extrusion W 910

L 10 × W 9 × H 7 mm |

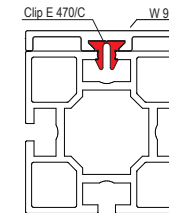
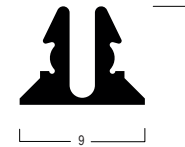

door slide fitting

for E 472
L 5000 × W 32 × H 9 mm

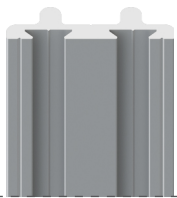

E 471/N.01

aluminium

for runner frame extrusion E 472

L 5000 × W 32 × H 9 mm | 1.61 kg

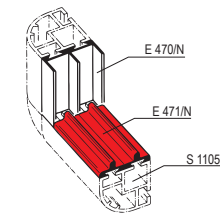
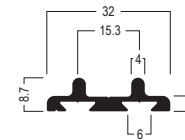

! plastic clip E 470/C to be ordered separately

Runner frame extrusion

Sliding door
for glass 5-6 mm



E 472.01

aluminium

for glass thickness 5 and 6 mm

L 5000 × W 12 × H 28 mm | 1.74 kg

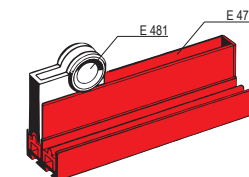

Other Accessories

Accessories + Tools

Self tapping screw

3.5 x 16 mm



C 693-3516.37

steel

3.5 x 16 mm | 0.002 kg



Self tapping screw

4.8 x 38 mm

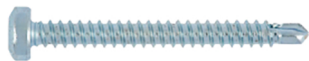

C 693-4838.37

steel

4.8 x 38 mm | 0.002 kg



Self tapping screw

2.9 x 13 mm

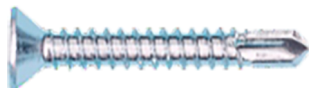

C 695-2913.37

steel

2.9 x 13 mm | 0.002 kg

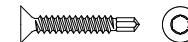

Other Accessories

Accessories + Tools

Self tapping screw

3.5 x 13 mm



C 695-3513.37

steel

3.5 x 13 mm | 0.002 kg



Self tapping screw

3.5 x 16 mm

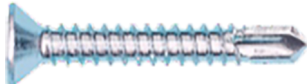

C 695-3516.37

steel

3.5 x 16 mm | 0.002 kg



Self tapping screw

4.8 x 70 mm



C 697-4870.37

steel, zinc plated

drilling screw with hexagonal head with collar

4.8 x 70 mm | 0.004 kg



➤ Other Accessories

Accessories + Tools

Paint stick

RAL 9010 white



C 968.90

none

L 10 x B 25 x H 0 mm | 0.03 kg

Adhesive



C 971.30 | .90

polymer

L 225 x B 50 x H 50 mm | 0.48 kg

Sealant



C 972.30

polymer

L 225 x B 50 x H 50 mm | 0.51 kg

Other Accessories

Accessories + Tools

Threaded plate

female thread M4
with spring



M 1078.37

zinc die cast/steel

for system groove 4.3 mm, with antislipping device, female thread M4, with spring

L 14 × W 10 × H 4 mm | 0.003 kg

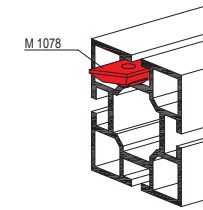

Fixing angle

L 40 × W 30 × H 20 mm



M 1077.37

steel

incl. hammerhead screw M 1470

L 40 × W 30 × H 20 mm | 0.042 kg

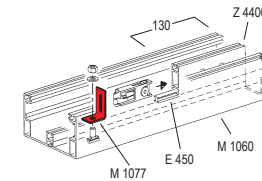
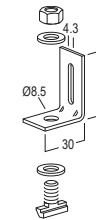

Door hinge

for hinged doors

L 60 × W 50 × H 4 mm

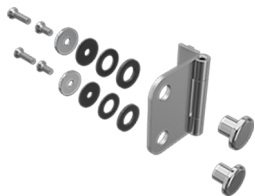

E 290.01

aluminium

for hinged glass and wooden doors 5, 6, 8, 16, 19 mm, incl. mounting parts and distance washers

L 60 × W 50 × H 4 mm | 0.08 kg

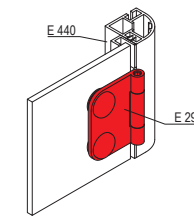
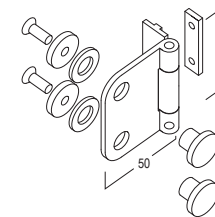

Other Accessories

Accessories + Tools

Cover extrusion

for system groove 4.3 mm
L 5000 × W 6 × H 1 mm

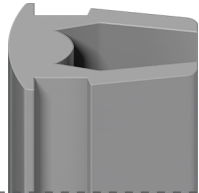

E 455.30 | .33 | .35

plastic, semi-hard

for system groove 4.3 mm
L 5000 × W 6 × H 1 mm | 0.12 kg

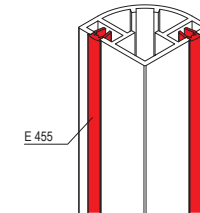
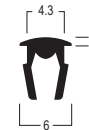

Cable retaining

small
for system groove 4.3 mm



E 460.35

plastic, semi-hard

small, for mounting of cables to system groove
L 5000 × W 16 × H 20 mm | 0.73 kg

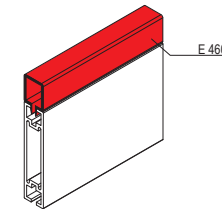

Grab handle



C 940.90

plastic, black

L 203 × B 30 × H 51 mm | 0.5 kg

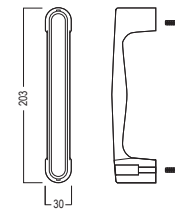

Other Accessories

Accessories + Tools

Panel latches



C 975.37

steel

with hexagon socket 8 mm

L 65 x B 30 x H 58 mm | 0.088 kg

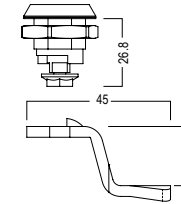

Push to close latch



C 952.39

plastic, chrome

plated pull to open design

L 55 x B 38 x H 0 mm | 0.062 kg

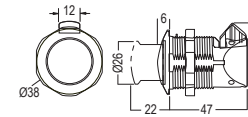

↗ Contents

- ↗ **new family**
- ↗ new subfamily
- ↗ technical information



OCTANORM®-Vertriebs-GmbH

für Bauelemente

Raiffeisenstraße 39

70794 Filderstadt, Germany

T +49 711 77003 0

E info@octanorm.de

Adria

↗ octanormadria.com

Australia

↗ octanorm.com.au

Belgium

↗ octanorm.be

China

↗ octanorm.cn

Emirates

↗ octanormemirates.net

Espana

↗ octanorm.es

France

↗ octanorm.fr

Hellas

↗ octanorm.gr

Italia

↗ octanorm.com

Japan

↗ octanorm.co.jp

México

↗ octanorm.com.mx

Nigeria

↗ it-al.design

Nordic

↗ octanorm.se

North America

↗ octanormna.com

Polska

↗ octanorm.pl

South Africa

↗ octanorm.co.za

UK

↗ octanorm.uk

↗ octanorm.com