

octamax

Double Deck

A space marvel in exhibition systems.

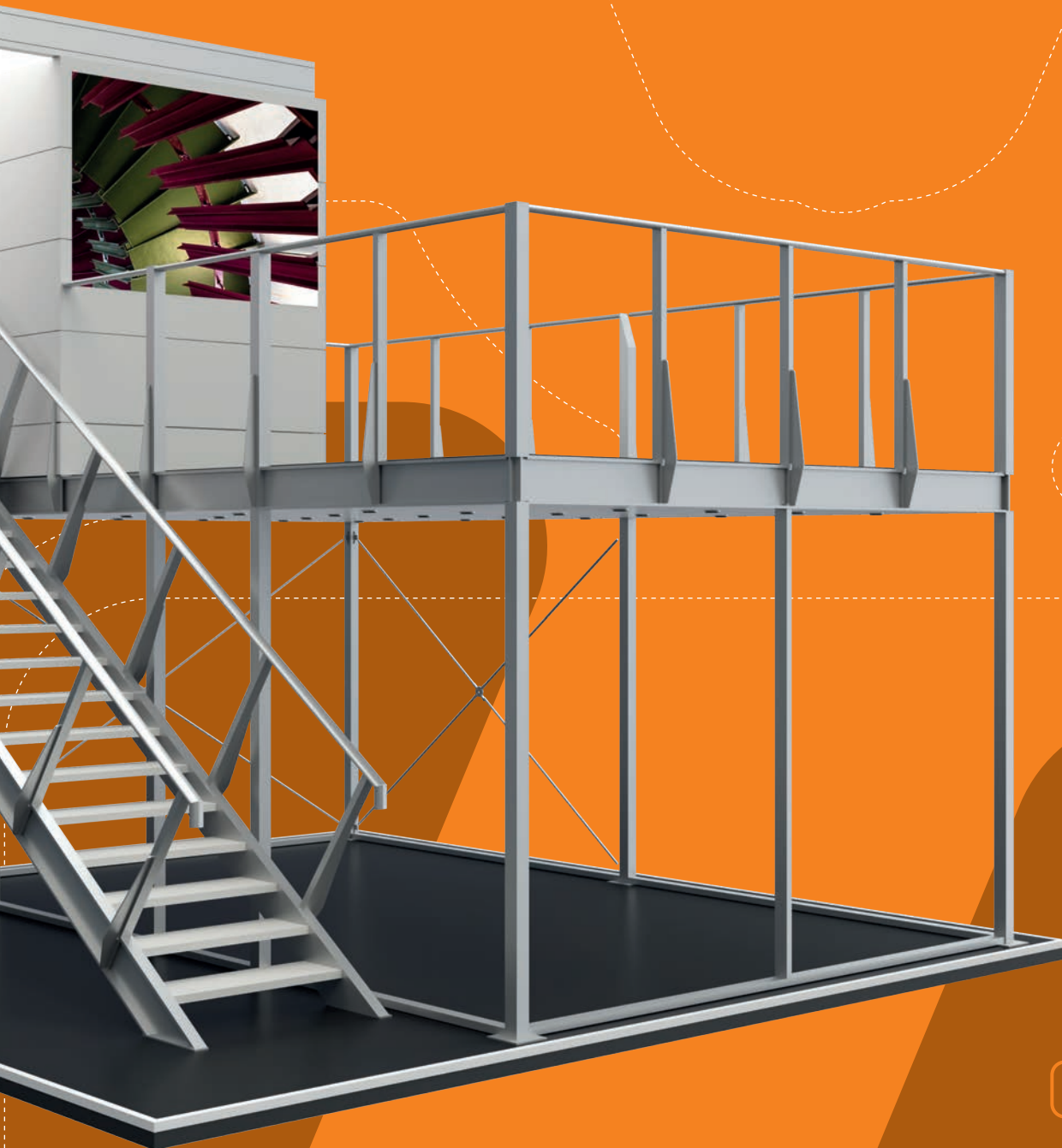



change of per spective.



Space. In many urban areas, it's a sign of deficiency.

Especially in large cities, the demand for available building plots exceeds the supply many times over. In addition to residents and business people, more and more tourists are being attracted to metropolises. The situation is no different at exhibitions, with a limited number of stand spaces with high demand and many interested visitors storming the halls daily. In cities, a simple and space-saving solution has already been found: multi-storey buildings. So why not adopt this concept and expand your own exhibition stand space upwards? So, the question is not: Is it time to change perspective? Rather: Which system offers the right foundation to do so? Here are a few promising answers.



**create
a sen-
sation.**

➤ octamax	06
➤ Technical Features	08
➤ Basic Modules	10
➤ Extension Modules	14
➤ Combinations	16
➤ In Action	24



space-saving. adaptable. efficient.

The multiplier for your floor space.

Stand out from the crowd. Use the available space optimally. **octamax** turns your exhibition booth into an impressive double-decker, which can be assembled quickly and easily thanks to lightweight aluminium extrusions. And all this without any lifting tools. The combination of basic and extension modules allows for numerous variants and can be adapted to a wide variety of situations. **octamax** thus offers you a maximum of flexibility and safety. Are you looking for a system that optimises your booth space? You've found it!







Technical Features

octamax



light weight



reusable



fast installation



without lifting tools



basic modules

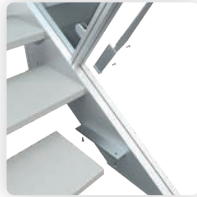

staircase

350
kg/m²

load capacity

> m²

more stand space

More booth space. For your products.

At a height of 2.75 m, additional booth space opens up. Ideal for undisturbed conference rooms or other product presentations with a long-distance impact. More attention. More advertising space. And all this at reduced basic costs.

Versatile and sustainable.

Numerous combinations of basic and extension modules offer the right solution for every project. From small to large, together or separate. The main highlight is that the modules can be rearranged again and again – sustainably.

Double deck without lifting tools? Of course!

Save additional time and costs. The light aluminium material allows for easy and, above all, fast assembly and disassembly. The individual modules can be mounted without any additional lifting equipment.

Handrail. Staircase. Perfectly harmonized.

A system where everything fits together. From hand-rail extrusion to staircase and platform. If that is not enough, **octamax** can also be combined with **maxima** and all other **octanorm** systems. More individuality. More attraction!

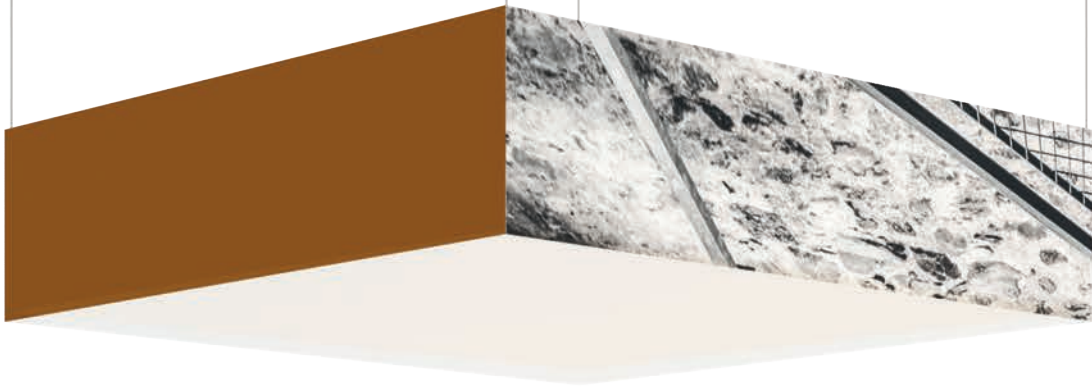

octamax: Basic Modules

exquisite aluminium surface / with system groove / quick assembly and disassembly / extremely lightweight / with staircase solution / modular design / extremely space-saving

Basic module 3 × 4 m



DFL 344L.90

Aluminium | 1 × basic module including railing supports for parapet height of 1150 mm, single flight of stairs 35° left, 14 × step DFL 532

not included: walkable floor disc (2 × 19 mm) and parapet infills

another version:
DFL 344R: staircase on the right

775.97 kg | W 4186 × H 3936 × D 7168 mm



Basic module with staircase landing 3 × 4 m



DFL 344PL.90

Aluminium | 1 × basic module including staircase landing, railing supports for parapet height of 1150 mm, single flight of stairs 35° left, 14 × step DFL 532

not included: walkable floor disc (2 × 19 mm) and parapet infills

another version:
DFL 344PR: staircase on the right

904.52 kg | W 5671 × H 3936 × D 5478 mm

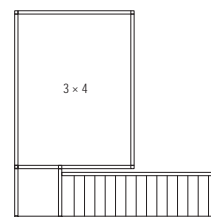

Basic module 4 × 4 m



DFL 444L.90

Aluminium | 1 × basic module including railing supports for parapet height of 1150 mm, single flight of stairs 35° left, 14 × step DFL 532

not included: walkable floor disc (2 × 19 mm) and parapet infills

another version:
DFL 444R: staircase on the right

839.63 kg | W 4186 × H 3936 × D 8158 mm

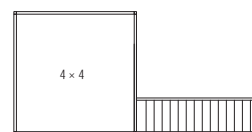

Basic module with staircase landing 4 × 4 m



DFL 344PL.90

Aluminium | 1 × basic module including staircase landing, railing supports for parapet height of 1150 mm, single flight of stairs 35° left, 14 × step DFL 532

not included: walkable floor disc (2 × 19 mm) and parapet infills

another version:
DFL 444PR: staircase on the right

968.13 kg | W 5671 × H 3936 × D 5478 mm

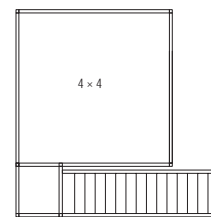

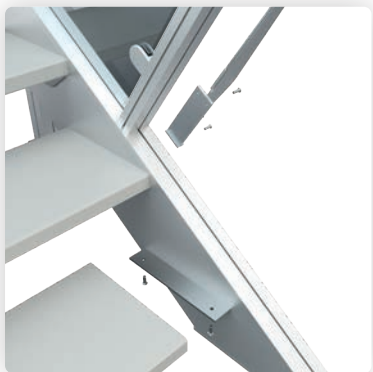
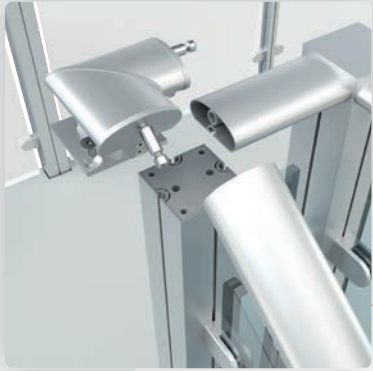

Basic Modules

octamax

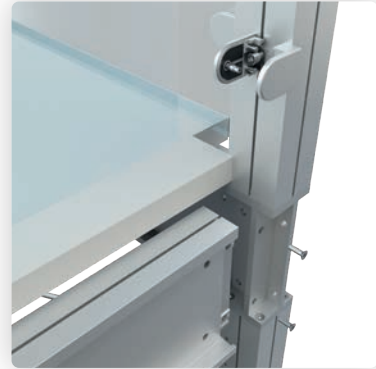
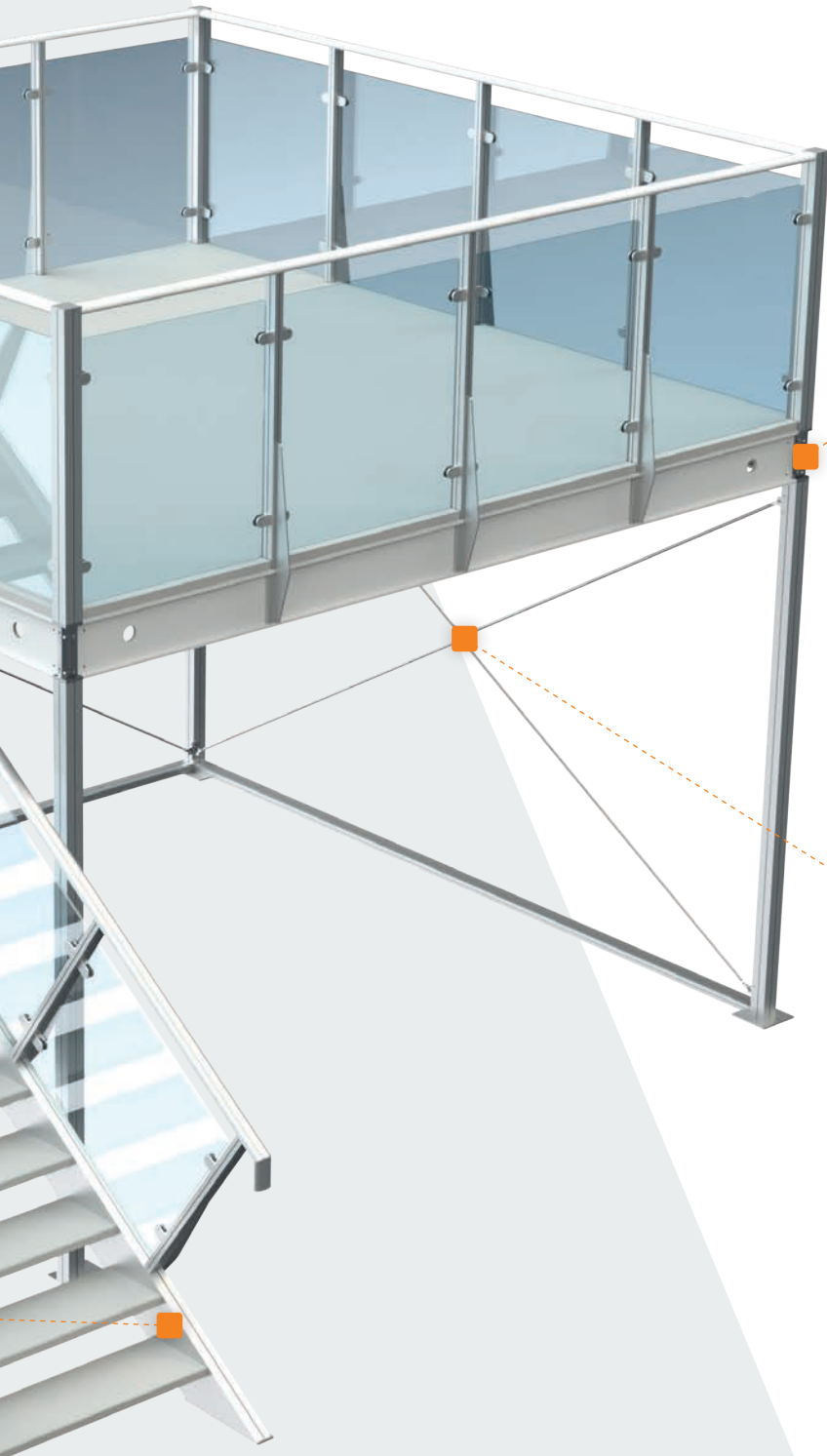

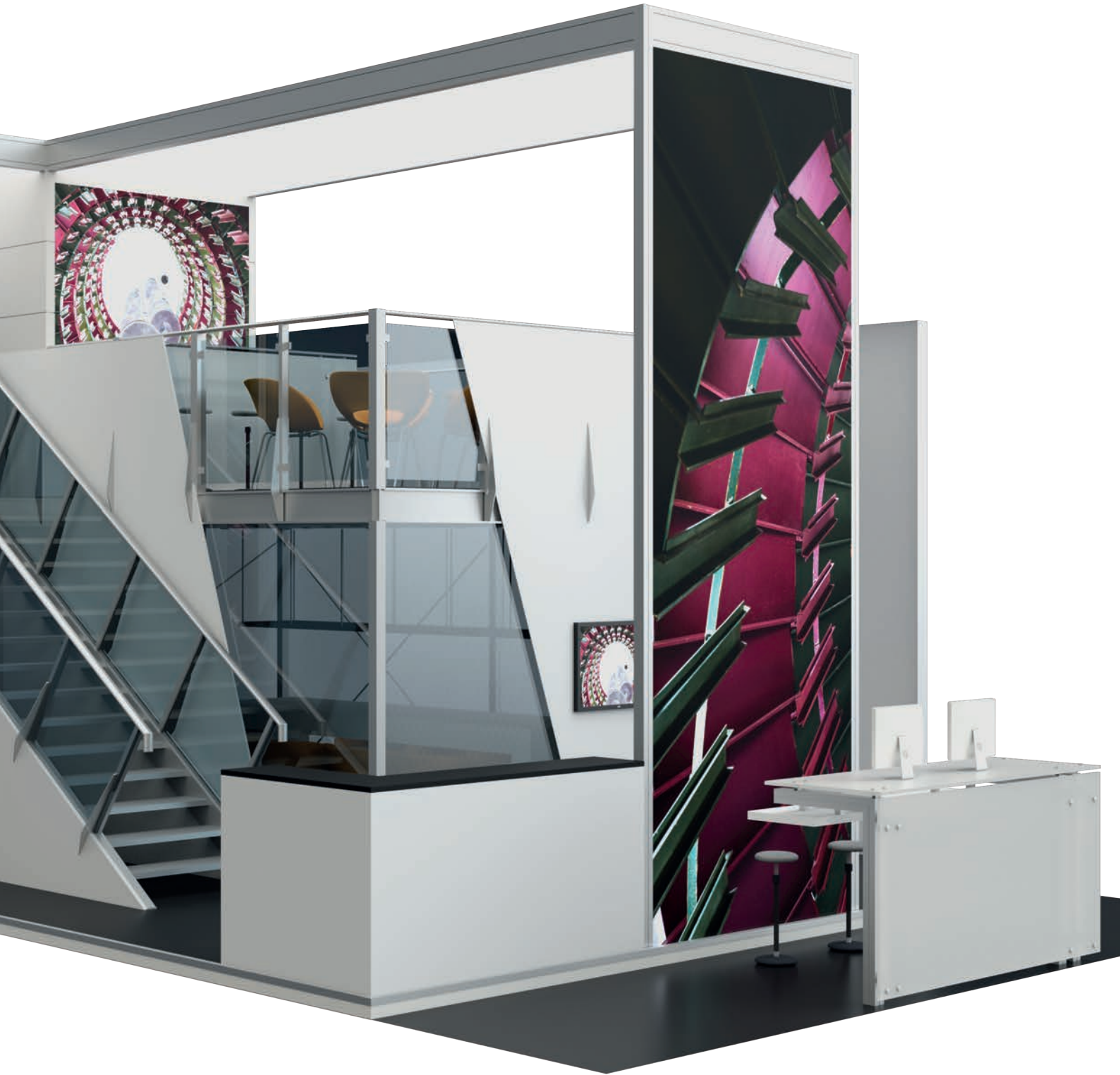

↗ Extension Modules

octamax

octamax: Extension modules

exquisite aluminium surface / with system groove / quick assembly and disassembly / extremely lightweight / with staircase solution / modular design / extremely space-saving

Extension module 3 × 4 m



DFL 34EM1.90

Aluminium | 1 × extension module including railing supports for parapet height of 1150 mm

not included: walkable floor disc (2 × 19 mm) and parapet infills

294.32 kg | W 4033 × H 3936 × D 3196 mm



! Proof of stability is required for all extension modules

Extension module 3 × 4 m



DFL 34EM2.90

Aluminium | 1 × extension module including railing supports for parapet height of 1150 mm

not included: walkable floor disc (2 × 19 mm) and parapet infills

259.66 kg | W 4186 × H 3936 × D 3034 mm

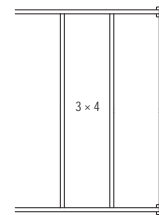

Extension module 4 × 4 m



DFL 44EM1.90

Aluminium | 1 × extension module including railing supports for parapet height of 1150 mm

not included: walkable floor disc (2 × 19 mm) and parapet infills

320.56 kg | W 4186 × H 3936 × D 4033 mm

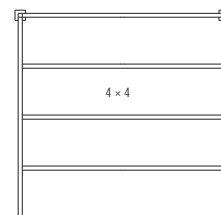



octamax: Combinations

Basic module 3 × 4 m in combination with extension module 3 × 4 m

DFL 344L*
W 7168 × H 3936 × D 4186 mm

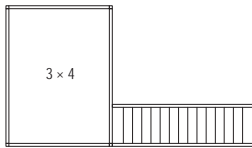

DFL 384L
W 7168 × H 3936 × D 8146 mm

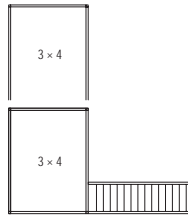

DFL 644L
W 10138 × H 3936 × D 4186 mm

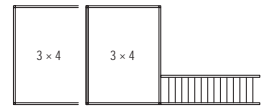

i
without
staircase
landing

DFL 344R*
W 7168 × H 3936 × D 4186 mm

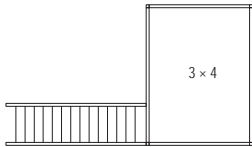

DFL 384R
W 7168 × H 3936 × D 8146 mm

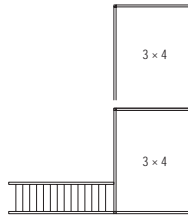

DFL 644R
W 10138 × H 3936 × D 4186 mm

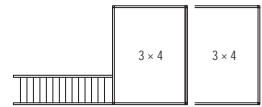

DFL 343L*
W 3196 × H 3936 × D 8158 mm

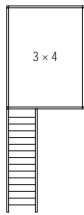

DFL 383L
W 3196 × H 3936 × D 12119 mm

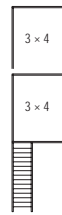

DFL 646L
W 6166 × H 3936 × D 8158 mm

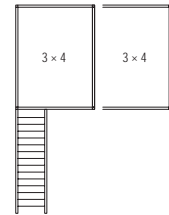

DFL 343R*
W 3196 × H 3936 × D 8158 mm

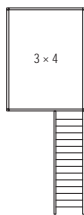

DFL 383R
W 3196 × H 3936 × D 12119 mm

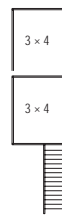

DFL 646R
W 6166 × H 3936 × D 8158 mm

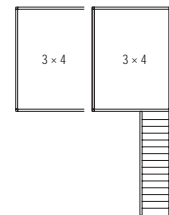

Combinations

octamax

DFL 344PL*

W 5478 x H 3936 x D 5671 mm

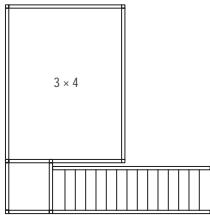

DFL 388PL

W 5478 x H 3936 x D 9631 mm

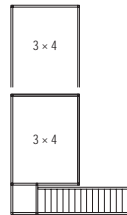

DFL 644PL

W 6166 x H 3936 x D 5671 mm



i with staircase landing

DFL 344PR*

W 5478 x H 3936 x D 5671 mm

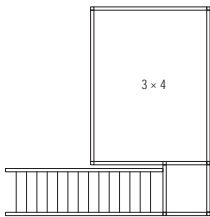

DFL 388PR

W 5478 x H 3936 x D 9631 mm



DFL 644PR

W 6166 x H 3936 x D 5671 mm

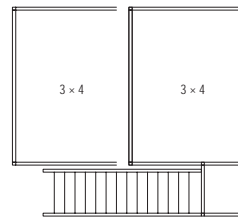

DFL 343PL*

W 5466 x H 3936 x D 4667 mm

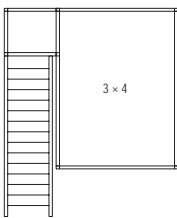

DFL 383PL

W 4681 x H 3936 x D 8146 mm



DFL 646PL

W 7651 x H 3936 x D 5478 mm

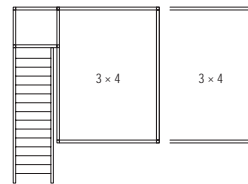

DFL 343PR*

W 5466 x H 3936 x D 4667 mm

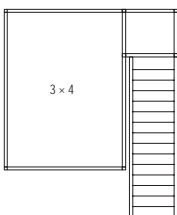

DFL 383PR

W 4681 x H 3936 x D 8146 mm



DFL 646PR

W 7651 x H 3936 x D 5478 mm

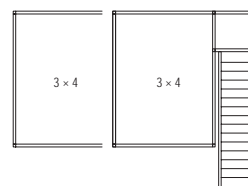



DFL 383PLM
W 4681 × H 3936 × D 8146 mm

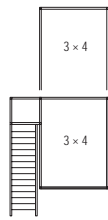

DFL 383PRM
W 4681 × H 3936 × D 8146 mm

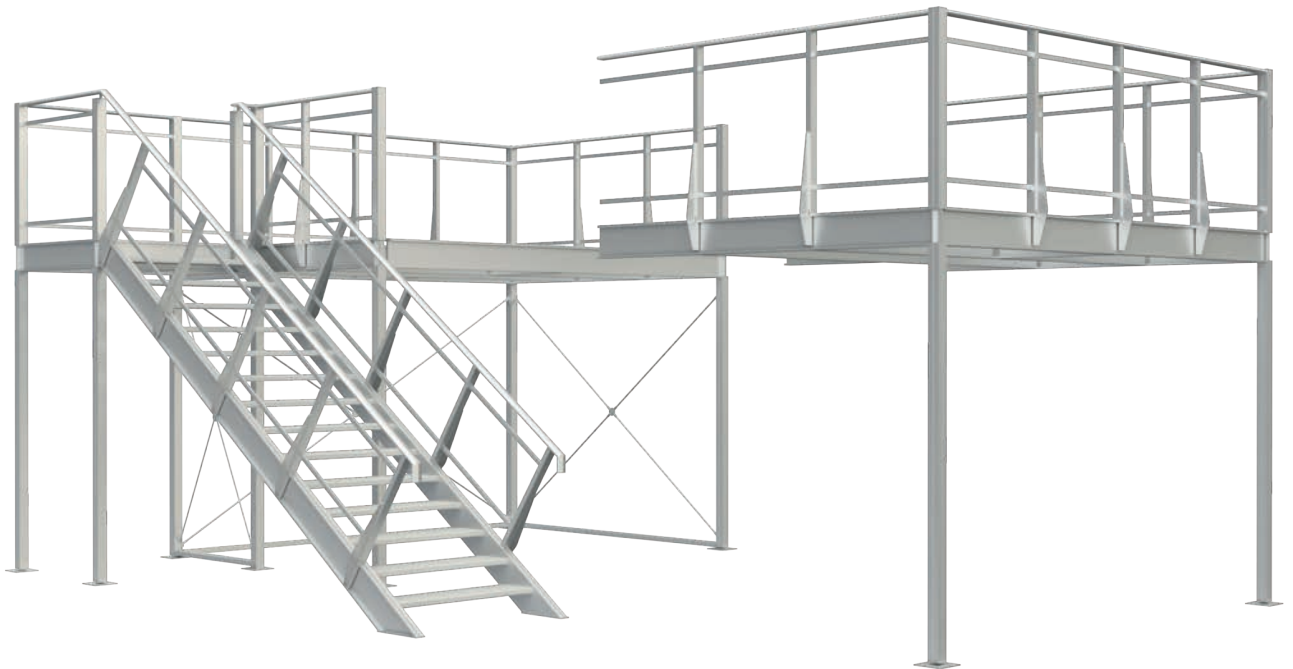

octamax: Combinations

Basic module 4 × 4 m in combination with extension module 3 × 4 m

DFL 474L
W 11128 × H 3936 × D 4186 mm

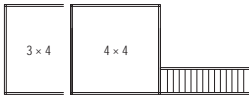

DFL 477L
W 7156 × H 3936 × D 8158 mm

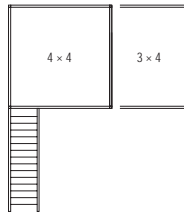

DFL 474LM
W 7156 × H 3936 × D 8158 mm

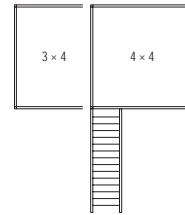

i without staircase landing

DFL 474R
W 11128 × H 3936 × D 4186 mm



DFL 477R
W 7156 × H 3936 × D 8158 mm

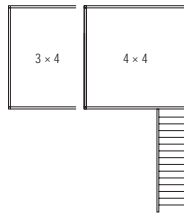

DFL 474RM
W 7156 × H 3936 × D 8158 mm

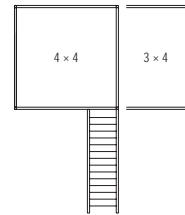

DFL 474PL
W 7156 × H 3936 × D 5671 mm

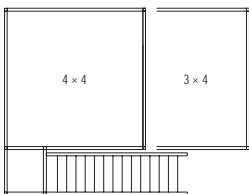

DFL 474PLM
W 8488 × H 3936 × D 5671 mm

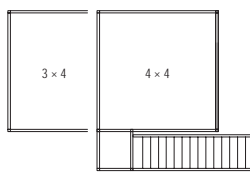

DFL 477PL
W 8641 × H 3936 × D 5478 mm

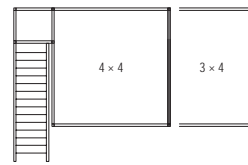

i with staircase landing

DFL 474PR
W 7156 × H 3936 × D 5671 mm

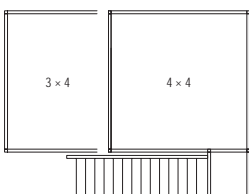

DFL 474PRM
W 8488 × H 3936 × D 5671 mm

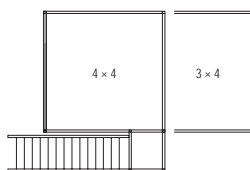

DFL 477PR
W 8641 × H 3936 × D 5478 mm

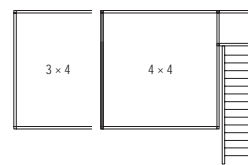



octamax: Combinations

Basic module 3 × 4 m in combination with extension module 4 × 4 m

DFL 744L
W 11128 × H 3936 × D 4186 mm



DFL 747L
W 7156 × H 3936 × D 8158 mm

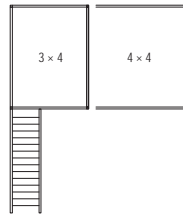

DFL 743L
W 7156 × H 3936 × D 8158 mm

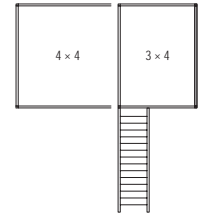

i
without
staircase
landing

DFL 744R
W 11128 × H 3936 × D 4186 mm



DFL 747R
W 7156 × H 3936 × D 8158 mm

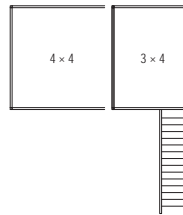

DFL 743R
W 7156 × H 3936 × D 8158 mm

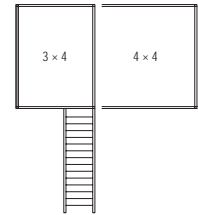

i
with
staircase
landing

DFL 744PL
W 7156 × H 3936 × D 5671 mm

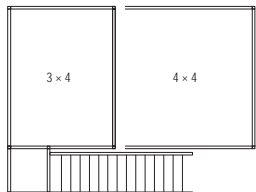

DFL 744PLM
W 8488 × H 3936 × D 5671 mm



DFL 747PL
W 8641 × H 3936 × D 5478 mm

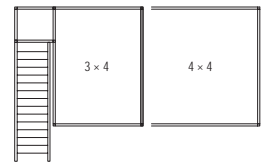

DFL 744PR
W 7156 × H 3936 × D 5671 mm

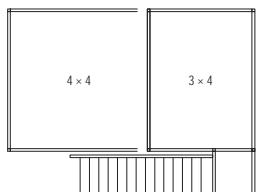

DFL 744PRM
W 8488 × H 3936 × D 5671 mm



DFL 747PR
W 8641 × H 3936 × D 5478 mm

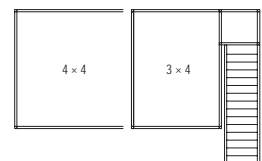

octamax: Combinations

Basic module 4 × 4 m in combination with extension module 4 × 4 m

DFL 444L*
W 8158 × H 3936 × D 4186 mm

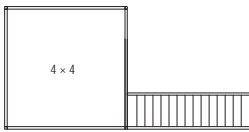

DFL 844L
W 4186 × H 3936 × D 12118 mm



DFL 848L
W 8146 × H 3936 × D 8158 mm

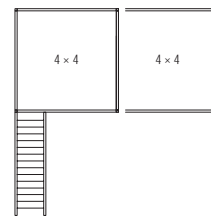

i without staircase landing

DFL 444R*
W 8158 × H 3936 × D 4186 mm



DFL 844R
W 4186 × H 3936 × D 12118 mm



DFL 848R
W 8146 × H 3936 × D 8158 mm

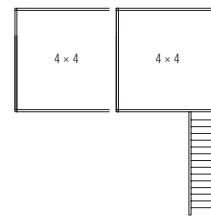

DFL 444PL*
W 5478 × H 3936 × D 5671 mm

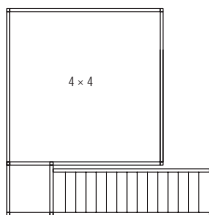

DFL 844PL
W 5671 × H 3936 × D 9245 mm

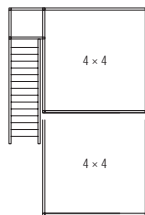

DFL 848PL
W 9631 × H 3936 × D 5478 mm

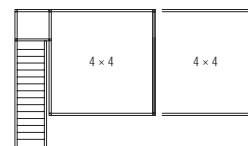

i with staircase landing

DFL 444PR*
W 5478 × H 3936 × D 5671 mm

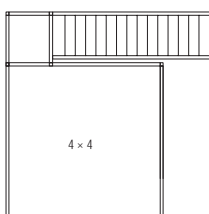

DFL 844PR
W 5671 × H 3936 × D 9245 mm

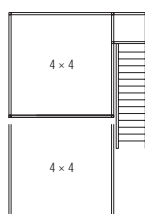

DFL 848PR
W 9631 × H 3936 × D 5478 mm

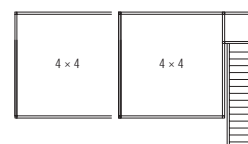



↗ Combinations

octamax





➤ In Action

octamax





exhibition systems
project solutions
cleanroom solutions

octanorm 

OCTANORM®-Vertriebs-GmbH

für Bauelemente
Raiffeisenstraße 39
70794 Filderstadt, Germany

T +49 711 77003-0

E info@octanorm.de

Adria

octanormadria.com

Australia

octanorm.com.au

Belgium

octanorm.be

China

octanorm.cn

Emirates

octanormemirates.net

España

octanorm.es

France

octanorm.fr

Hellas

octanorm.gr

Italia

octanorm.it

Japan

octanorm.co.jp

México

octanorm.com.mx

Nigeria

it-al.design

Nordic

octanorm.se

North America

octanormna.com

Polska

octanorm.pl

South Africa

octanorm.co.za

UK

octanorm.co.uk

octanorm.com