

# Tension Fabric Extrusions

Tension fabric frames with a system.

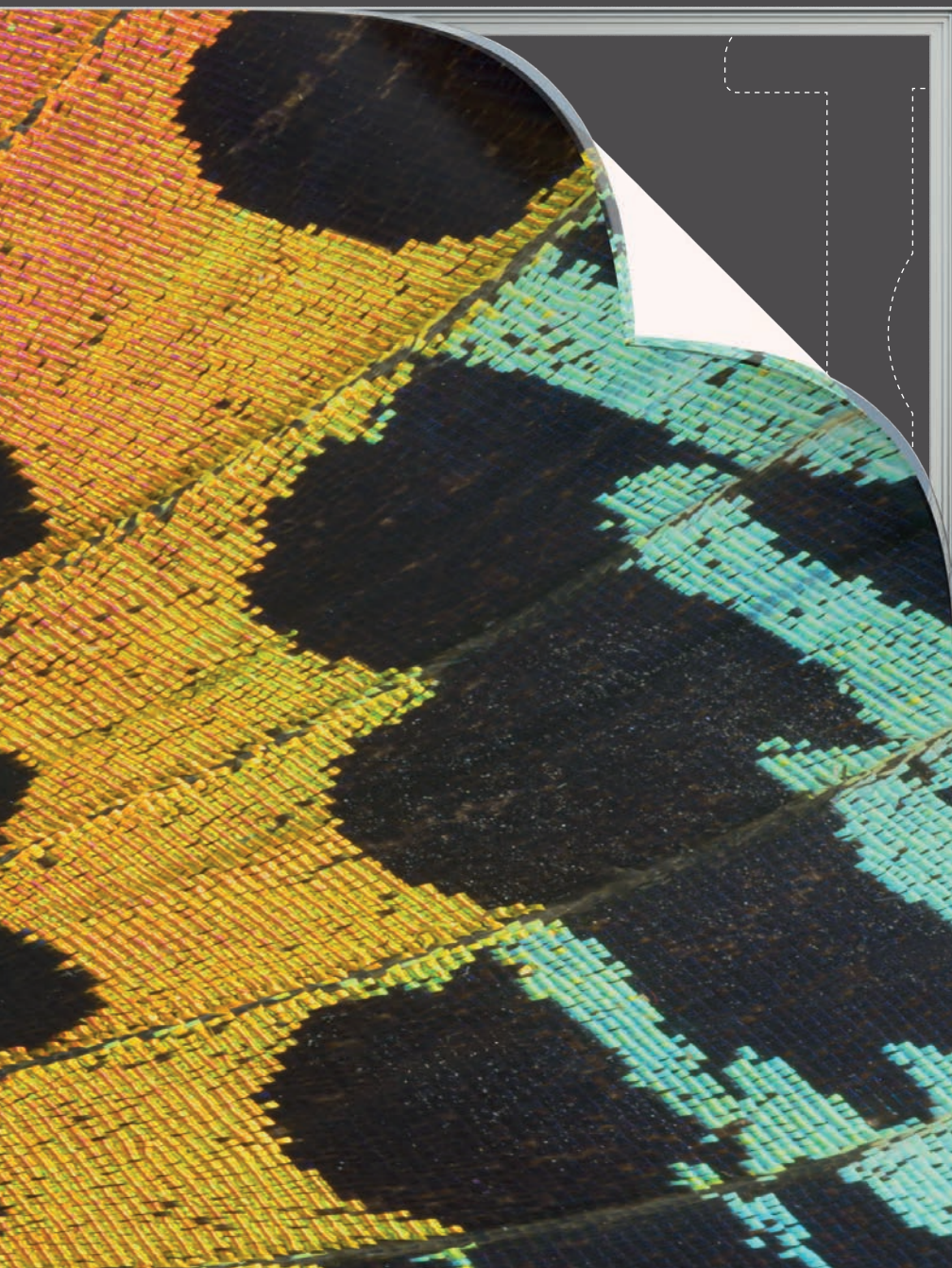



# thrilling.

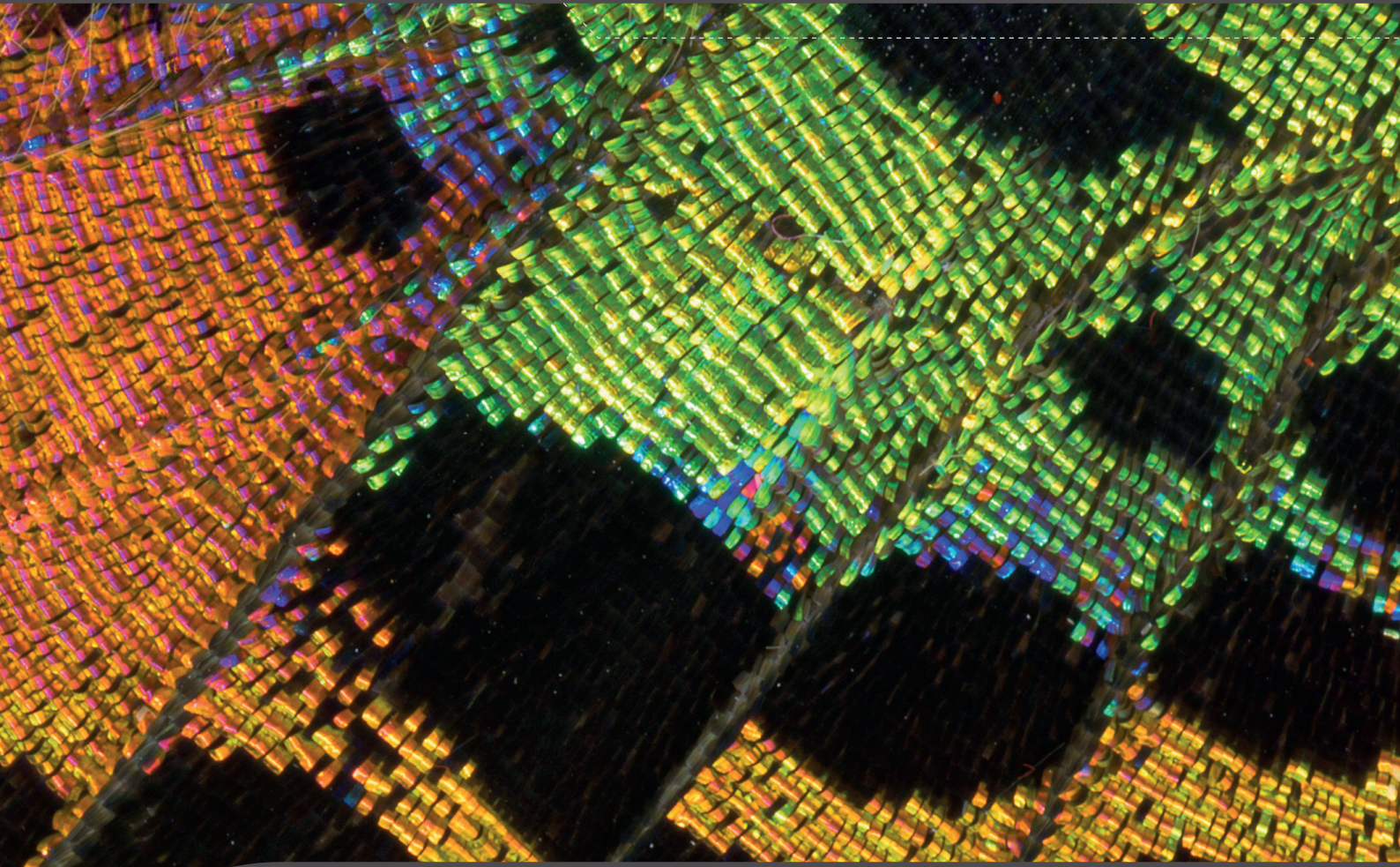

**Transformation. Create tension. Arouse curiosity.**

The caterpillar pupates and turns into a butterfly. The octopus changes its color to match the background, and the frog, initially living under water, changes its habitat to land. Unique and fascinating processes. Hence, the question is not: transformation or not? But: how can we use it to present products and companies, create tension and reinvent whole rooms? Here are some thrilling answers.



# trans form ation.

<b>➤ Technical Features</b>	<b>06</b>
➤ Wall solutions	08
➤ Wall and ceiling solutions	14
➤ Light frames	16
➤ Free-standing displays	20
➤ Cubes	24
➤ Adaption extrusions	26
➤ In Action	32



## ➤ Technical Features

### Tension Fabric Extrusions

**16 - 120  
mm**

**different extrusion  
depths**



**various frame colors**

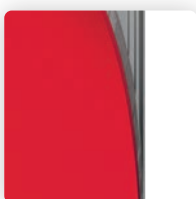

**2 mm extrusion edge**



**illumination optional**



**silicone edge  
technology**

#### **Different extrusion depths. For all requirements.**

Our tension fabric frames are available with extrusion depths from 16–120 mm. They can be powder-coated in various RAL colors on request – for every spatial requirement and color coordination.

#### **Simple and flexible. With silicone edges.**

The fabric is fixed into the fabric groove with a silicone edge. This allows for a quick and tool-less exchange of any graphic.

#### **Extrusion edges. Almost invisible.**

Our anodized aluminium frames take a subsidiary role and put your product into the spotlight. There is merely a 2 mm extrusion edge framing the fabric.

#### **A shining example. Also in quality.**

Our high quality light frames are fitted with Power LEDs, which ensure a brilliant, radiating light. Additional advantages: their longevity and energy efficiency.



## Wall solutions

elegant aluminium surface / without system groove / different extrusion depths / silicone edge technology / single-sided

### Tension fabric extr. 16 mm width



#### M 1607.01

**Aluminium** | for small formats up to DIN A1 (594 x 841 mm), for mounting fabric with silicone edge M 1313

L 6000 x W 16 x H 24 mm  
| 1.91 kg

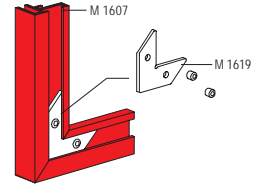
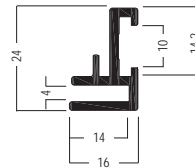

### Tension fabric extr. 20 mm width



#### M 1601.01

**Aluminium** | for small formats up to DIN A1 (594 x 841 mm), for mounting fabric with silicone edge M 1313

L 6000 x W 16 x H 20 mm  
| 2.16 kg

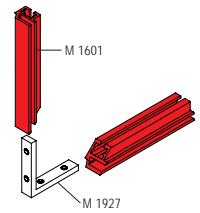
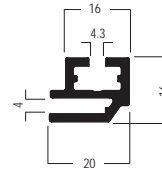

### Tension fabric extr. 28 mm width



#### M 1614.00

**Aluminium** | for fixing to wooden elements, for mounting fabric with silicone edge M 1313, delivery condition unpunched

L 6000 x W 28 x H 10 mm  
| 1.54 kg

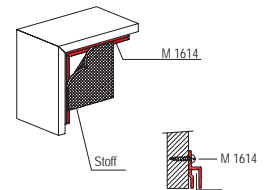
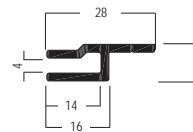

### Tension fabric extr. 60 mm width

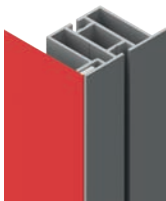

#### W 730.01

**Aluminium** | for mounting fabric with silicone edge M 1313

L 6000 x B 60 x H 40 mm  
| 8.66 kg

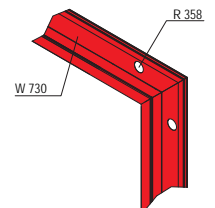
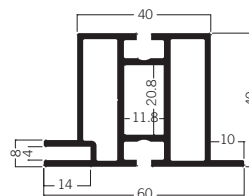

# Wall solutions

## single-sided

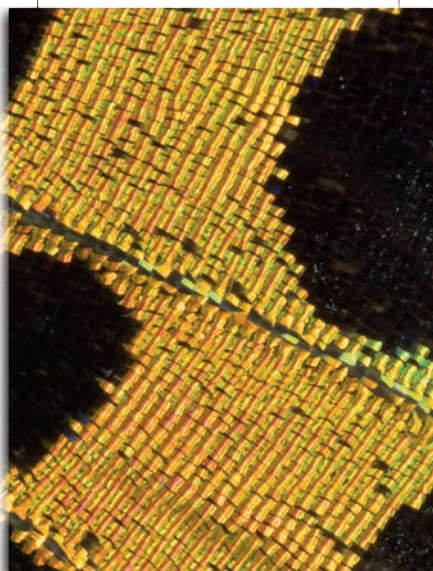

### Accessories



**M 1313 silicone edge**  
14 × 3 mm, roll with 100 m



**M 1927 internal corner connector**  
for M 1601



**M 1619 corner connector**  
for M 1607



**M 1335 internal corner connector**  
to connect M 1302 or M 1309



**M 1433 wall retainer**  
with M4 clamp screw, for M 1302



**M 1434 wall retainer**  
with M4 clamp screw, for M 1309

### Tension fabric extr. 40 mm width



#### M 1302.01

**Aluminium** | to fix fabric panels in connection with silicone edge M 1313, bracing available

L 6000 × W 40 × H 28 mm  
1 3.49 kg

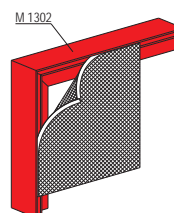
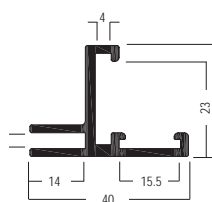

### Tension fabric extr. 22,5 mm width



#### M 1309.01

**Aluminium** | for wall fixing for small formats up to DIN A0 (841 × 1189 mm), for mounting fabric with silicone edge M 1313

L 6000 × W 22.5 × H 27 mm  
1 2.53 kg

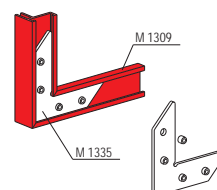
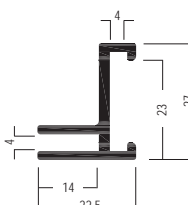

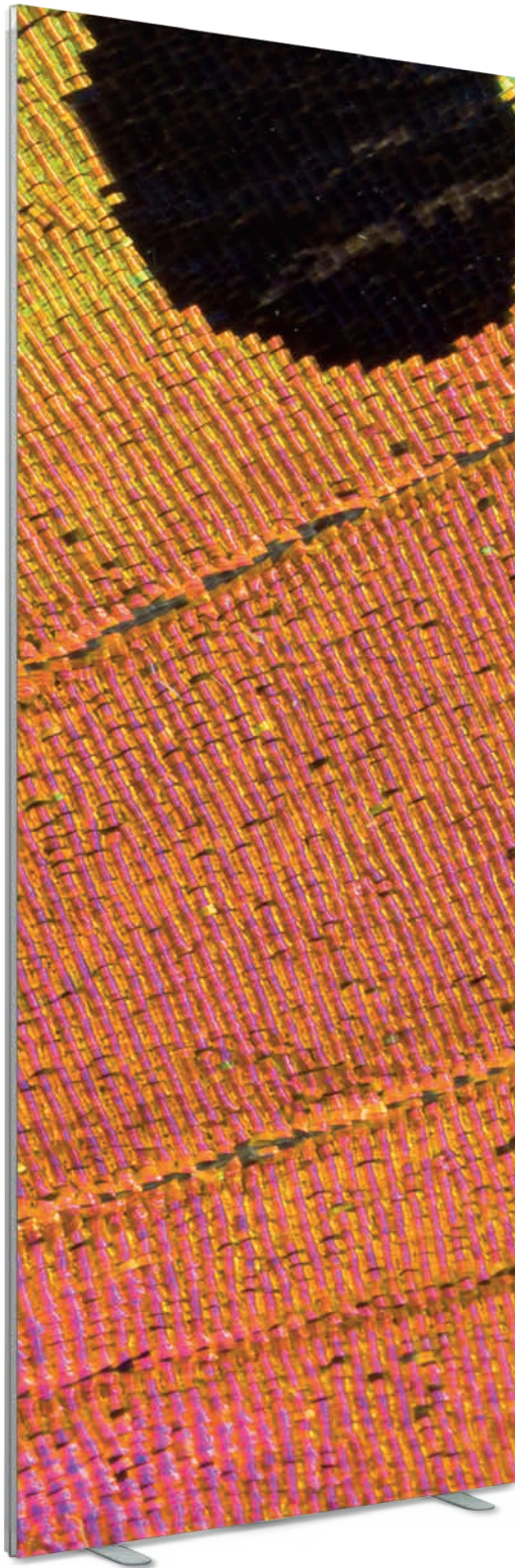

# Wall solutions

## double-sided

### Wall solutions: octawall 40

elegant aluminium surface / with system groove / silicone edge technology / double-sided

#### Tension fabric extr. 40 mm width

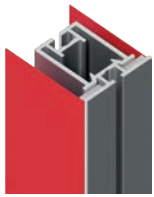

#### W 906.01

**Aluminium** | for double sided fabric (in combination with silicone edge M 1313) or panel

L 6000 × W 40 × H 40 mm  
I 6.35 kg

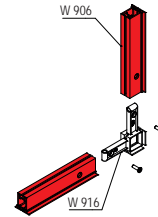
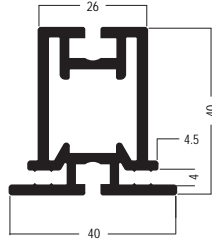

#### Corner extrusion 90° 40 mm width

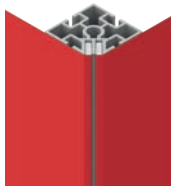

#### S 382.01

**Aluminium** | fabric can be mounted over the extrusion right to the edge

L 6000 × W 40 × H 40mm  
I 6.91 kg

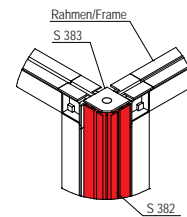
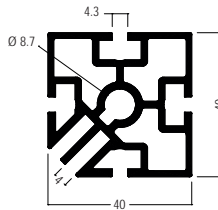

### Accessories



**M 1313** **silicone edge**  
14 × 3 mm, roll with 100 m



**W 916** **corner connector**  
for W 906



**Z 965B** **corner connector**  
for W 906



**Z 990** **corner connector**  
for W 906



**C 440/F** **adjustable foot**  
for frames made of WP 906 in connection with W 916 / W 990



**S 383** **end cap**  
for corner extrusion S 382



**M 260** **corner extrusion, round**  
for extrusion width 16, 40, 80, 120 mm, fabric can be stretched over the extrusion



**M 261** **end plate**  
for corner extrusion M 260



**M 271** **end plate**  
for corner extrusion M 260



## Wall solutions: octawall pro

elegant aluminium surface / with system groove / silicone edge technology / double-sided

### Tension fabric extr. 80 mm width

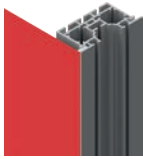

#### WP 860.01

**Aluminium** | for double sided fabric (in combination with silicone edge M 1313)

L 6000 × W 80 × H 40 mm  
| 11.92 kg

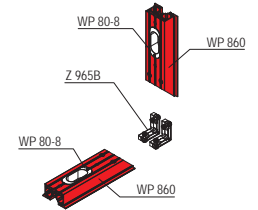
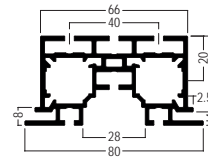

### Corner extrusion 90° 80 mm width



#### WP 850.01

**Aluminium** | fabric can be mounted over the extrusion right to the edge

L 6000 × W 80 × H 80 mm  
| 16.48 kg

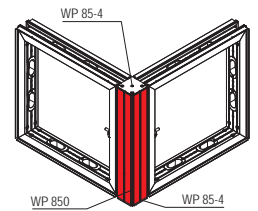
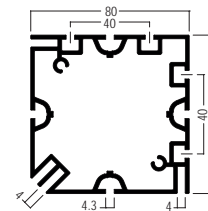

### Corner extrusion 135° 80 mm width



#### WP 840.01

**Aluminium** | fabric can be mounted over the extrusion right to the edge

L 6000 × W 80 × H 40 mm  
| 11.28 kg

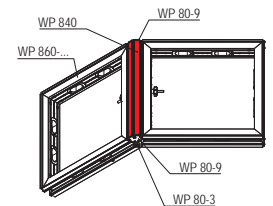
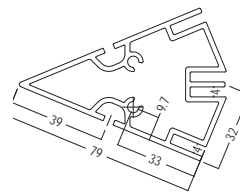

### T-extrusion, 90° connection

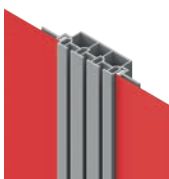

#### WP 820.01

**Aluminium** | for mounting frames at 90° at any position, for mounting fabric (with silicone edge M 1313)

L 6000 × W 122 × H 28 mm  
| 11.7 kg

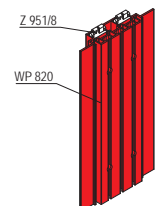
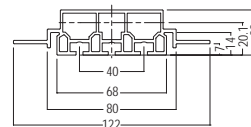





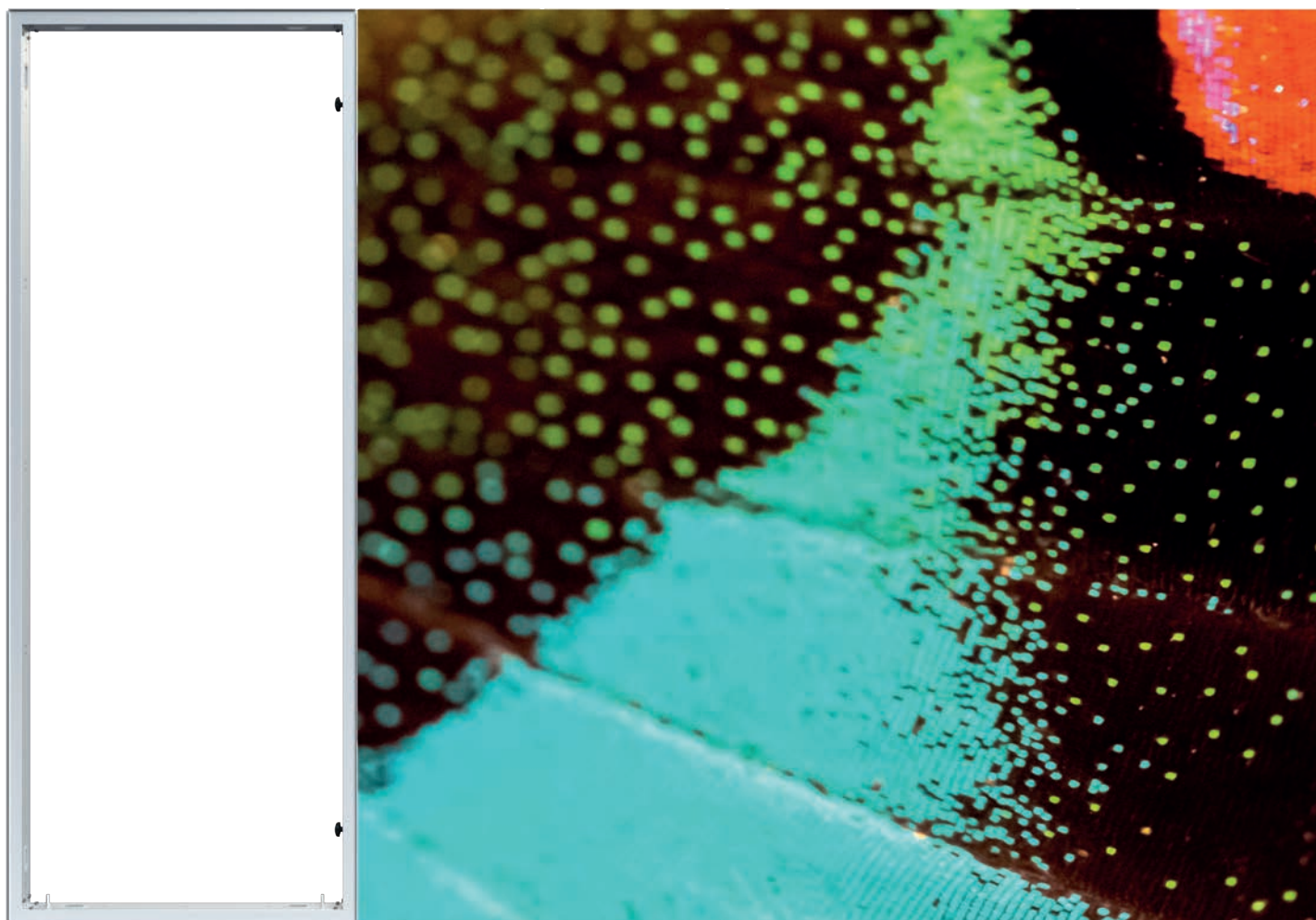





## Wall solutions

double-sided



### Accessories

	<b>M 1313</b> <b>silicone edge</b> 14 x 3 mm, roll with 100 m		<b>WP 85-4</b> <b>end plate</b> for corner extrusion WP 850
	<b>Z 965B</b> <b>corner connector</b> for WP 860		<b>WP 80-9</b> <b>end plate</b> for corner extrusion WP 840
	<b>WP 80-1</b> <b>quick connector set</b> for frames made of WP 860		<b>M 260</b> <b>corner extrusion, round</b> for extrusion width 16, 40, 80, 120 mm, fabric can be stretched over the extrusion
	<b>WP 80-2</b> <b>quick connector set</b> for frames made of WP 860 with corner extrusion WP 850/WP 840		<b>M 261</b> <b>end plate</b> for corner extrusion M 260
	<b>WP 80-3</b> <b>adjustable foot</b> for frames with M10 thread		<b>M 271</b> <b>end plate</b> for corner extrusion M 260

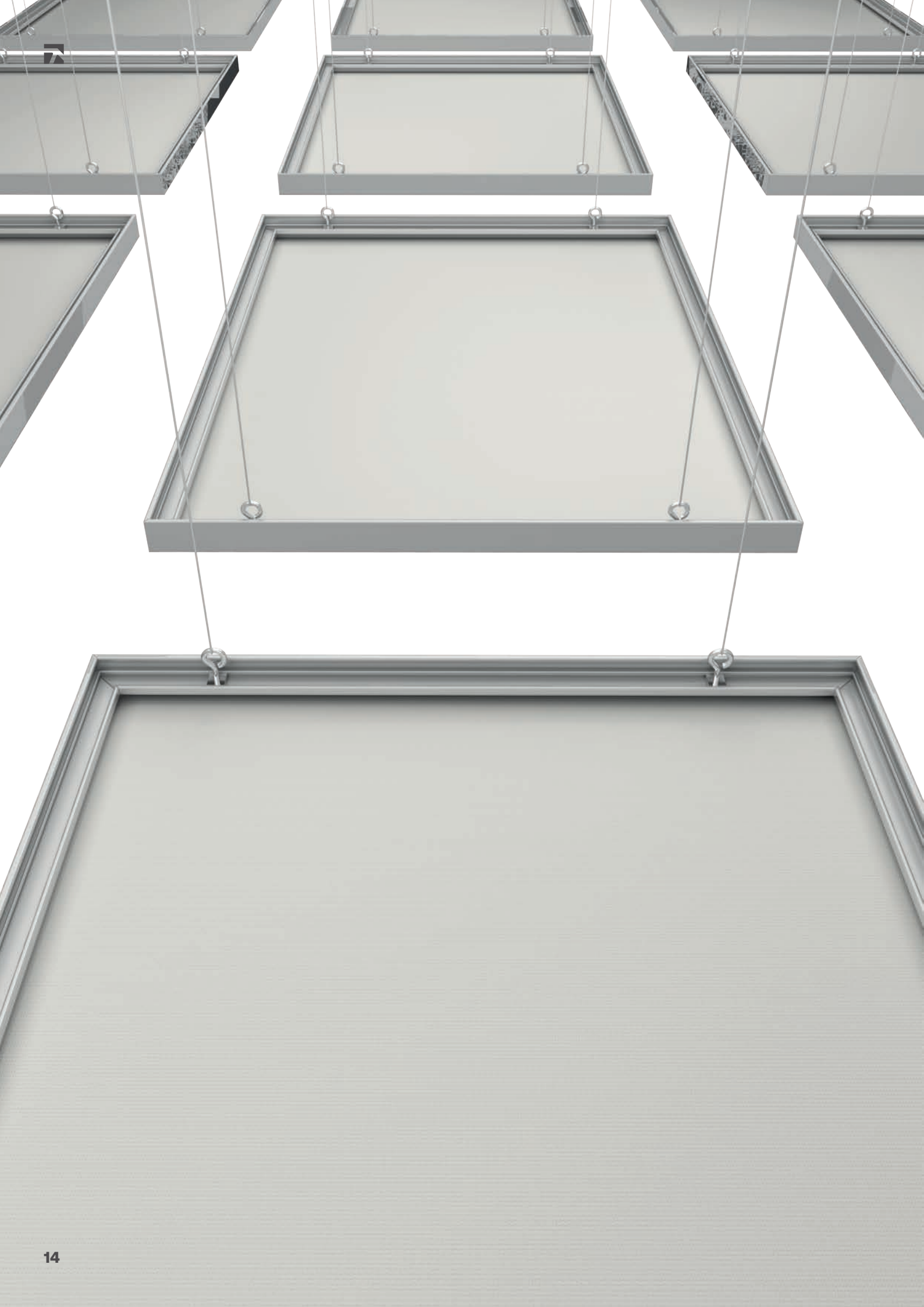

# Wall and ceiling solutions

single- / double-sided

## Wall and ceiling solutions

elegant aluminium surface / with or without system groove / silicone edge technology / single or double-sided

### Tension fabric extr. 40 mm width

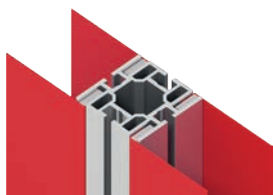

#### M 1305.01

**Aluminium** | for double sided fabric (in combination with silicone edge M 1313), with 4 grooves to fix fabric, tension lock Z 961/8 can be mounted in 2 positions

L 6000 × W 40 × H 40 mm  
1 8.23 kg

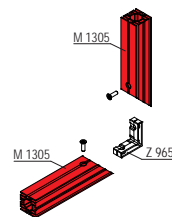
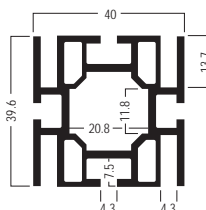

### Tension fabric extr. 40 mm width



#### M 1302.01

**Aluminium** | to fix fabric panels in connection with silicone edge M 1313, bracing available

L 6000 × W 40 × H 28 mm  
1 3.49 kg

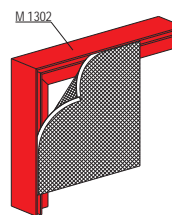
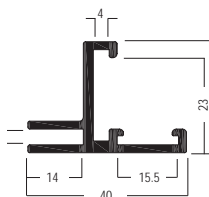

## Accessories



**M 1313** **silicone edge**  
14 × 3 mm, roll with 100 m



**Z 965B** **corner connector**  
for M 1305



**M 1312** **u-extrusion**  
for bracing of M 1302



**M 1314** **connector**  
for bracing of M 1302 in connection with M 1312



**M 1335** **corner connector**  
for connection of M 1302

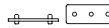

**M 1336** **internal connector**  
for bracing of M 1302



**M 1337** **eye bolt**  
for vertical ceiling suspension



**M 1338** **threaded plate**  
for bracing of M 1302 in connection with M 1312



**E 218** **eye bolt**  
for M 1305, max capacity 45 kg



## Light frames: octalumina

elegant aluminium surface / with or without system groove / different extrusion depths / shadow-free illumination / brilliant brightness / silicone edge technology

### Tension fabric extr. 120 mm, double-sided

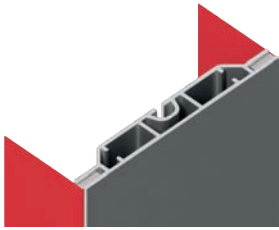

#### M 1901.01

**Aluminium** | for double-sided illumination, without system groove, graphics with silicone edge M 1313

L 6000 × W 120 × H 16 mm  
| 9.77 kg

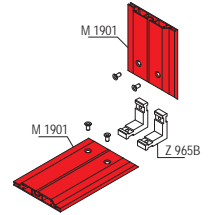
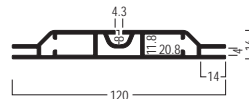

### Tension fabric extr. 120 mm, single-sided

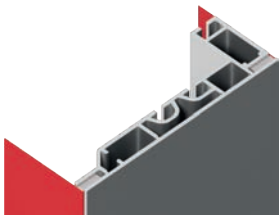

#### M 1915.01

**Aluminium** | for single-sided illumination, without system groove, graphics with silicone edge M 1313

L 6000 × W 120 × H 40 mm  
| 11.9 kg

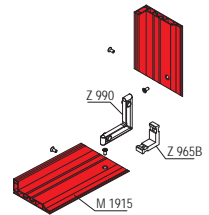
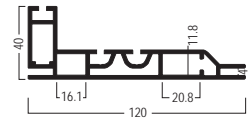

### Tension fabric extr. 80 mm, double-sided

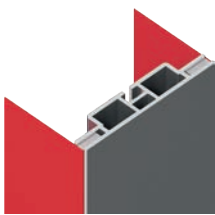

#### M 1925.01

**Aluminium** | for double-sided illumination, without system groove, graphics with silicone edge M 1313

L 6000 × W 80 × H 16 mm  
| 6.55 kg

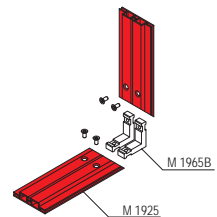
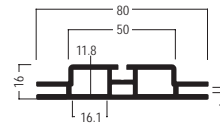

### Tension fabric extr. 135°, 60 mm,

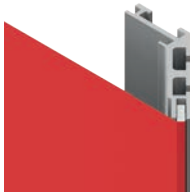

#### M 1301.01

**Aluminium** | 135° angle, for single-sided illumination, graphics with silicone edge M 1313

L 6000 × W 72 × H 47 mm  
| 6.55 kg

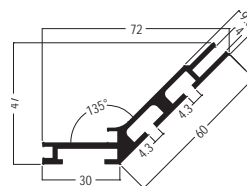

## ➤ Light frames

single-/ double-sided

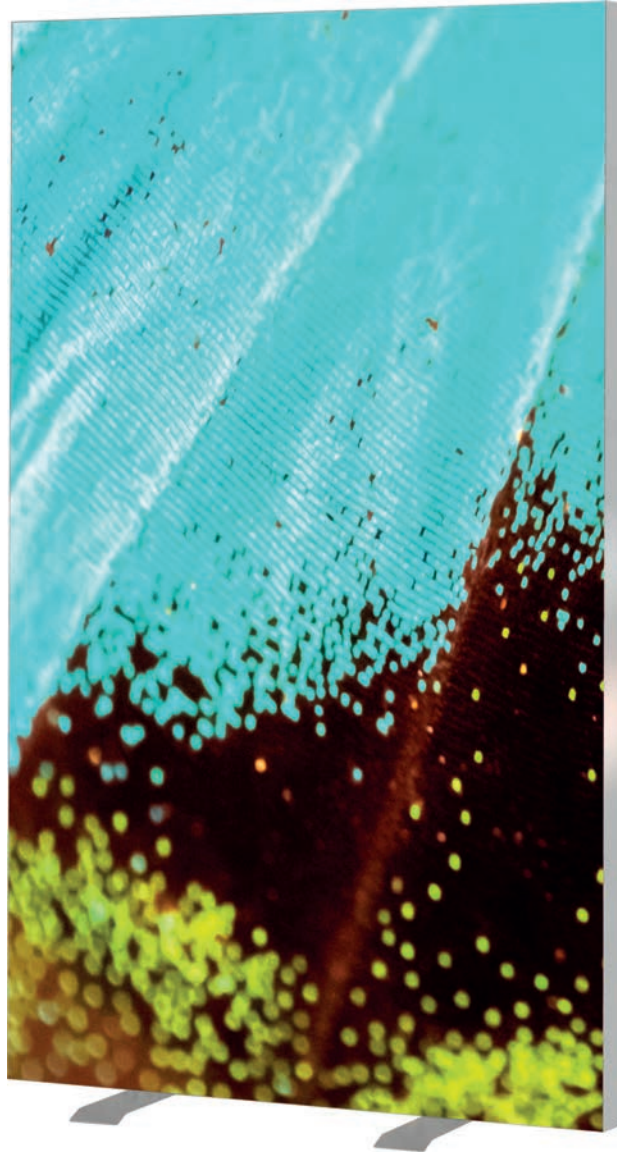

### Accessories



**M 1313** **silicone edge**  
14 × 3 mm, roll with 100 m



**Z 990** **corner connector**  
for M 1915



**Z 965B** **corner connector**  
for M 1901 and M 1915



**M 1208** **round extrusion**  
bracing for M 1901



**M 1965B** **corner connector**  
for M 1925 and M 1935



**Z 4400** **extrusion**  
bracing for M 1915 and M 1935



**Tension fabric extr.  
80 mm, single-sided**

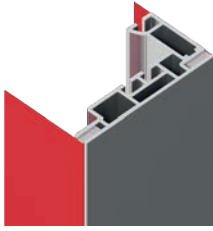

**M 1935.01**

**Aluminium** | for single-sided illumination, without system groove, graphics with silicone edge M 1313

L 6000 × B 80 × H 40 mm  
| 9.58 kg | 6000 mm

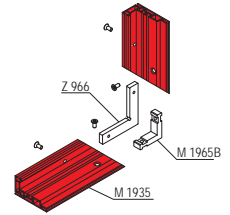
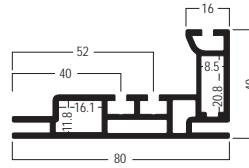

**Tension fabric extr.  
60 mm, single-sided**

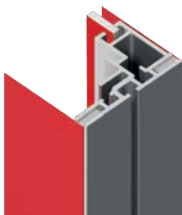

**M 1910.01**

**Aluminium** | for single-sided illumination, with system groove, graphics with silicone edge M 1313

L 6000 × W 60 × H 38 mm  
| 7.62 kg

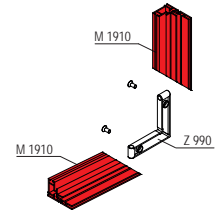
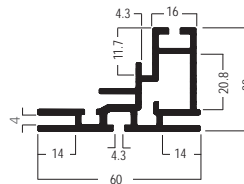

**Tension fabric extr.  
60 mm, single-sided**



**M 1920.01**

**Aluminium** | for wall mounting, for light frames with single sided tension fabric, graphics with silicone edge M 1313

L 6000 × W 60 × H 30 mm  
| 6.07 kg

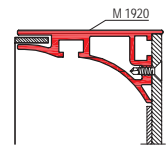
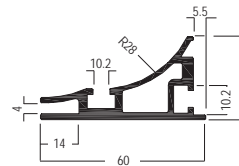

**Tension fabric extr.  
40 mm, single-sided**



**M 1930.01**

**Aluminium** | for light frames with single sided illumination, without system groove, graphics with silicone edge M 1313

L 6000 × W 40 × H 11 mm  
| 3.41 kg

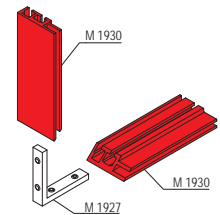
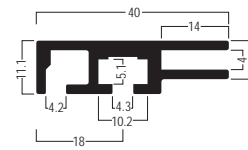

**Tension fabric extr.  
40 mm, single-sided**

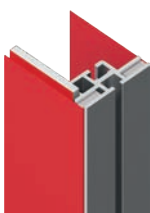

**M 1970.01**

**Aluminium** | for light frames with single-sided illumination, with system groove, graphics with silicone edge M 1313

L 6000 × W 40 × H 29 mm  
| 4.36 kg

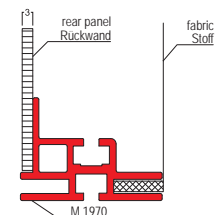
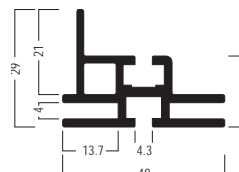

# Light frames

## single-sided

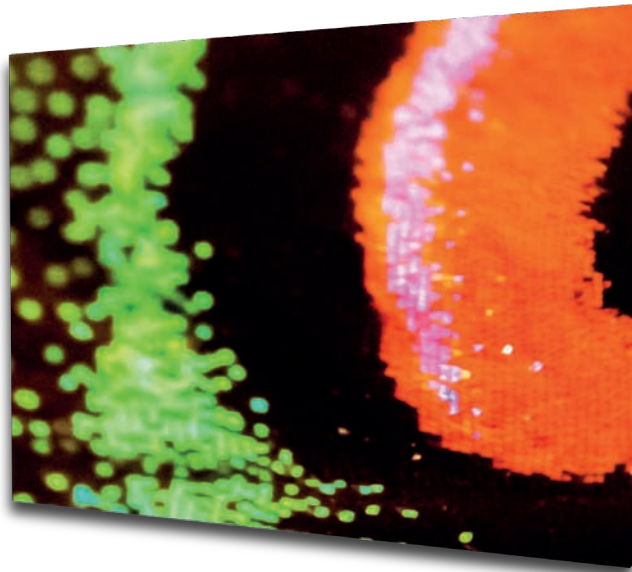

### Tension fabric extr. 120 mm, 3D effect

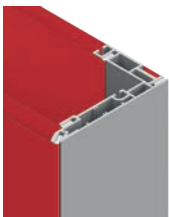

#### U 1060.01

**Aluminium** | for several fabric layers to create a three-dimensional effect, slanted groove without visible extrusion edges, for illuminated graphics with silicone edge M 1313

L 6000 × B 120 × H 66 mm  
| 16,2 kg

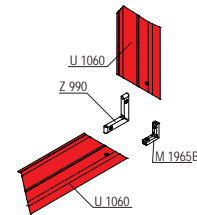
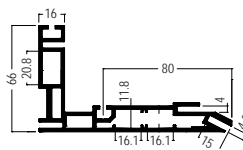

### Tension fabric extr. 120 mm, 3D effect

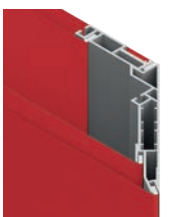

#### U 1063.01

**Aluminium** | for several fabric layers to create a three-dimensional effect, slanted groove without visible profile edges, for the construction of 90° corners in connection with frame extrusion U 1060, for illuminated graphics with silicone edge M 1313

L 6000 × B 120 × H 73 mm  
| 21,51 kg

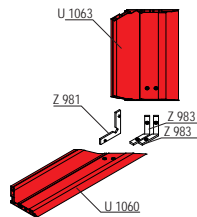
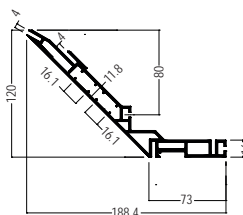

## Accessories



**Z 966** **corner connector**  
for M 1935



**M 1927** **corner connector**  
for M 1920, M 1930 and M 1970



**M 1926** **corner connector**  
for M 1920



**Z 990** **corner connector**  
for M 1910, M 1915 and U 1060



**M 1965B** **corner connector**  
for M 1925, M 1935 and U 1060



**Z 4400** **extrusion**  
bracing for M 1915 and M 1935



# Free-standing displays

double-sided

## Free-standing displays

elegant aluminium surface / with system groove / different extrusion depths / silicone edge technology

### Tension fabric extr. 40 mm width

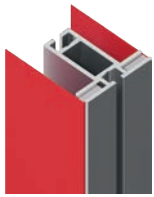

#### M 1307.01

**Aluminium** | for double-sided fabric (with silicone edge M 1313)

L 6000 × W 40 × H 40 mm  
I 5.39 kg

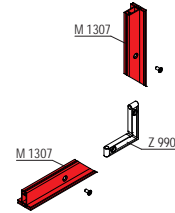
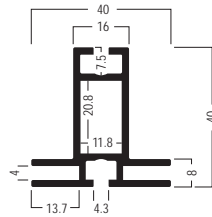

### Tension fabric extr. 80 mm width

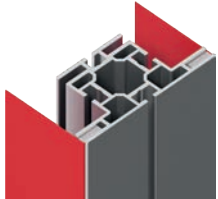

#### M 1304.01

**Aluminium** | for double-sided fabric (with silicone edge M 1313)

L 6000 × W 80 × H 40 mm  
I 10.15 kg

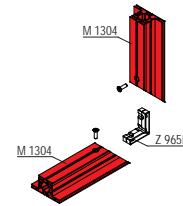
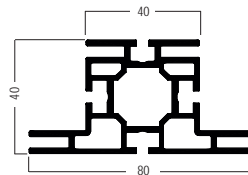

## Accessories



**Z 965B** corner connector  
for M 1304



**M 1347** base plate for M 1307  
L 320 × W 120 × H 8 mm  
screws not included



**W 916** corner connector  
for M 1307 (straight cut)



**M 1357** base plate  
L 320 × W 300 × H 8 mm  
screws not included



**Z 990** corner connector  
for M 1307 and M 1304



**M 1327** threaded plate  
for extrusions with lock chamber  
21 × 12 mm, incl. mounting parts



**M 1347/  
SK** mounting screws  
for M 1347 and M 1357



**M 1498** LED long arm spotlight  
12W/120V/4000K with 3000 mm  
cable, incl. retainer M 1481



## Free-standing displays: curved

elegant aluminium surface / with system groove / double-sided / radii from 1000 mm / silicone edge technology

### Tension fabric extr. 40 mm width

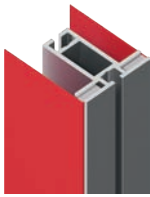

#### M 1307.01

**Aluminium** | for double-sided fabric (with silicone edge M 1313)

L 6000 × W 40 × H 40 mm  
I 5.39 kg

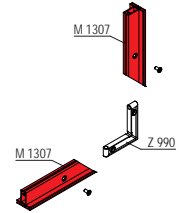
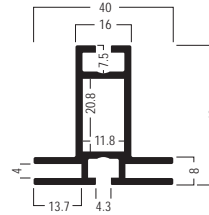

### Tension fabric extr. 40 mm width

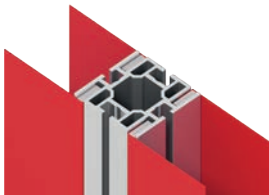

#### M 1305.01

**Aluminium** | for double sided fabric (in combination with silicone edge M 1313), with 4 grooves to fix fabric, tension lock Z 961/8 can be mounted in 2 positions

L 6000 × W 40 × H 40 mm  
I 8.23 kg

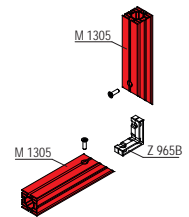
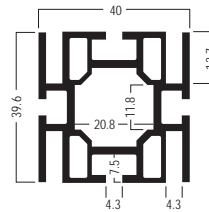

### Accessories



**M 1313**

**silicone edge**

14 × 3 mm, roll with 100 m



**Z 965B**

**corner connector**

for M 1305



**Z 990**

**corner connector**

for M 1307



**W 916**

**corner connector**

for M 1307 (straight cut)

## ➤ Free-standing displays

curved, double-sided

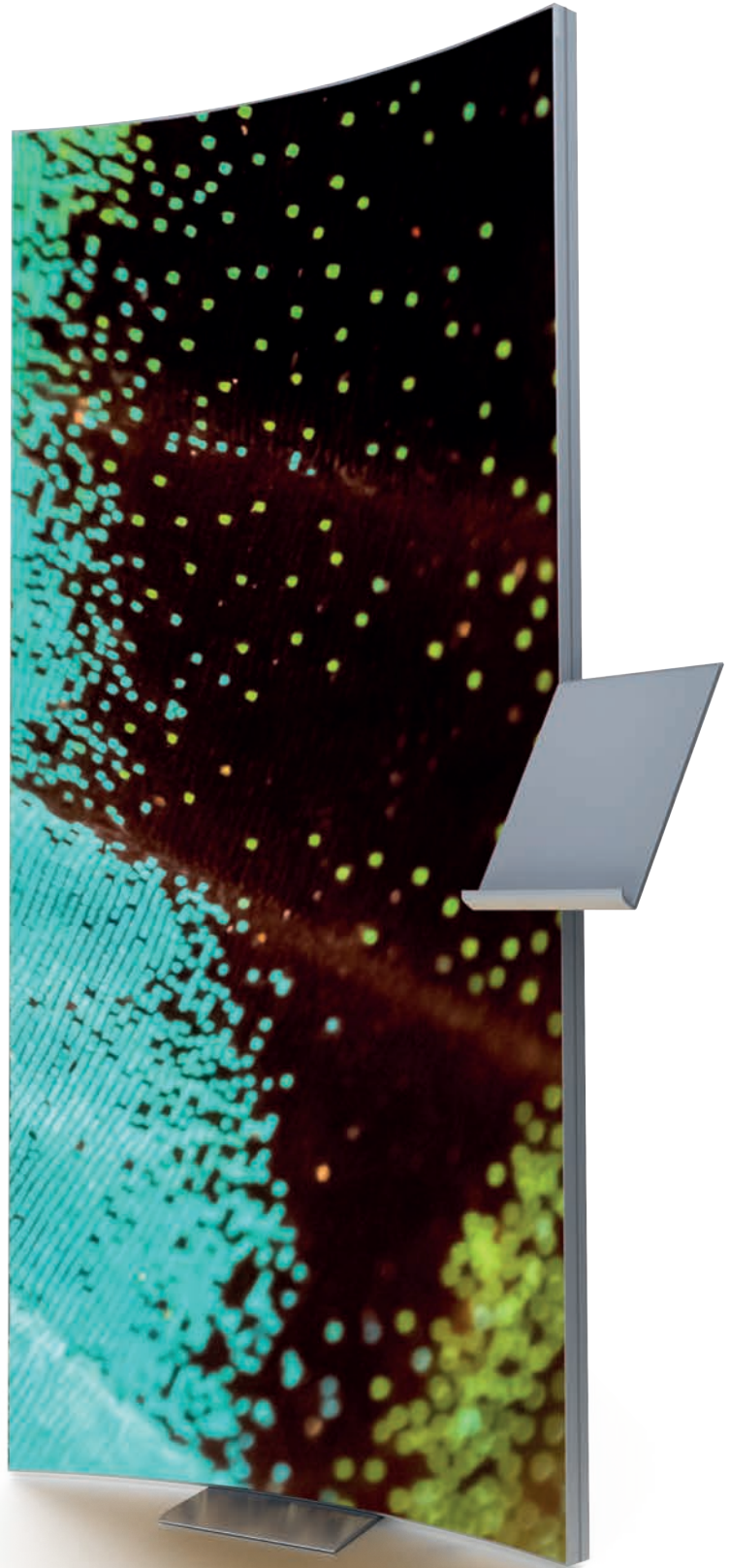

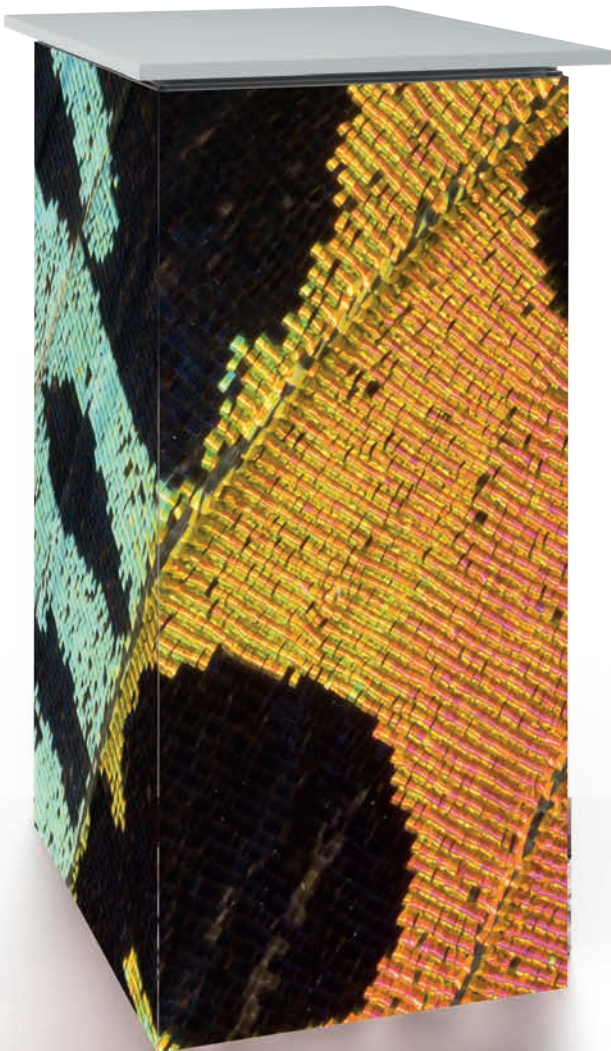
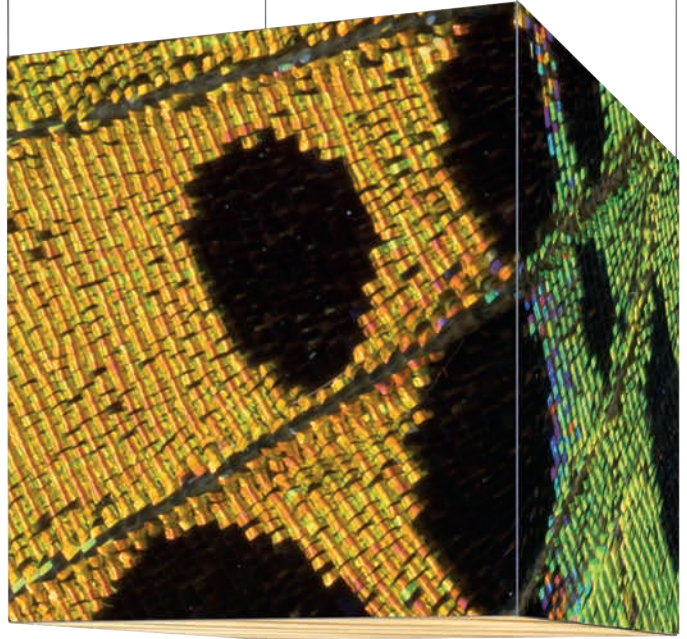

### Cubes

quick assembly / silicone edge technology / for illumination

#### Tension fabric extr. suspendable



#### M 1504.01

**Aluminium** | corner solution, for illumination of graphics with silicone edge M 1313, suspendable

L 6000 × W 47 × H 16 mm  
I 4.57 kg

Attention: maximum size of cube 2500 × 2500 × 2500 mm

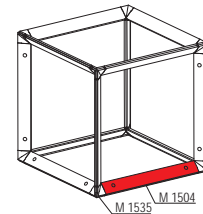
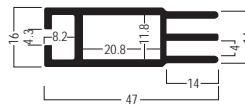

**i** for illumination

#### Corner connector



#### M 1535.31

**Plastic** | for connection with tension fabric extrusion M 1504

L 96 × W 96 × H 96 mm  
I 0.06 kg

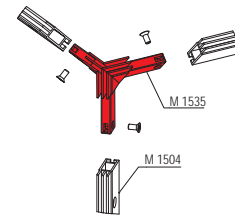
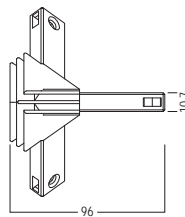

#### Tension fabric extr.



#### M 1332.01

**Aluminium** | for cube, with 2 × fabric retaining groove, 90°, for tension fabric, graphics with silicone edge M 1313, not suspendable

L 6000 × W 46 × H 46 mm  
I 5.94 kg

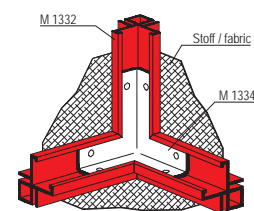
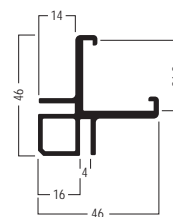

### Accessories



**M 1313 silicone edge**  
14 × 3 mm, roll with 100 m



**Z 460 extrusion**  
for illumination element



**M 1545 adaptor**  
for double-sided bracing for M 1504



**M 1329 adaptor**  
for M 1332



**M 1547 adaptor**  
for single-sided bracing for M 1504



**M 1334 corner connector**  
for M 1332



**M 1233 screw eye**  
M8, max 35 kg



**M 1326 connection extrusion**  
for M 1332



## Adaption extrusions

elegant aluminium surface / with system groove / different extrusion depths / silicone edge technology / double-sided

### Adaption extrusion 40 mm width



#### M 1310.01

**Aluminium** | for double sided fabric (with silicone edge M 1313), for mounting in system groove with fixing set M 1345, with 13 × hole 18 mm dia.

L 6000 × W 40 × H 10 mm  
12.69 kg

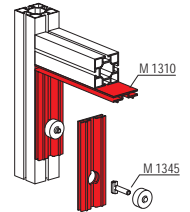
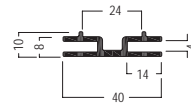

### Adaption extrusion 80 mm width

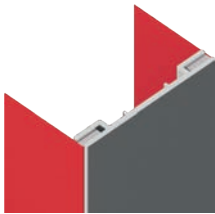

#### M 1325.01

**Aluminium** | for double sided fabric (with silicone edge M 1313), for mounting in system groove with fixing set M 1345, with 13 × hole 18 mm dia.

L 6000 × W 80 × H 9 mm  
15.33 kg

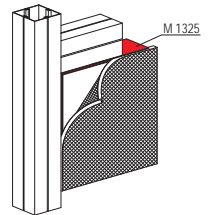
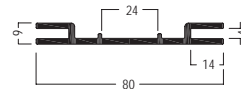

### Adaption extrusion 120 mm width



#### M 1330.01

**Aluminium** | for double sided fabric (with silicone edge M 1313), for mounting in system groove with fixing set M 1345, with 13 × hole 18 mm dia.

L 6000 × W 120 × H 9 mm  
18.28 kg

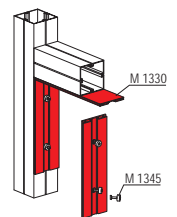
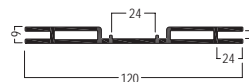

## Accessories



**M 1313**

**silicone edge**

14 × 3 mm, roll with 100 m



**M 1345**

**hammerhead screw**

to mount M 1310, M 1325,  
M 1330 to system groove

# Adaption extrusions

double-sided

**M 1310**  
with M 1000

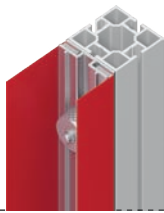

with M 1020

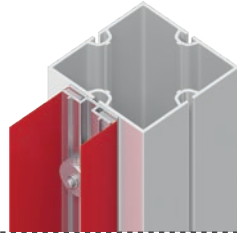

with M 225

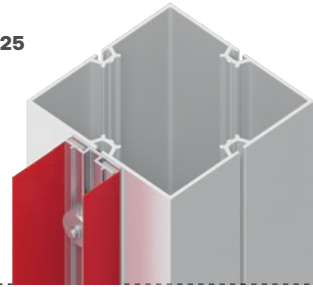

**M 1325**  
with M 1000

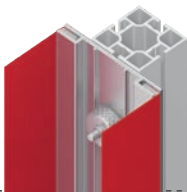

with M 1020

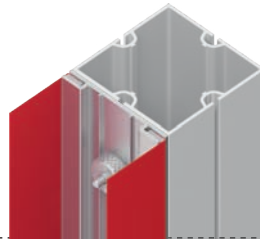

with M 225

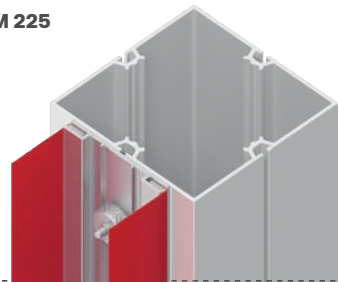

**M 1330**  
with M 1000

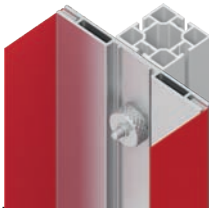

with M 1020

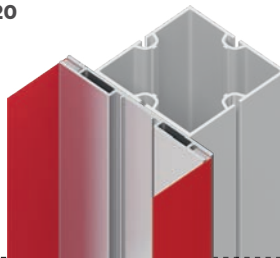

with M 225

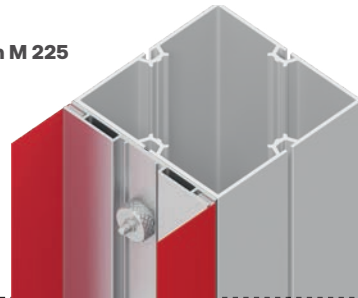

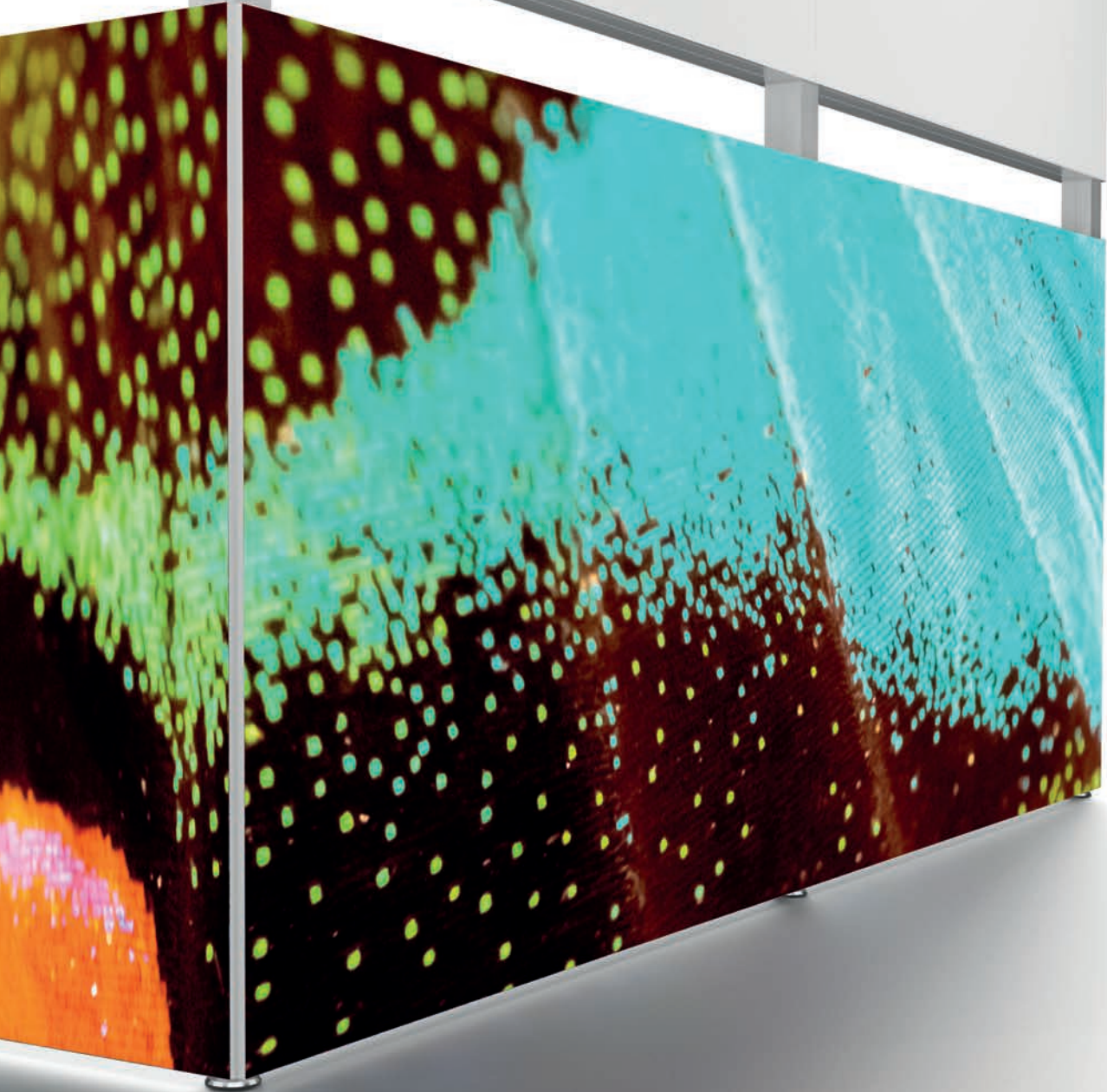

# Adaption extrusions

## single-sided

### Adaption extrusion 43 mm width



#### M 1321.01

**Aluminium** | 45°, for single sided fabric (with silicone edge M 1313), with 11 × hole 8.9 × 18 mm, for mounting in system groove: for 40 mm square extrusions use fixing set M 1348, for 80 mm and 120 mm square extrusions use fixing clip M 1339 and fixing set M 1348

L 6000 × W 43 × H 20 mm  
1.2.29 kg

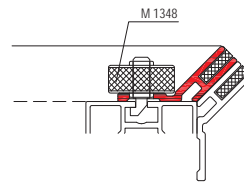
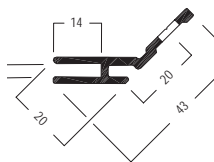

### Adaption extrusion 15 mm width



#### M 1319.35

**Plastic** | for single sided fabric (with silicone edge M 1313), for system groove 4.3 mm, with 2 fabric grooves

L 6000 × W 15 × H 20 mm  
1.1.46 kg

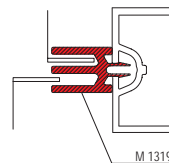
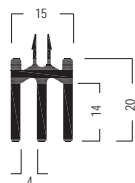

### Accessories



**M 1313 silicone edge**  
14 × 3 mm, roll with 100 m



**M 1339 retainer**  
used in connection with M 1348 for square extrusions with 80 mm and 120 mm



**M 1348 hammerhead screw**  
only for mounting M 1322, M 1322/E, M 1322/I, M 1321



### Adaption extrusion 28,5 mm width



#### M 1322.01

**Aluminium** | for single sided fabric (with silicone edge M 1313), with 11 x hole 8.9 x 18 mm, for mounting in system groove: for 40 mm square extrusions use fixing set M 1348, for 80 mm and 120 mm square extrusions use fixing clip M 1339

L 6000 x W 28.5 x H 20 mm  
1.203 kg

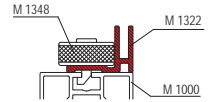
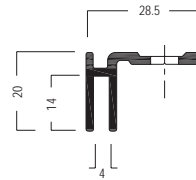

### Adaption extrusion outer corner

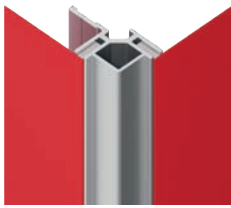

#### M 1322/E.01

**Aluminium** | 90° outer corner, for single sided fabric (with silicone edge M 1313), with 11 x hole 8.9 x 18 mm, for mounting in system groove: for 40 mm square extrusions use fixing set M 1348, for 80 mm and 120 mm square extrusions use fixing clip M 1339

L 6000 x W 48.5 x H 27.8 mm  
1.442 kg

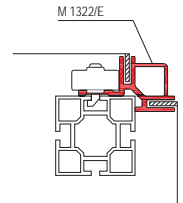
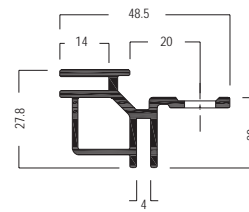

### Adaption extrusion inner corner



#### M 1322/I.01

**Aluminium** | 90° internal corner, for single sided fabric (with silicone edge M 1313), with 11 x hole 8.9 x 18 mm, for mounting in system groove: for 40 mm square extrusions use fixing set M 1348, for 80 mm and 120 mm square extrusions use fixing clip M 1339

L 6000 x W 56.3 x H 27.8 mm  
1.461 kg

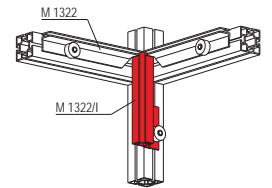
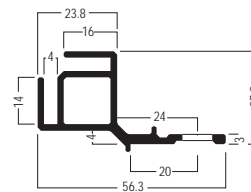

### Accessories



#### M 1313

#### silicone edge

14 x 3 mm, roll with 100 m



#### M 1339

#### retainer

used in connection with M 1348 for square extrusions with 80 mm and 120 mm



#### M 1348

#### hammerhead screw

only for mounting M 1322, M 1322/E, M 1322/I, M 1321

## ↗ Adaption extrusions

single-sided

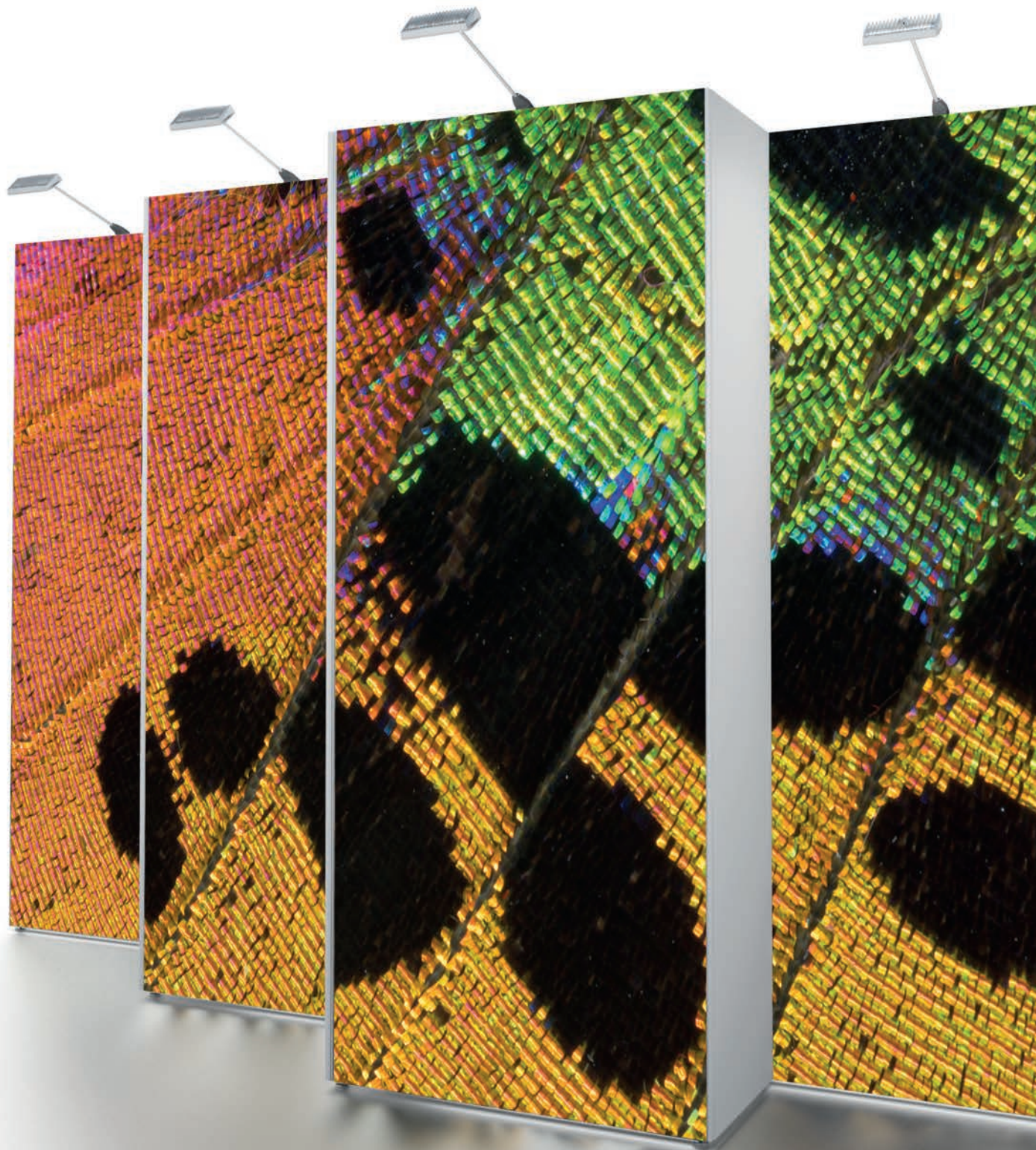



## ➤ In Action

tension fabric extrusions





**exhibition systems**  
**project solutions**  
**cleanroom solutions**





# octanorm

**OCTANORM®-Vertriebs-GmbH**

für Bauelemente

Raiffeisenstraße 39

70794 Filderstadt, Germany

**T** +49 711 77003-0

**E** info@octanorm.de

## Adria

[octanormadria.com](http://octanormadria.com)

## Australia

[octanorm.com.au](http://octanorm.com.au)

## Belgium

[octanorm.be](http://octanorm.be)

## China

[octanorm.cn](http://octanorm.cn)

## Emirates

[octanormemirates.net](http://octanormemirates.net)

## España

[octanorm.es](http://octanorm.es)

## France

[octanorm.fr](http://octanorm.fr)

## Hellas

[octanorm.gr](http://octanorm.gr)

## Italia

[octanorm.it](http://octanorm.it)

## Japan

[octanorm.co.jp](http://octanorm.co.jp)

## México

[octanorm.com.mx](http://octanorm.com.mx)

## Nigeria

[it-al.design](http://it-al.design)

## Nordic

[octanorm.se](http://octanorm.se)

## North America

[octanormna.com](http://octanormna.com)

## Polska

[octanorm.pl](http://octanorm.pl)

## South Africa

[octanorm.co.za](http://octanorm.co.za)

## UK

[octanorm.co.uk](http://octanorm.co.uk)

[octanorm.com](http://octanorm.com)